

Classifieds

To place your classified ad, mail (155 W. Fifth), fax (785-462-7749), phone (785-462-3963), or stop by our office at 155 W. Fifth

Notices

Estate Auction Saturday, October 22, 9:30 a.m. Hoxie 4-H Building for Flo Meier: Partial list 16 shot guns, 14 rifles, 3 pistols, lots of gun lated items, guns sell at 1 p.m. Hesston belt buckles "74" plus John Deere buckles, 80 collector buckles, neon beer signs, beer related items, antiques, blacksmith anvil plus more, millermatic 185 wire welder, shop, livestock items, household, furniture items, two cars, trailers, much more! Brown's Auction, Mickey Brown - Evenings 785-675-3767.

Dan is back! Dan Geschwentner. Small remodeling and repair jobs. Call 785-443-3673.

Help Wanted

Flexible weekend product promotion & cooking demonstration opening in Colby! We pay weekly, 6 hour events starting at \$72/event! Go to NCiM.com and click on "demonstrator opportunities" use ad code "101" or email khunter@ncim.com!

Credit Bureau Services Inc. is needing part time help for researching information in Thomas County. Set your own hours between 8:00 - 5:00. Call 1-800-832-4906 Ext. 243.

Timmerman Feeding is looking to fill a position in the maintenance/feed department. Individual duties may include welding, run heavy equipment, driving a feed truck, along with various other duties. Salary depends on experience and qualifications. If you are looking for a place to start a career, contact Jason Timmerman at 785-462-3947.

RN Consultant needed for a growing Assisted Living Facility in Colby. Stop by Fairview Estates Retirement Community for an application, 1630 Sewell Ave., Colby, KS 67701. EOE.

Now hiring CNA and CMA shifts. All shifts available and flexible schedule. Previous experience preferred. Apply in person at Fairview Estates, 1630 Sewell Ave., Colby, KS 67701. EOE.

Temporary Legal Secretary Position: The Thomas County Attorney is accepting applications for a temporary legal secretary in the Thomas County Attorneys Office. Position responsibilities include: Preparing correspondence, charging documents, and court filings; Answering telephones and greeting visitors to the office; Maintaining files; and performing related work as assigned. Applicant must be able to work well with others, to multi-task, to effectively communicate with the public, to proficiently use Microsoft Word and Microsoft Excel, to work under deadlines and to prioritize work. Applicant must have high school diploma or equivalent, an associate's degree or higher, and/or experience as a legal secretary or similar experience is preferred. The successful applicant must sign a confidentiality agreement and pass a criminal background check. This is a temporary full-time position beginning as early as November 1, 2011 and ending on or about March 1, 2012. Pay rate will be determined by County Attorney based upon knowledge and expertise of applicant. Application packets may be obtained from the Thomas County Attorney, 300 N. Court, Colby Kansas 67701. Application deadline is October 26, 2011.

Law Enforcement - The Gove County Sheriff's Office is accepting applications for the position of Undersheriff. Basic requirements are: 3 to 5 years prior law enforcement experience. Must be able to pass background investigation. Meet all the requirements for certification as a Kansas Law Enforcement Officer. Wages are very competitive and complete family health insurance with prescriptions and dental. Deadline for application is Friday, November 11, 2011 at 5:00 p.m. To request an application, contact the Gove County Sheriff's Department, PO Box 146, Gove, KS 67736, Phone 785-938-2250. EOE.

BREWSTER HOMES

526 Main
Reduced Price on this lovely 4 BR, 2 bath home with shops.

309 Rock Island
Very attractive & Affordable 3 BR, 2 car grg

228 Nebraska
A "wow" home with lots of new.

MOLLY J. OLIVER 460-SOLD (7653) 462-6133 (Res.)

STOCK REALTY & AUCTION CO. 390 N. Franklin Colby, KS

Help Wanted

Hiring Truck Drivers - Good driving record, CDL and drug testing required. Excellent pay with benefits, including health insurance, retirement and vacation. To apply call Sporer Land Development, Inc. 785-672-4319, Oakley, KS. Equal Opportunity Employer. women & minorities encouraged to apply.

St Francis Community Services is accepting applications for the following positions: THERAPIST LMSW, LMFT, LPC Provide in-home therapy to children & families in Family Preservation. Requires 2 yrs exp working with children & families, dependable transportation, a clear MVR/KBI, at least 21 years of age & Master's Social worker, counseling, marriage & family or related field, BSRB license. SUPERVISOR LMSW/LPC/LMFT Provides supervision & support to Therapists & Family Support Workers in Southwestern & Northwestern Kansas Family Preservation program. Requires 3 yrs exp working w/ children & family services, ability to travel, work flexible schedule, effective communication skills & Master's in Social Work, Counseling, Marriage & Family or related field, BSRB license. SFCS offers an excellent benefit package & competitive wages. Resume to kerri.kemp@st-francis.org, fax to 620-276-4485 attn Kerri, or website: www.st-francis.org. EOE

Wanted - Automotive Technician NW KS Ford Dealer in a progressive community currently seeking a Full Time Light Mechanic, duties to include Oil Changes, Brake Jobs, and Line Tech. Established Business of over 40 years. Competitive Pay, Attractive Benefit Package, college town, great place to live & work. Contact Chris, Tubbs & Sons Ford Sales Inc. Colby, KS 67701, (800) 369-3673 mtubbs@st-tel.net.

Needing someone to deliver newspaper bundle to Oakley 3 to 4 times a week. This would be great for someone who already commutes to Colby from Oakley. Please call the Colby Free Press if interested. 785-462-3963.

Help Wanted

Assistant Recreation Director wanted for Colby, Kansas. Under the supervision of the Recreation Director, responsibilities include coordinating and assisting in the development, planning, organization, and administration of community recreation programs for seniors, adults, and youth; supervising recreation programs; performing maintenance work at the ball field complex; performing administrative duties that may include payroll and monthly reports and other work as needed and assigned. Answers and fields phone calls. Excellent benefit package with a starting salary of \$10.50 hourly, DOQ. Persons wishing to apply may pick up an application at the Recreation Office, 285 E. 5th Street or at City Hall, 585 N. Franklin, or can print off an application form at www.cityofcolby.com. A full job description is available at the Rec. Department or City Hall. Applications must be returned by 12:00 p.m. on Friday, November 18th, 2011. EOE.

Substitute Teacher Needed: Thomas County Learning Center, current Kansas teaching or substitute license preferred. Please submit resume. For more information call 785-465-7900.

CDL Driver Wanted local haul, home nights, permanent position. 785-899-7513 or 785-821-2217.

Professional Sales Person - Attn: Salesmen - Independent, Motivated, Ambitious, if this describes you, we want to talk to you. Call Don Weese Jr. at 501-834-3020.

Carrier wanted for morning delivery of the Salina Journal in Colby. For information call 1-800-827-6363 ext. 300.

Wanted - Experienced Truck Driver. Good pay, benefits, decent home time. Jack 785-675-8375 or Jim 785-675-2196.

Now hiring for all positions. Apply between 6 a.m. - 1 p.m., Monday - Saturday. See Don or Tammy at Village Inn Restaurant, 2215 S. Range.

Wanted: CDL Drivers for company operated firm. 2 years minimum driving and clean MVR. 785-462-0087.

Help Wanted

PSI Transport is always looking for good company livestock and grain haulers as well as shop mechanics. Competitive pay, life/health/dental benefits and bonus program available. EOE 785-675-3477.

Misc for Rent

Murray Equipment Leasing, LLC in Colby is now offering construction equipment for rent. Some items include a 38 ft. skytrack forklift, and an 85 ft. boom truck. If interested please call 785-443-1339 or 785-462-6908.

Apartments for Rent

2 bedroom apartment washer/dryer, AC, dishwasher, refrigerator & stove. New paint throughout, carpet in living room. No pets. 785-462-0916 or 785-462-0274 Move in special.

South Park and Meadowlark Manor. Rent based on income. Equal Housing Opportunity. www.colbyhousingauthority.com 785-460-6763.

Mobile Home for Sale

Nicely kept, 2 bedroom mobile home. Central heat & air, must see to appreciate. 785-462-3248.

Misc. for Sale

Heavy duty commercial batteries and top quality filters for most everything on your farm at factory direct prices at Colby Ag Center 785-462-6132.

Beautiful pellet stove and stack - 12' 785-687-4780.

Wanted

Wanted: Milo and Corn stalks to bale. John 785-462-7400 or 785-443-3653.

Opening for Program Director at Camp Lakeside

Camp Lakeside, a United Methodist associated Christian Camp located adjacent to Scott State Lake, is now accepting applications for the position of Program Director. Duties include activity and curriculum development for summer UMC church camps, nature study development for all age levels year round, registration and reservation management, website and other marketing development and management. Bi-lingual applicants preferred. This is a full time, year round position. Salary is competitive, health insurance stipend included in salary package. Applications close Nov 11th. Contact Andie Strong at Camp Lakeside 620.872.2021 or email camplakeside@wbsnet.org

Real Estate



(785) 462-8255
www.HomeLandRE.com

An Affiliate of
United Country

<p>NEW LISTING</p>  <p>1285 Lue Drive 3 BR/3 Bath Call Pat today!</p>	<p>FAMILY READY</p>  <p>460 Arrowhead 4 BR/2 Bath Give Pat a call today!</p>
<p>START HERE</p>  <p>445 W. 6th 4 BR/2 Bath Give Pat a call today!</p>	<p>READY FOR YOU</p>  <p>280 E. 4th Big opportunity at small cost Call our office today!</p>
<p>MOVE IN READY</p>  <p>865 S. Garfield 2 BR/1 Bath-Garage Call Rock today!</p>	

<p>Pioneer II Sub. Lots \$12,000 El Chaparral Add. Lots \$18,000 411 Illinois, Brewster CONTRACT 410 Converse, Oakley CONTRACT 865 S. Garfield \$67,500 1135 W. 6th \$72,000 560 N. Lincoln CONTRACT</p>	<p>915 Mentlick CONTRACT 540 W. 4th \$82,000 210 S. Franklin CONTRACT 112 Manchester, Brewster \$89,900 255 N Garfield \$104,500 945 Mentlick \$109,500 460 W. 4th CONTRACT</p>	<p>565 N. Mission Ridge \$110,000 905 S. Range \$112,500 210 Iowa, Brewster \$115,000 265 W. Summit CONTRACT 1800 Harvey Court \$129,900 1160 Wheatridge \$209,500</p>
--	---	--

WE WANT YOUR LAND LISTINGS - "WE SELL"

2-6 acre lots located along I-70 frontage. Give Marilyn a call today!
 115 N. Kansas, Selden, KS Turn-key business. Southwind Steakhouse & Saloon \$135,000 Call Rock today!
 1690 W. 4th, Colby, KS Well maintained dental office with over 2,100 sq. ft. \$160,000 Give Marilyn a call today!
 217 Center, Oakley, KS Our Place-restaurant with all equipment included. \$180,000 Give Jerry a call today!
 1675 W. 4th, Colby, KS Use the warehouse and let the office lease help with payments. \$195,000 Call Pat for details!
 111 W. 3rd, Oakley, KS 10,000+ square ft building with an excellent tenant & great cash flow. \$210,000 Call Rock!
 Commercial lot 6.7 acres adjacent to Wal-Mart with I-70 frontage, Colby, KS \$569,500 Call Rock!
 Commercial lot 10 acres North of Interstate between Franklin & Country Club Drive East of Bourquins. (Can be split) Call Tom!

See how our nationwide property advertising, websites and exclusive real estate catalogs can find buyers. From homes, land, recreational, investment, retirement, ranches, farms or business.

<p>Pat Sloan (785) 443-3261 Marilyn Meyer (785) 462-2703 Toni Lindberg (785) 443-4032</p>	<p>1055 S. Range Colby, KS www.HomeLandRE.com</p>	<p>Rock L. Bedore (785) 443-1653 Tom Harrison (785) 443-0136 Jerry Wycoff (785) 672-0429</p>
---	--	--

Vehicles for Sale

2009 Subaru Outback 2.5i Special. 4 cylinder engine, all wheel drive. 38,500 miles. Clean. 785-846-8100.

Seed and Feed

KCIA certified seed wheat. AGRIPRO TAM III POSTROCK newly released SY-GLOD, also FULLER. Paul Nauer 785-678-2339 or 785-678-8083.

Services

Do Your Feet Hurt? We can help with 1-step Technology. We also provide medic approved diabetic shoes up to size 15 with doctor's prescription by appointment only. Currier Drug, Inc., Atwood. 1-800-696-3214.

Dave Rudy's Tree Service. Commercial, Rural Residential and Dairies. Cedars, Pines, Deciduous, Fraike, Pruning, shaping, removals, and gardens. Nurseryman, Shelterbelts, yard cleanup and much more. 785-443-0994

Tired of dodging roof leaks every time it rains? Let Murray Roofing end the bucket brigade! Experienced in installing all types of commercial roofing systems, TPO, EPDM, Elastomeric coating, Torch-down, and Modified, Perfect for flat or low-sloped roof and Various warranty options to fit every need. Call Murray Roofing an authorized Duro-Last Contractor today for your free estimate at 785-462-6908, 785-443-5347 or 785-443-1339.

JUST LISTED

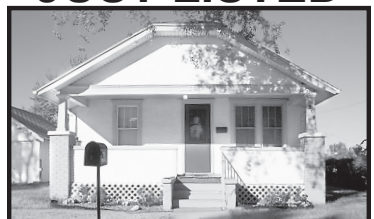

380 N. Riddle
Great look --- Great Value call Molly today to view this 4 BR, 2 bath home with a NEW look.

MOLLY J. OLIVER
460-SOLD (7653)
462-6133 (Res.)
STOCK REALTY & AUCTION CO.
390 N. Franklin Colby, KS



WANTED:
Truck Service Advisors
Lube Technicians
Technicians

We are looking for a few good individuals that have some good communication skills and like to get a little dirty at times. We offer Excellent Benefits, Paid Holidays, Vacation, and 401k. Please stop in today to fill out an application or if you would like you can apply online at www.mypetrojob.com or you can call 1-888-6-PETRO-JOB (1-888-673-8765) hiring code 101. If you have any questions please give us a call here at the shop. 785-460-4260.

Pets/Supplies

4 kittens in need of adoption to good homes at Doggone Critters Pet Grooming. Come by or call 785-462-6388.

Garage Sales

Multi-family Garage Sale 680 S. Lincoln, Friday 4 - 6 p.m., Saturday 8 - 11 a.m. 12 gauge overunder shotgun, toddler bed, baby swing, boys and girls clothes, birth to size 14, mens and women's clothing, games, wooden basket, household items, little girl indoor playhouse, much more.

Misc. Garage Sale: Antiques, jewelry and baked goods. Thursday and Friday, Colby Community Building at 10 a.m.

Made of Iron Garage Sale 735 E. H. Colby. Saturday, October 22, 9 a.m. - 12 p.m. Up to 60% off.

15 Cottonwood Dr., Colby. Thursday & Friday 3 - 7 p.m., Saturday 8 - 10:30 a.m. Antiques, tools, lawn mower, golf items, misc.

JUST LISTED

NW/4 of 16-14-35
Logan Co. KS
\$500/Acre

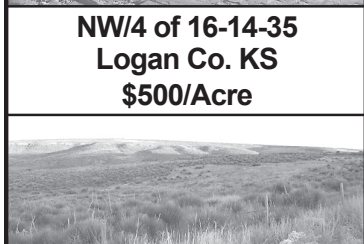

E/2 of 16-14-35
Logan Co. KS
\$1800/Acre

Call Kevin Barnett!
460-SOLD (7653)
443-1722 (Mobile)
STOCK REALTY & AUCTION CO.
390 N. Franklin Colby, KS



Colby Community College is accepting applications for a **Title III Technician**. Responsible for technical support activity for the development of hybrid and on-line course delivery systems. Strong networking and Microsoft operating system background preferred. To apply, send letter, resume and all post-secondary transcripts by Nov. 1, 2011, to Colby Community College, Attn: Bev Anderson, 1255 S. Range Ave., Colby, KS 67701. Materials may be emailed to bev.anderson@colbycc.edu. CCC is an Equal Opportunity Employer committed to diversifying its work force.

FARM MACHINERY & EQUIPMENT

SATURDAY
NOV. 5, 2011
@ 10:30 AM, CDT

AUCTION

SELLERS: VINCENT & KATHY ZERR

AUCTION LOCATION: At the farmsite 5 miles North and 3 miles East of Grinnell OR 2 miles West, 5 miles North and 3 miles West from Grainfield OR 5 1/2 miles East of Angelus. **SIGNS WILL BE POSTED!**



TRACTOR:
●IH 1566 Wheatland
●IH 1466 w/ loader
TRUCK:
●78 Ford F-700
PICKUP & CAR:
●92 Ford F150 XL, 4x4
●90 Mercury Sable
TRAILERS: ●75 Blair 5'x16' stock tri2 wheel flatbed trailer
FARM EQUIPMENT:
●FK & SF 5x5 blade plows w/pickers
●28' & 30' field cultivator
●2) JD LZ drills, 10'x10"
●27' Crustbuster
●SF 16' offset disc
●6' Rotary mower
●2) Graham Hoeme chisels
●SpeedKing auger w/BS motor
LIVESTOCK EQUIPMENT:
●12' Powder River panels
●20', 14', 12', & 10' Corral panels
●16' & 20' wire mesh panels

LIVESTOCK EQUIP CONT'D:
●16', 10' & 8' feeder panels
●Fence chargers
●300 steel & wooden posts
●Steel walk-thru gate
●Gates
●Utility poles
●Post hole driver
●Horse tanks
●1,000 gal water tank on skid
●250 gal water tank
TO BE MOVED: ●Calf sheds
●8'x12' & 9'x9' portable sheds
●18'x40' round top
●Chicken cages w/doors
ANTIQUES:
●Scythe
●Kids wagon
●Treadle forge
●Monkey wrenches
●Misc tools
●3) Maytag washers
●Horse drawn farm machinery
●Seed signs
●Skulls
●Cream can
●4, 5, 20 & 25 gallon crocks
SHOP EQUIPMENT & MISC:
●New 2-rail plastic fencing 18) 16' rails w/posts
●2,000 gal diesel tank, jacks, saws, lumber, tubing, iron, shop tools, & household items **AND MANY MORE!**

www.farmandranchrealty.com
FARM & RANCH REALTY, INC.
1420 W. 4th • Colby, KS 67701
Toll Free - 1-800-247-7863
DONALD L. HAZLETT
Broker/Auctioneer
"When you list with Farm & Ranch, it's as good as SOLD!"



YOUR LEADER FOR HOME LOANS IN NW KANSAS

Farmers & Merchants
Bank of Colby

240 W. 4th St., Colby, Kansas
(785) 460-3321



Jacque Golemboski
Mortgage Loan Officer
NMMLS #643818
F&M Bank NMMLS #528146

Member FDIC
Equal Housing Lender



Mortgage interest rates are as low as:

<p>15 year loans - 3.500%* (3.586% APR) 20 year loans - 4.000%* (4.068% APR) 30 year loans - 4.000%* (4.049% APR)</p>	<p>Rates shown assume: ● Excellent Credit ● ● Conventional Loan, 80% Loan to Value ● ● Single Family Residence ●</p>
---	---

*Rates may change without notice subject to market conditions. APR based on a loan of \$100,000, actual fees may vary. Mortgage products are subject to change and availability. The actual mortgage product you qualify for will depend upon the verification of the value of your home, your credit score and other considerations.



YOUR LEADER FOR HOME LOANS IN NW KANSAS

Farmers & Merchants
Bank of Colby

240 W. 4th St., Colby, Kansas
(785) 460-3321



Jacque Golemboski
Mortgage Loan Officer
NMMLS #643818
F&M Bank NMMLS #528146

Member FDIC
Equal Housing Lender



Mortgage interest rates are as low as:

<p>15 year loans - 3.500%* (3.586% APR) 20 year loans - 4.000%* (4.068% APR) 30 year loans - 4.000%* (4.049% APR)</p>	<p>Rates shown assume: ● Excellent Credit ● ● Conventional Loan, 80% Loan to Value ● ● Single Family Residence ●</p>
---	---

*Rates may change without notice subject to market conditions. APR based on a loan of \$100,000, actual fees may vary. Mortgage products are subject to change and availability. The actual mortgage product you qualify for will depend upon the verification of the value of your home, your credit score and other considerations.