



Weather Corner



National Weather Service
Tonight: A 40 percent chance of showers and thunderstorms, mainly before 1 a.m. Mostly cloudy, with a low around 43. Southeast wind 10 to 15 mph becoming northeast.

Friday: Mostly sunny, with a high near 69. Windy, with a northwest wind 15 to 20 mph increasing to between 25 and 30 mph. Winds could gust as high as 40 mph.

Friday Night: Mostly cloudy, with a low around 33. Breezy, with a north wind between 15 and 20 mph, with gusts as high as 30 mph.

Saturday: Partly sunny, with a high near 56. North wind between 10 and 15 mph.

Saturday Night: A 20 percent chance of showers. Mostly cloudy, with a low around 37.

Sunday: A 20 percent chance of showers. Mostly cloudy, with a high near 60.

Sunday Night: A 30 percent chance of rain. Mostly cloudy, with a low around 40.

Monday: A 30 percent chance of showers and thunderstorms. Mostly cloudy and breezy, with a high near 60.

Monday Night: A chance of rain. Mostly cloudy and breezy, with a low around 39. Chance of precipitation is 30 percent.

Tuesday: A 20 percent chance of rain. Mostly cloudy and breezy, with a high near 59.

Wednesday: High, 58; Low 38
Precip: Wed. .None
Month: 0.50 inches
Year: 1.49 inches
Normal: 3.98 inches
(K-State Experiment Station)
Sunrise and Sunset
Friday 6:57 a.m. 8:29 p.m.
(U.S. Naval Observatory)

Proposed walking trail moving closer to reality

From "TRAIL," Page 1

pool and high school, Evans said, reaching into as many neighborhoods as possible.

"It would be a safe way for kids to get out there (to the pool)," she said. Surfacing might be something other than concrete, she said, but would accommodate walkers and bikers. Some areas might focus on memorial gifts from area families.

Evans said people can get behind the effort three ways:

- Tell everyone about the plan and drum up support.
- Donate cash to help pay the cost. While the team has as much as \$21,000 promised, she said, Woofter estimated the cost of concrete alone at \$75,000. The Thomas County Community Foundation has set up a "pass-through" fund to take tax-deductible donations for the trails, said Executive Director Melinda Olson.

• Volunteer to help build, plant, clean up and maintain the trails. The city and Tree Board will pitch in, but the group needs lots of volunteer labor to make things work on a tight budget.

Evans said the Wellness Committee has donated \$20,000 for the trails, the city will provide land for Phase I loops and a \$24,275 grant from the Kansas Health Foundation will pay for the "exercite," a people counter, a contract with a trail designer and meeting to promote the plan. The activities center has a \$1,000 grant from the Walmart Foundation for the effort.

The city, she added, has \$75,000 for playground equipment, but that will cost about \$100,000. At least \$25,000 more will be needed to complete that area.

"As you can see, we're a little short," she said, "but if we want to do it, we can get it done. In Colby, we can do what we set our minds to. We just have to get started, and it'll go."

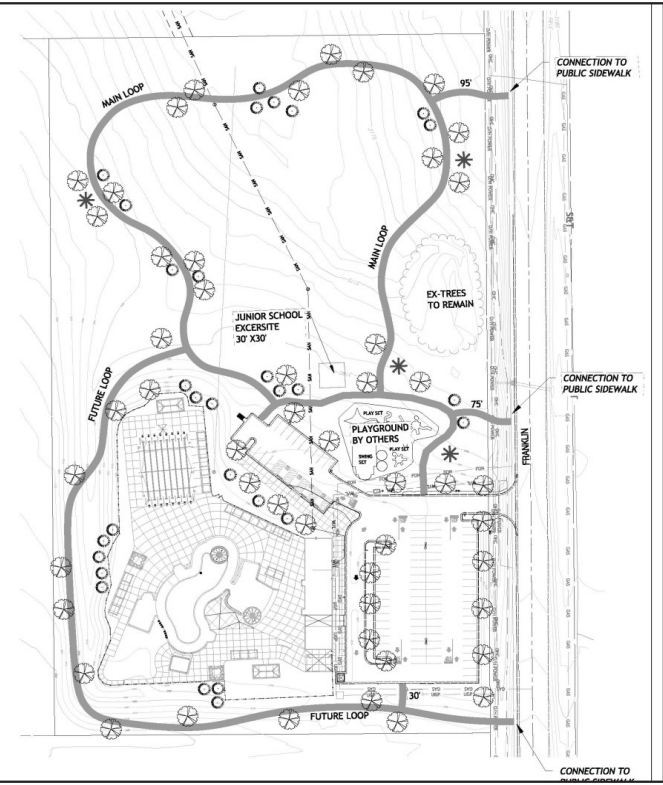

New mayor, council members sworn in Tuesday

From "MAYOR," Page 1

room during discussion and voting.

Gatz finished by handing out copies of both the U.S. and Kansas Constitutions.

In other business:

- Cindy Cersovsky brought more information on disaster insurance for the power plant. The power plant has only ever had mechanical breakdown insurance on the generators, said City Manager Carolyn Armstrong, and the city asked Cersovsky to get quotes for additional coverage.

Cersovsky said the coverage would cost the city \$26,150 annually, about half the initial estimate. It would cover disasters such as fire, hail or vandalism.

Taylor said the Federal Emergency Management Agency would provide money for any disaster the city is likely to face if the county is declared a disaster area. Adrian said that amount would likely be less now with recent government budget cuts.

Taylor said most of what would happen to the power plant would be mechanical failure, which is already covered.

The council asked Cersovsky to get a quote on basic disaster coverage, which would include fire

and wind, and get back to them.

- Theron Froggatte of Oppenheimer and Co. reported on the \$1.13 million bond sale for the Willow Avenue improvements. Any investment banks who wanted to bid were contacted and sent information, he said, and the city got a low bid of 3.54 percent interest from Country Club Bank of Prairie Village.

Froggatte said these bonds will be paid back using property tax and sales tax revenue from within the tax increment district, which includes Bosselman Travel Stop, Wendy's and Hampton Inn.

The council approved an ordinance and a resolution authorizing the issuance of the bonds.

- City Recreation Director Stacey Lee made her annual report to the council. The Recreation Commission has 34 programs over the course of the year, she said, and they are always looking for new ones. Programs include Tae Kwon Do, fitness activities, cooking, basketball and volleyball camps, youth basketball, softball, T-ball and swimming lessons.

• The council approved expanding the Wildlife and Parks Department program at Villa High Lake into a Community Fisheries Assistance Program. Under the new agreement, the department gives

the city \$1,822 on April 1 and \$607 on Oct. 1 to buy fish for the lake. In return the city has to do at least \$1,822 of maintenance on the lake.

The vote was unanimous. Councilman Mark Beringer described the program as a "no brainer."

- The council discussed giving an employee discount on concession for life guards and cashiers at

the new pool.

Councilman Tim Hutfles said he thought 10 percent would be reasonable. Beringer said it is difficult to decide on a discount before knowing how much money is going to be coming in and how much operating costs will be.

The council tabled the discussion, agreeing to revisit it once the pool has been in operation for a

few weeks.

Armstrong said he now has 28 applicants for jobs at the pool, none of whom have asked for a discount.

- Adrian read a proclamation declaring April 29 as Arbor Day in Colby. The proclamation is one of the requirements for being a Tree City U.S.A., which Colby has been for nine years.

LOCAL TV LISTINGS

sponsored by the

Saturday Evening										April 23, 2011		
	7:00	7:30	8:00	8:30	9:00	9:30	10:00	10:30	11:00	11:30		
KAKE/ABC	The Ten Commandments										Local	
KBSL/CBS	CSI: NY		CSI: Miami		48 Hours Mystery		Local					
KSNK/NBC	Chase		Law & Order: LA		Law & Order: SVU		Local		Saturday Night Live			
KSAS/FOX	Cops	Cops	Amer. Most Wanted		Local		Fringe		Fame	Local		
Cable Channels												
A & E	Dog	Dog	Storage		Storage	Parking	Parking	Parking	Dog	Dog		
AMC	Die Hard		Storage		Storage	Parking	Parking	U.S. Marshals		Dog		
ANIM	It's Me or the Dog		Cats 101		Cats 101		It's Me or the Dog		Cats 101			
BRAVO	House		House		House		House		House			
CMT	Stroker Ace		Billy Madison		Ron White: Fix		Terry Fator					
CNN	CNN Presents		Piers Morgan Tonight		Newsroom		CNN Presents		Piers Morgan Tonight			
COMEDY	Disaster Movie		South Pk	South Pk	S. Park	South Pk	South Pk	South Pk	South Pk	South Pk		
DISC	Desert Car Kings		Desert Car Kings		Desert Car Kings		Desert Car Kings		Desert Car Kings			
DISN	Lemonade Mouth		Good Luck		Shake It	Shake It	Wizards	Wizards	Good Luck	Good Luck		
E!	Liar Liar		Sex and t		Sex and t	Sex and t	The Soup	Chelsea	Kendra	Kendra		
ESPN	NBA Basketball		NBA Basketball		NBA Basketball		SportsCtr					
ESPN2	College Baseball		Baseball Tonight		SportsCenter		Baseball Tonight					
FAM	Jumanji		Beetlejuice		Pirates-Carib.							
FOOD	Challenge		Challenge		Cupcake Wars		Iron Chef America		Challenge			
FX	Slumdog Millionaire		Two Men	Two Men	Two Men	Two Men	Archer	Slumdog Millionaire				
HGTV	Cash & Ca Block		Secrets	Antonio	House	House	Hunters	Hunters	Secrets	Antonio		

We Celebrate Hometown Life

Stories from hometowns just like yours. Look for us each week in this paper.

HIST	Secret Access		Jesus: The Lost		Secret Access		
LIFE	Serendipity		William & Kate		William & Kate		
MTV	The Real World		The Real World		The Real World		America's Best Dance
NICK	iCarly	Ninjas	Victorloui	iCarly	George	Lopez	My Wife
SCI	Final Destination 2		Roadkill		The Hitcher		
SPIKE	Crocodile Dundee		Crocodile Dundee II		Crocodile Dundee		
TBS	Shrek		Shrek		Fun With Dick & Jane		
TCM	Gunga Din		Sea Fury		Sea Devils		
TLC	48 Hours: Hard Evid.		48 Hours: Left		48 Hours: Hard Evid.		48 Hours: Left
TNT	Jurassic Park		10,000 B.C.		Batman & Robin		
TOON	The Wizard of Oz		King-Hill	King-Hill	Venture	Fam. Guy	Boondocks
TRAV	Ghost Adventures		Ghost Adventures		Ghost Adventures		Bleach
TV LAND	AllFamily		Raymond	Raymond	Raymond	Raymond	Raymond
USA	Law & Order: SVU		Law & Order: SVU		Law & Order: SVU		Roseanne
VH1	SNL		Saturday Night Live		Mob Wives		Save the Last 2
WGN	Bones		Funniest Home Videos		WGN News at Nine		South Pk
Premium Channels							
HBO	Harry Potter-Prince		Cinema Verite		Game of Thrones		Sherlock Holmes
MAX	Beth Coop		First Blood		Percy Jackson		Life on Top 04
SHOW	Nurse		Tara		Jon Lovitz Presents		Boxing

©2009 Hometown Content, listings by Zap2it

'Suitability' issue still undecided

From "ISSUE," Page 1

the educational experience for all Kansas children."

"The governor has always seen the discussion about education suitability and the school finance formula as something that would happen over the next two years," Jones-Sontag said.

House Speaker Mike O'Neal has led his chamber's efforts to change the definition of suitability to show the courts that the state is paying its fair share. He says there are other sources of money that the court isn't necessarily considering when calculating the total school bill.

"In my view, we already have in the statutes what we are asking the schools to do in the way of curriculum," said O'Neal, a Hutchinson Republican. "Our emphasis is on having the court recognize to a

greater extent than just the money that goes through the formula, the amount of money that is expended on a per pupil basis."

One of the bills still in the House would change the way the state distributes aid to schools for students considered at risk of failing. The change would distribute extra money based on student performance on state assessments, not eligibility for free or reduced-priced lunches as it is now.

Other bills would allow districts to tap reserve accounts, and count that money as part of the state's overall effort.

"All of these are part of a scheme to prop up base state aid," O'Neal said.

The base is expected to be cut by as much as \$250 per student, going from \$4,012, to \$3,762.

Have Diabetes? Covered By Medicare?

Get a FREE TALKING METER and Testing Supplies at NO COST!

We help diabetics live a better life:

- Free Home delivery of diabetes supplies
- Free Consultation with a diabetes specialist
- Free Shipping and No-Risk Guarantee
- Friendly reorder reminders
- Meter eliminates painful finger pricking

We carry the brands you know

Call Now And Qualify In Minutes For

FREE TALKING METER 1.888.667.5901

as seen on...

...together we're healthier

Powered by **iON My Health**

Sunday Evening										April 24, 2011	
	7:00	7:30	8:00	8:30	9:00	9:30	10:00	10:30	11:00	11:30	
KAKE/ABC	Extreme Makeover										
KBSL/CBS	The Amazing Race		Beyond Black		Brothers & Sisters		Local				
KSNK/NBC	America's		Celebrity Apprentice		Local		Local		Dateline NBC		
KSAS/FOX	The Simpsons Movie		Local		Local						
Cable Channels											
A & E	Criminal Minds		Criminal Minds		Breakout Kings		Breakout Kings		Criminal Minds		
AMC	88 Minutes		The Killing		The Killing		The Killing		Breaking Bad		
ANIM	River Monsters		River Monsters		River Monsters		River Monsters		River Monsters		
BRAVO	Housewives/NYC		Housewives/OC		Housewives/OC		Happens		Housewives/OC		Happens
CMT	Billy Madison		Stroker Ace		Dukes of Hazzard: Begin						
CNN	CNN Presents		Piers Morgan Tonight		Newsroom		CNN Presents		Piers Morgan Tonight		
COMEDY	Scary Movie 4		South Pk	South Pk	South Pk	South Pk	South Pk	South Pk	South Pk	South Pk	
DISC	Human Planet		Human Planet		MegaQuake		Human Planet		Human Planet		
DISN	WALL-E		Phineas		Phineas		Good Luck		Shake It		Hannah
E!	Khloe		Khloe		The Dance		After Lat		Chelsea		Khloe
ESPN	MLB Baseball		True Hollywood Story		SportsCenter		SportsCenter		SportsCtr		
ESPN2	Quarterback		Year/Quarterback		SportsCenter Special		QB Camp		QB Camp		QB Camp
FAM	Titanic		Coke		TBA		Whose?		J. Osteen		Ed Young
FOOD	Challenge		Last Cake Standing		Cake		Cupcake Wars		Last Cake Standing		
FX	Step Brothers		Role Models		What Happens		Income		Holmes Inspection		