

Classifieds

To place your classified ad, mail (155 W. Fifth), fax (785-462-7749), phone (785-462-3963), or stop by our office at 155 W. Fifth

Real Estate

Real Estate

Real Estate

Real Estate

Real Estate

Real Estate

Homeland Realty & Auction

480 ACRES THOMAS CO. irrigated and grass 4 West of Oakley, KS. \$984/ac.
480 ACRES LOGAN CO. Cropland and grass S.W. of Oakley, KS. (Under Contract).
35 ACRES Close to I-70, Range Ave., Colby, Kansas. \$15,000/acre.
RESIDENTIAL LOTS Located South of Dillons, Colby, KS. \$6,500 per lot.
148 ACRES RAWLINS COUNTY Cropland and grass 4 1/2 miles North of Ludell, Ks. Cash rents going to Buyer. \$757/acre. Call Pat 785-443-3261.
640 ACRES GRAHAM COUNTY CRP with irrigation wells and water rights Northwest of Hill City, Kansas. (Immediate Possession). \$850/acre.
400 ACRES LOGAN COUNTY grass & cropland w/improvements located at Page City, KS. Beautiful 2 story home, barn, cattle working facility, Quonset, grain storage and cattle feeding pens. **PRICE REDUCED !!!**
480 ACRES LOGAN COUNTY sprinkler irrigated land located 1 mile North of Page City, KS. Excellent farmland with 3 wells & 3 sprinklers. \$2,150/ac.
615 ACRES LOGAN COUNTY Cropland and grassland located 1 mile North of Winona, KS. **PRICE REDUCED !!!** \$950/acre.
35.5 ACRES THOMAS CO. Grass 5 NW of Colby, KS. **UNDER CONTRACT !!**
Call Rock L. Bedore 785-443-1653

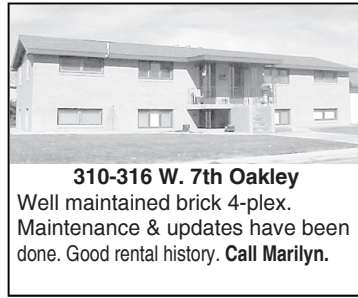
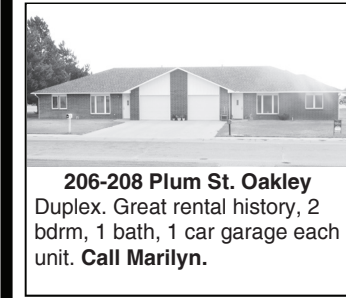

206-208 Plum St. Oakley
Duplex. Great rental history, 2 bdrm, 1 bath, 1 car garage each unit. **Call Marilyn.**

310-316 W. 7th Oakley
Well maintained brick 4-plex. Maintenance & updates have been done. Good rental history. **Call Marilyn.**

COMMERCIAL DEVELOPMENT 6.7 acres adjacent to Wal-Mart with I-70 frontage. Located in Colby, Kansas. **Call Rock.**
COMMERCIAL LOT in Colby's Industrial Area just off of I-70 Exit 53. Great building location. \$47,000. **Call Rock.**
LOCATE to Colby's fastest growing area. I-70 frontage, 2-6 acre lots. Join Colby Petro, Colby Implement and others. **Call Marilyn.**
9 UNIT MOBILE HOME PARK on West edge of Colby. Good rental history and management available. **Call Pat.**
1675 W 4th Colby 6,000 sq. ft. office/retail building plus 4,500 sq. ft. warehouse with dock. High traffic area. Move-in ready. **Call Pat**
115 Center Ave. Oakley Good investment property. Remodeled & updated. Ideal commercial Location. Call Jerry to check it out !



Agents
 Rock L. Bedore 785-443-1653
 Jerry Wycoff 785-672-0429
 Marilyn Meyer 785-462-2703
 Pat Sloan 785-460-7495

www.colbyhomeland.com

OPEN HOUSE
THURSDAY
JUNE 25, 2009
5:30 TO 6:30



1125 S. Court
 Hosted by Marilyn Meyer
 462-2703



1285 E 8th
 Hosted by Pat Sloan
 460-7495



410 N. Franklin 462-8255
 www.colbyhomeland.com

Use the *Classifieds!*

Newly Reduced!!

1906 County Rd. 15



Beautiful spacious 9 + Acres, 5 bedroom, 2 bath, double car garage. Love the country living, but need the convenience of being close to town. This is the Home for you... Come see the New kitchen, the spacious walk in closets and Huge Rec room and basement. Call Today!
\$144,000 \$129,900



**Will Sell Fast,
 Don't Miss
 Out!!!**

320 S. Mission



4 BR, 1 bath, full bsmt., fenced backyard, off-street parking.
\$35,900 \$24,900

1085 Taylor Ave., Colby, KS
 Linda Taylor - Broker

785-460-3721

www.colbysouthwindrealty.com

Stock Realty & Auction

New Listing



• 3 Bedroom, 2 bath
 • Corner lot, privacy fence
 1085 E. 8th \$75,500

Brewster Home



• Attractive & Affordable
 • Updated kitchen
 402 Nebraska \$42,500

Reduced Price



• Large Family Home
 • 5 Bedroom, 3 bath
 431 Smith Dr. \$186,000

Make Offer



• 3 Bedroom, 2 bath
 • Updated kitchen
 635 W. 4th \$73,000

MOLLY J. OLIVER
 Residential
 Specialist
 462-6133 (res.)



STOCK REALTY & AUCTION CO.
 390 N. Franklin, Ste. 100, Colby, KS 67701
 www.stockrealtyandauction.com
785-460-SOLD (7653)

QUALITY LAND BROKERS & AUCTIONEERS

New Listing



• Traditional charmer
 • 4-5 Bedroom, 2 bath
 355 W. 5th \$119,900

Brewster Home



• Traditional charmer
 • Newer siding
 202 Kansas Ave \$64,500

Reduced Price



• Starter or Rental home
 • 2 Bedroom, 2 car garage
 785 W. Summit \$37,900

New Listing



• 1.7 Acres w/trees
 • Lot 1, Block 8, Country Acres
 \$16,900 Call Molly

JUST LISTED



414 G Avenue
 Home in Menlo

Full of Charm. 2-3 bedrooms, 2 baths, lots of land. - Call Molly.

MOLLY J. OLIVER



460-SOLD (7653)
 462-6133 (Res.)
STOCK REALTY & AUCTION CO.
 390 N. Franklin, KS
 Colby, KS

**The Colby
 Free Press**
 Please recycle
 this newspaper

LAND & COMMERCIAL Opportunities

the Promise of Land.....
Commercial

Atwood

105 N. 4th - Commercial/Rental/Storage building on "Main street" \$45,000

509 N. 5th - Commercial/Manufacturing/Storage building. Rental Income \$800/month. \$185,000

119 S. 4th - "Main street" retail store with or without carpet & home decorating business. \$65,500 with business. \$56,500 building only.

Colby

420 N. Franklin - Retail/Commercial building with upstairs apartment. \$49,900

430 N. Franklin - Retail building with women's fitness center. Also upstairs apartments. \$89,900

Austin Street - Triplex Apartment Complex. Currently rents for \$1,700/month. \$165,900

Oberlin

801 N. Penn. Blue Sky Car Wash. \$200,000

Land

WE WANT TO SELL YOUR LAND!

If you are seriously considering selling your land, but have questions or concerns, contact Terry or Molly for a *no obligation market analyses.*

Stock's Full Team of "YELLOW SHIRTS" & Experience want to handle your next Auction...
 Call the "WE SELL" TEAM.

Check Our Website
www.stockrealtyandauction.com

Terry Stover: 785-626-2082 Molly Oliver: 785-462-5203
 Ron Stock: 402-649-3705 Mark Stock: 402-276-2077



STOCK REALTY & AUCTION CO.
 390 N. Franklin, Ste. 100, Colby, KS 67701
 www.stockrealtyandauction.com
785-460-SOLD (7653)

QUALITY LAND BROKERS & AUCTIONEERS

New Listing in Colby OPEN HOUSE - SAT. 2-4

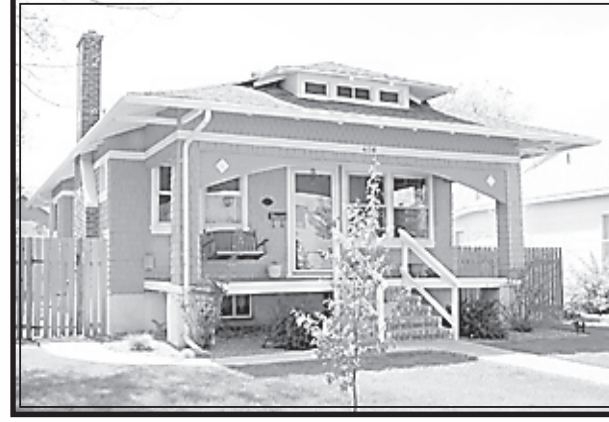

650 N. GRANT

This charming home has all kinds of extras. Four bedrooms and two bathrooms. Hardwood flooring and oak trim. Gas fireplace. Updated kitchen. Full basement. Inviting front porch. Pool table. Fenced yard. Nice patio for entertaining. Underground sprinklers. Detached garage. Newer shingles. Nice landscape. Come take a look!

**We will host an open house from
 2pm to 4pm on Saturday, June 27th.**
 For more information call Broker, Diana Skiles at the office in Atwood or visit our website.



785-626-3196 or 877-335-PINE

PINE BRANCH REAL ESTATE
 www.pinebranchrealestate.com

FARM & RANCH REALTY, INC.

1420 W. 4TH - P.O. BOX 947
 COLBY, KS 67701
 785-462-3904

DONALD L. HAZLETT, Broker

www.farmandranchrealty.com



DON HAZLETT

WE INVITE YOU TO TALK TO ONE OF OUR REAL ESTATE PROFESSIONALS!

Naomi Ward • Steve Hazlett • Ron Evans • Ed Currier • Neal Mann • Mike Bailey • Scotty Legere

AUCTION SCHEDULE

07/15/09 - 2,875+ ac Kit Carson County, Colorado cropland & grass for Gwen Miller Estate - selling in 10 tracts & combos

07/22/09 - 320 ac Greeley County, KS expiring CRP - N/2 of 26-20-41 - for Darwin & Becky Sciba

09/10/09 - Machinery & equipment auction, Ogallah, KS

Have a **SAFE & PRODUCTIVE** harvest!
 Be sure to visit **www.farmandranchrealty.com**
 for a complete listing of all upcoming auctions &
 private treaty listings!

"When you list with Farm & Ranch, it's as good as SOLD!"

YOU Can Make A Difference



REALTY AUCTION

"Western Hospitality"

www.colbyhomeland.com

410 N. Franklin
 785-462-8255



1175 Brookside \$175,000
 Very neat & move-in ready. Open floor plan, 4 bdrms, 3 baths fireplace & great back yard with sprinklers!!



1473 Pioneer Dr. \$117,500
 2.7 acres, lots of trees, room & privacy. 4 bdrm, 3 bath ranch just a few minutes from town. Heated garage/shop.

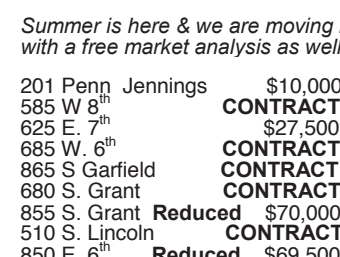

580 N. Garfield
 201 Penn Jennings \$10,000
 585 W 8th CONTRACT \$27,500
 625 E. 7th CONTRACT \$27,500
 685 W. 6th CONTRACT \$27,500
 865 S Garfield CONTRACT \$27,500
 860 S. Grant CONTRACT \$27,500
 855 S. Grant Reduced \$70,000
 510 S. Lincoln CONTRACT \$117,500
 850 E. 6th Reduced \$69,500
 580 N. Garfield CONTRACT \$133,500



310 S. Garfield \$143,000
 Look Again! New master bdrm & new bath on main floor. Love the formal dining room, parlor & fm room. Upstairs 4 bdrms and full bath. New wrapped fascia & soffits. Deck off kitchen. Great family home. Call for private tour.

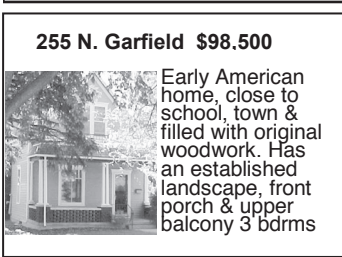

255 N. Garfield \$98,500
 Early American home, close to school, town & filled with original woodwork. Has an established landscape, front porch & upper balcony 3 bdrms



1818 Harvey Ct.
 Experience this 4 bdrm, 2.5 bath with a true master suite & walk-in closet. Detached building has a finished loft.



1105 E. 8th \$78,900
 4 bedrooms, 2 bath with all new interior paint, floor coverings & light fixtures. Open floor, totally new kitchen & separate dining area overlooking the back deck. Situated on corner lot, with oversized 2-car garage.



860 S. Court \$165,000
 5 bdrms, 3 baths, updated kitchen cabinets, open floor plan & finished bsmt with a family room. Great Buy!



855 S. Grant \$70,000
 Reduced! Open floor plan, 3 bdrm, 2 bath low maintenance brick exterior, patio, full bsmt. Room for your family to grow.

Summer is here & we are moving homes. Give us a call and let our team of experienced realtors provide you with a free market analysis as well as a personal marketing plan. **HomeLand - A TEAM WORKING FOR YOU!**

1125 S. Court NEW \$133,900
310 S. Garfield \$143,000
1175 Brookside \$175,000
735 Kings Ct "LIKE NEW"
575 LaHacienda "NEW PRICE"
1818 Harvey Ct. "UNIQUE"
206-208 Plum Oakley "DUPLEX"
1675 W 4th "COMMERCIAL"
310-316 W 7th Oakley "4-PLEX"
Residential & Commercial Lots

Join the Sellers that list with Homeland Realty & Auction
 Your Home, along with our many other listings, will be viewed nationally.

Pat Sloan 460-7495
 Marilyn Meyer 462-2703

Rock L. Bedore 462-6930
 Jerry Wycoff 672-3763

Speak to us at homelandre@hotmail.com