



Classifieds

Vehicles for Sale

1987 Chevy 1/2 ton pick-up. Navy blue. \$1,250. 785-443-3567. ---7/17---7/23---

2001 GMC 2500 HD, excellent condition, must see to appreciate. 785-443-2625. ---7/16---7/28---

1981 Mercedes 240 Diesel with a fuel heater to be able to run on used vegetable oil. Runs excellent with no blow-by, nice interior, nice exterior, new stereo and speakers, new chrome, rims & tires, moonroof and full power. 186,171 miles. Asking \$4,850.00. 785-460-9794. ---7/14---7/25---

1998 F-150 Ford Supercab XLT, 5.4 triton, 2WD, tinted windows, power, Alpine MP3/Ipod CD receiver, four Alpine speakers, Infinity reference series, 4-channel AMP 2-10", Infinity subs, custom wheels, new tires, great school pickup. 785-460-6267. ---7/10---7/23---



Public Notice

NOTICE OF BUDGET HEARING

The governing body of Barrett Township THOMAS COUNTY will meet on the 12th day of August, 2008 at 8 p.m., at Township Hall in Levant KS, for the purpose of hearing and answering objections of taxpayers relating to the proposed use of all funds and the amount of ad valorem tax.

Detailed budget information is available at and will be available at this hearing.

BUDGET SUMMARY

Proposed Budget 2009 Expenditures and Amount of 2008 Ad Valorem Tax establish the maximum limits of the 2009 budget. Estimated Tax Rate is subject to change depending on the final assessed valuation.

Fund	Prior Year Actual 2007		Current Year Estimate 2008		Proposed Budget 2009		Est. Tax Rate*
	Expenditures	Actual Tax Rate*	Expenditures	Actual Tax Rate*	Expenditures	Amount of 2008 Ad Valorem Tax	
General	81,692	19.800	57,207	20.944	56,527	52,192	22.243
Bond & Interest							
Road							
Special Machinery							
Totals	81,692	19.800	57,207	20.944	56,527	52,192	22.243
Less: Transfers	0		0		0		
Net Expenditure	81,692		57,207		56,527		
Total Tax Levied	51,549		51,549		51,549		
Assessed Valuation:							
Township	2,603,314		2,461,257		2,346,459		
Outstanding Indebtedness,							
Jan 1	2006		2007		2008		
G.O. Bonds	0		0		0		
Other	0		0		0		
Lease Pur Price	69,192		69,192		69,192		
Total	69,192		69,192		69,192		

*Tax rates are expressed in mills.

Shawn Scholte
Township Officer

Page No. _____

(Published in the Colby Free Press July 18, 2008.)

NOTICE OF BUDGET HEARING

The governing body of West Hiale Township THOMAS COUNTY will meet on the 4th day of August, 2008, at 8 p.m., at Brewster City Hall for the purpose of hearing and answering objections of taxpayers relating to the proposed use of all funds and the amount of ad valorem tax.

Detailed budget information is available at and will be available at this hearing.

BUDGET SUMMARY

Proposed Budget 2009 Expenditures and Amount of 2008 Ad Valorem Tax establish the maximum limits of the 2009 budget. Estimated Tax Rate is subject to change depending on the final assessed valuation.

Fund	Prior Year Actual 2007		Current Year Estimate 2008		Proposed Budget 2009		Est. Tax Rate*
	Expenditures	Actual Tax Rate*	Expenditures	Actual Tax Rate*	Expenditures	Amount of 2008 Ad Valorem Tax	
General	13,678	4.325	13,565	1.245	16,300	6,396	1.584
Bond & Interest							
Road	32,810	8.870	20,233	10.355	21,210	15,112	10.397
Noxious Weed							
Special Machinery							
Totals	5,128		33,798	11.600	37,510	21,508	11.981
Less: Transfers	51,616	13.195	0		0		
Net Expenditure	13,734		33,798		37,510		
Total Tax Levied	37,882		33,798		37,510		
Total Assessed Valuation	21,383		4,037,891		4,037,891		
Township Assessed Valuation Only	1,620,486		4,151,459		1,453,475		
Outstanding Indebtedness,							
Jan 1	2006		2007		2008		
G.O. Bonds	0		0		0		
Other	0		0		0		
Lease Pur Price	0		0		0		
Total	0		0		0		

*Tax rates are expressed in mills.

Don Hazzlett
Township Officer

(Published in the Colby Free Press July 18, 2008.)

NOTICE OF PUBLIC HEARING ON PROPOSED REZONING IN THE CITY OF COLBY, KANSAS

TO ALL PERSONS CONCERNED:

You and each of you are hereby notified that the Colby/Thomas County Metropolitan Area Planning Commission will hold a Public Hearing in the Council Chambers of City Hall, 585 N. Franklin, Colby, Kansas, at 9:30 A.M. on Thursday, August 14, 2008, to hear a request for a zoning change from Bob Coleman, Dane Rogers, Walter Kane, and Fred Haines, owners, from I-1 (Light Industrial District) to R-3 (Multiple Dwelling District), on property more particularly described as follows:

Lots 1, 2, 3, 4, & 5, Block 51, East Addition; Lots 16, 17, & 18, Block 51, East Addition; the East 45' of Lots 19 & 20, Block 51, East Addition; the West 80' of Lots 19 & 20, Block 51, East Addition

According to Statutes, all property owners in a radius of 200 feet will be notified of this request.

Joni L. Ketchum
Joni L. Ketchum, City Clerk

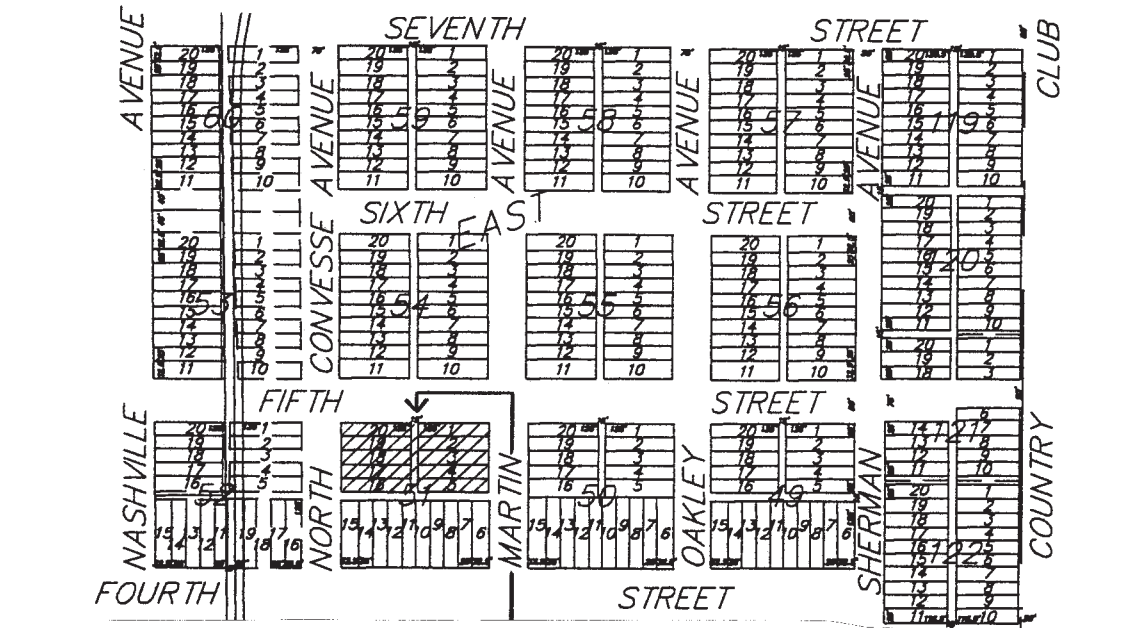

Proposed Area to be Rezoned
(Published in the Colby Free Press July 18, 2008.)



To place your classified ad, mail (155 W. Fifth), fax (785-462-7749), phone (785-462-3963), or stop by our office at 155 W. Fifth

Garage Sales

Sat., July 19th, 8 a.m. to 12 noon, 1735 Lynda. Furniture: round table w/ leaf, 4 chairs; black leather swivel glider/rocker, lane recliner, sofa, day bed, love seat, golf clubs & Bags, (men & women), Lawn mower, IHC cub cadet, lots of misc. ---7/16-7/18----

265 E. Cherry, Colby. Friday 5-8 p.m., Saturday 8-?. Boy clothes 0-3T, baby items, household misc. ---7/16-7/18----

1870 W. 5th - Saturday, July 19th, 8:00-1:00. Men's golf clubs, antique Singer sewing machine in cabinet, exercise equip., glassware, clothing & lots of miscellaneous - something for everyone! ---7/16-7/18----

Public Notice

NOTICE OF BUDGET HEARING

The governing body of Kingley Township THOMAS COUNTY will meet on Wednesday the 13th day of August, 2008, at 7:30 p.m., at 573 County Rd 8, Levant, KS for the purpose of hearing and answering objections of taxpayers relating to the proposed use of all funds and the amount of ad valorem tax.

Detailed budget information is available at 573 County Rd 8, Levant, Kansas and will be available at this hearing.

BUDGET SUMMARY

Proposed Budget 2009 Expenditures and Amount of 2008 Ad Valorem Tax establish the maximum limits of the 2009 budget. Estimated Tax Rate is subject to change depending on the final assessed valuation.

Fund	Prior Year Actual 2007		Current Year Estimate 2008		Proposed Budget 2009		Est. Tax Rate*
	Expenditures	Actual Tax Rate*	Expenditures	Actual Tax Rate*	Expenditures	Amount of 2008 Ad Valorem Tax	
General	107,500	18.200	101,371	18.224	81,237	60,121	18.864
Bond & Interest							
Road							
Special Machinery							
Totals	107,500	18.200	101,371	18.224	81,237	60,121	18.864
Less: Transfers	0		0		0		
Net Expenditure	107,500		101,371		81,237		
Total Tax Levied	61,469		61,469		61,469		
Assessed Valuation:							
Township	3,377,451		3,647,255		3,187,041		
Outstanding Indebtedness,							
Jan 1	2006		2007		2008		
G.O. Bonds	0		0		0		
Other	0		0		0		
Lease Pur Price	0		0		51,697		
Total	0		0		51,697		

*Tax rates are expressed in mills.

Ray D. Duncan
Township Officer

(Published in the Colby Free Press July 18, 2008.)

NOTICE OF BUDGET HEARING

The governing body of SOUTH RANDALL THOMAS COUNTY will meet on the 12th day of August, 2008 at 7:00 a.m., at Colonial Steak House for the purpose of hearing and answering objections of taxpayers relating to the proposed use of all funds and the amount of ad valorem tax.

Detailed budget information is available at and will be available at this hearing.

BUDGET SUMMARY

Proposed Budget 2009 Expenditures and Amount of 2008 Ad Valorem Tax establish the maximum limits of the 2009 budget. Estimated Tax Rate is subject to change depending on the final assessed valuation.

Fund	Prior Year Actual 2007		Current Year Estimate 2008		Proposed Budget 2009		Est. Tax Rate*
	Expenditures	Actual Tax Rate*	Expenditures	Actual Tax Rate*	Expenditures	Amount of 2008 Ad Valorem Tax	
General	110,466	12.349	77,395	12.124	93,572	75,039	12.157
Bond & Interest							
Road	6,919						
Noxious Weed	194						
Special Machinery							
Totals	117,579	12.349	77,395	12.124	93,572	75,039	12.157
Less: Transfers	7,113		0		0		
Net Expenditure	110,466		77,395		93,572		
Total Tax Levied	72,502		72,502		72,502		
Total Assessed Valuation	5,871,276		5,979,895		6,172,382		
Township Assessed Valuation Only					6,021,177		
Outstanding Indebtedness,							
Jan 1	2006		2007		2008		
G.O. Bonds	0		0		0		
Other	0		0		0		
Lease Pur Price	108,685		93,726		93,721		
Total	108,685		93,726		93,721		

*Tax rates are expressed in mills.

Bob Utley
Township Officer

(Published in the Colby Free Press July 18, 2008.)

1977 - 2007
30
YEARS OF
EXPERIENCE
EXPERTISE
EXCELLENCE

FARM & RANCH REALTY, INC.

1420 W. 4TH - P.O. BOX 947
COLBY, KS 67701
785-462-3904
DONALD L. HAZLETT, Broker

www.farmandranchrealty.com

WE INVITE YOU TO TALK TO ONE OF OUR REAL ESTATE PROFESSIONALS!

Naomi Ward • Steve Hazlett • Ron Evans • Ed Currier • Neal Mann • Mike Bailey • Scotty Legere

JUST LISTED!

185 S. Franklin - \$32,000

2108 E. Hwy 24
13+ acres w/27,000 sq. ft. of office, shop & storage bldgs -Great Access!! Available early 2009!

424 Smith Dr - \$210,000

REAL ESTATE FOR SALE

SHERMAN CO: MORGAN RANCH - 2,560 ac working ranch with improvements -10 mi S of Goodland on the North Fork of the Smoky Hill River

GRAHAM CO:

- 80 acres grassland w/improvements, NW of Hill City - JUST LISTED!!
- PRICE REDUCED on 26 ac farmstead - 1,900 sq. ft. home w/3 Br's. barn, shop, 7 bay storage shed, & more - 6 mi S of Lenora

CHECK OUR WEB SITE FOR ADDITIONAL LISTINGS!

8ac NW of Colby - \$159,000

271 CR 11, Winona - \$105,000

810 N. Country Club - \$59,900

360 N. Nashville - \$23,000

AUCTION SCHEDULE

7/22/08 - Farm Machinery & Equip for Robert, Mike & Joe Farrell, Hill City, KS
9/16/08 - Farm Machinery & Equipment for Richard Weak's Estate, Joes, CO

"When you list with Farm & Ranch, it's as good as SOLD!"

Use the Classifieds!