

# Classifieds

To place your classified ad, mail (155 W. Fifth), fax (785-462-7749), phone (785-462-3963), or stop by our office at 155 W. Fifth

## Apartments

## Notice

## Real Estate

## Real Estate

## FARM MACHINERY & EQUIPMENT

TUES, NOV 6, 2007  
@10:30 AM, CST

## ABSOLUTE AUCTION

SELLERS: GODDARD RANCH, ET AL.

**AUCTION LOCATION:** From Hill City, KS go 10 miles West on Hwy 24, then 3½ miles North on the Lenora road to the ranch OR from Lenora, KS go 14 miles South to the ranch. **SIGNS WILL BE POSTED!**



### TRACTORS:

- '82 JD 4440, 3pt, 3 SVCs, QR
- '79 JD 4240, 3pt, 2 SVCs, QR, 9' Otter dozer
- 656 Hydro Tractor

### BACKHOE, LOADERS & GRADERS:

- Case DH5 trencher/backhoe
- '72 922B CAT wheel loader, 1½ yd bucket
- Huber Warco road grader, 14' blade
- Farmhand XL940 grapple loader
- Snow plow V blade

### TRUCKS, PICKUPS & SNOW

### MOBILE:

- '94 IHC semi, L-140 Cummins
- '89 Volvo semi
- '81 Int'l 2500 semi, 855 Cummins
- '80 IHC, Cummins eng, 9 spd
- '80 Ford 8000, diesel, 4spd auto, TS, w/20' B&H, 60" sides
- '80 IHC 4300 semi, 855 Cummins, 35HP, 15 spd Road Ranger
- '79 Ford Louisville, single axle
- '74 Chevy C60, 350, 4x2, 1,500 gal water tank w/Gorman 3" PTO pump
- '69 Chevy C50, 6 cyl, 4x2, B&H
- '67 Int'l 190 flatbed, gas, 5x3, hoist, bale racks
- '50 Ford F6 - WBTH, 4spd, B&H
- '99 Ford F-350 4x4, powerstroke 6 spd manual
- '90 Ford Ranger Pickup
- '86 Chevy S-10, auto
- JD snowmobile

### IRRIGATION EQUIPMENT:

- T&L 7-tower center pivot sprinkler
- 2,500' 6" gated aluminum irri pipe
- 4" tailwater pump w/318 Chrysler

### BALERS, TUBGRINDER & SWATHER:

- '80 JD 346 square baler, twine tie
- JD 530 round baler, twine tie
- Haybuster 1100 tubgrinder, 3406 CAT eng
- JD 2280 14' Swather, 4219DE eng

### TRAILERS:

- '91 48'x102' Miller van trailer
- '90 48'x102' Fruehauf van trailer
- '74 Golden Nugget 30' GN 330 flatbed trailer, 7,500# axle
- '74 End dump gravel trailer
- '59 Fruehauf 46' cattle floor trl
- '50 Carja 30T low boy 25' trailer
- 18 bale "electric over hydraulic" self dump trailer
- Galion H/1013'6" steel dump B&H
- Semi water tank trailer
- 7,500 gal 40' water trailer

### FEED TRUCKS & LIVESTOCK

### EQUIPMENT:

- '88 GMC 7000 feed truck, diesel, 3208 CAT eng, 5 x2 spd, 330 Oswalt mixer box w/scales
- '74 Ford LN600, 350 Harsh feed box w/scales
- Oswalt 1830 PTO feed wagon
- Gehl 5'x12' feed wagon
- Cisco "Dump Chief" silage wagon
- Henke 36" roller mill, 471 Detroit
- Ross 42" PTO roller miller on trl
- Portable loading chute
- 3pt bale clamp

### FARM MACHINERY:

- '02 Case IH 1200 6-row planter
- IH 400 Cyclo 6-row planter
- JD 885 6-row cultivator
- IH 6-row cultivator
- 3) 8' Lilliston Melroe 284 hoe drills, 1010
- Brady 630 14' stalk shredder
- 11-shank V ripper
- IH 12-14 hoe drill
- Hesston 60 stakmover
- 24' Crustbuster
- Coop 15' chisel
- 14' ripper
- Case plow, 20' lathes
- Krause 20' disc
- 2) JD 812 LZ drills
- Noble 4x5 blade plow
- SF14' offset disc
- Buffalo planter
- Seed cleaner
- Hutchinson 42'x8" PTO auger

### SHOP EQUIPMENT:

- Manley 52T shop press
- Qualair 3-phase 120 gal air compressor
- AND MANY MORE ITEMS TOO NUMEROUS TO LIST!

www.farmandranchrealty.com

## FARM & RANCH REALTY, INC.

Scotty Legere, Agent (785-650-9970)  
1420 W. 4<sup>TH</sup> - COLBY, KS 67701

1-800-247-7863

DONALD L. HAZLETT,  
BROKER/AUCTIONEER

"When you list with Farm & Ranch, it's as good as SOLD!"

## FALL INTO A GREAT HOME!



## 1240 Lue Drive, Colby PRICE REDUCED - \$279,900

**Partial Seller Financing (if qualified)**  
**Would consider trades for Home or Land**  
5400+ sq. ft., 5 bedrooms, 3 bath, walk-out basement, double-car garage, large Great Room, beautiful landscaping. Country feel.



## 1730 W. 5th, Colby WOULD CONSIDER OFFER! - \$110,000

3-4 bedrooms, 2 bathrooms, partial basement, great kitchen, 1,790 sq. ft., all appliances, single-car garage and private backyard.

Call Linda @ Southwind Plaza for retail spaces available for lease - 460-3058.



1085 Taylor Ave., Colby, KS  
Linda Taylor - Broker  
**785-460-3721**  
www.colbysouthwindrealty.com

Reach over 14,000 homes weekly with our Colby Free Press/Country Advocate combo ads

USE THE  
CLASSIFIEDS!

## Heartland Rural Counseling Services, Inc.

270 N. Franklin, Suite C • Colby, KS  
Specializing in individual, family, marital, adolescence, child therapy, diagnostic testing, adoption home studies, anger mgmt. and parenting classes.  
**785-460-7588 (Colby)**



**Jacquie Golemboski**  
Mortgage Loan Officer  
MEMBER FDIC EQUAL HOUSING LENDER

240 W. 4th, Colby, KS  
**785-460-3321**  
1-866-460-3321

## ARE YOU DREAMING OF OWNING YOUR OWN HOME...BUT WONDERING HOW TO FINANCE IT???

We have many options to choose from, one of which is sure to make it easier for you to buy your dream home. Rates are low and there are still many houses available to choose from.

So give me a call today at 785-460-3321 to set up an appointment to get pre-qualified for the home of your dreams.



## Auction COLORADO RANCH - HORSE PROPERTY - HUNTING

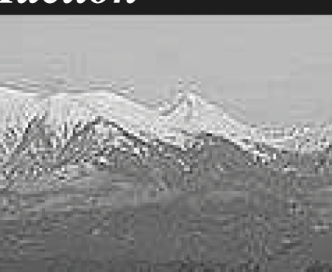

October 27, 2007 1:00 PM  
Gardner, Colorado

- Sangre De Cristo Mountain Views
- 79.87 Acres
- Two Ranch Houses
- Several Out Buildings
- Corrals
- National Forest Access within 7 miles of property

FMI - Gatlin Auction 719-252-3758 www.gatlinauction.com  
Broker: Haney Real Estate LLC 719-240-8137

Pre Auction Internet Bidding at [www.purplewave.com](http://www.purplewave.com)



## Harvest Sale



Farm Storage  
starting at: 40'x60' \$18,479 | 50'x70' \$24,648 | 60'x80' \$33,785

Call for details, offers end 10/30/07, travel beyond 60 miles, local requirements, permits, taxes, etc to be added.

1-800-447-7436 • [www.mortonbuildings.com](http://www.mortonbuildings.com)

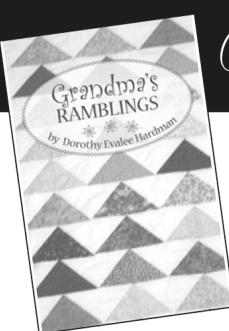

## We Publish Your Life!

A NEW way to print family history books.

Turn your treasured memories into a beautifully bound book to last a lifetime.

Professional design  
Hardback  
Paperback  
Reasonable prices  
Kansas company



888-888-7696 • [www.leatherspublishing.com](http://www.leatherspublishing.com)

## AVANDIA® SIDE EFFECTS

The diabetes drug Avandia® has been linked to an increased risk of serious and potentially fatal injuries. If you or a loved one took Avandia and had a Heart Attack, Stroke, Heart Failure or Death, please contact us for a free consultation.

Hollis Law Firm, P.A. **800-701-3672**

## FARM & RANCH REALTY, INC.



1420 W. 4<sup>TH</sup> - P.O. BOX 947  
COLBY, KS 67701  
785-462-3904

DONALD L. HAZLETT, Broker

[www.farmandranchrealty.com](http://www.farmandranchrealty.com)



DON HAZLETT

WE INVITE YOU TO TALK TO ONE OF OUR REAL ESTATE PROFESSIONALS!

Naomi Ward • Steve Hazlett • Ron Evans • Ed Currier • Neal Mann • Mike Bailey • Scotty Legere

## AUCTION SCHEDULE

- 11/01/07 - 320 ac Gove Co cropland, ½ miles NW of Quinter selling in tracts for the Lori Kimball, Brent Jones & Brad Jones
- 11/06/07 - Farm Machinery Auction for Goddard Ranch, North of Morland Ruda Family Farm - 2 Day Machinery Auction
- 11/14/07 - All livestock equipment, shop tools & equip.
- 11/15/07 - Tractors: JD 8530, JD 8520, JD 8300, JD 7410, JD 4455, AC 7060; Combine: JD 9660 STS, Sprayers: JD 4720, 4455 Spra-Coupe; 3 Air seeders; Trailers, 4 Semi Trucks, Pickups, Farm Machinery & much more! Sale bills available mid-October!
- 11/17/07 - Annual Fall Consignment Auction - Colby, KS - CALL TO CONSIGN TODAY!!
- 11/27/07 - Farm Machinery & Equip for Louis & Sanfra Box, Arapahoe, CO
- 11/28/07 - 160 ac irrigated cropland - NW/4 of 8-13-42, Cheyenne Co., CO

## REAL ESTATE FOR SALE

- WALLACE**- 160 ac CRP in NE of Wallace - **JUST LISTED!**
- GOVE**- 160 ac CRP SW of Gove, KS - **JUST LISTED!**
- GRAHAM**- 140 ac mostly cropland with some creek bottom located 5E & 4S of Hill City NE/4 of 3-9-22 - exc hunting potential - **JUST LISTED!!**
- CHEYENNE**- 3 qtrs 3W & 4N of Bird City- 410± ac cropland, 50± ac grass, and improvements - **NEW PRICE!**



8ac NW of Colby  
\$159,000



271 CR 11, Winona  
\$125,000



440 S. Court  
Great Business Opportunity



**Commercial Building**  
1921 S. Range

"When you list with Farm & Ranch, it's as good as SOLD!"

SERVING YOU -  
OUR SPECIALTY

## HomeLand REAL ESTATE, LLC

[www.colbyhomeland.com](http://www.colbyhomeland.com)

MULTIPLE LISTING SERVICE  
**MLS** EQUAL OPPORTUNITY

### "BEYOND WORDS"



1818 Harvey Ct.



825 W. 8th \$130,000

### "ABUNDANCE OF SPACE"



413 Nebraska \$70,000

### "QUIET LOCATION"



555 E. 8th \$52,500

### "REDUCED"



665 W. 4th \$89,500

### "COZY BREAKFAST NOOK"

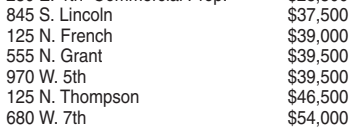

230 N. Mission \$62,500

### "WELCOME HOME"

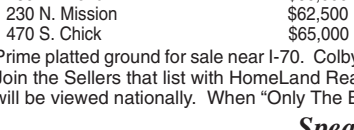

1065 N. Brookside \$129,500

### "FAMILY ORIENTED"



1060 Villa Vista

### "CALL FOR NEW PRICE"



880 Thompson

### "BIGGER THAN IT LOOKS"



160 S. Garfield \$69,900

### "A BIT OF HISTORY HERE"



615 N. Court \$56,500

### "TWO FOR PRICE OF ONE"



260 S. School \$115,000

### "EXCELLENT VALUE"



260 W. Cedar \$69,500

### "READY & WAITING"



230 N. Mission \$62,500

### "LOOKING FOR YOU"



330 E. Hill \$105,000

### "WELCOME HOME"



1065 N. Brookside \$129,500

### "FAMILY ORIENTED"



1060 Villa Vista

### "CALL FOR NEW PRICE"



880 Thompson

### "BIGGER THAN IT LOOKS"



160 S. Garfield \$69,900

### "A BIT OF HISTORY HERE"



615 N. Court \$56,500

### "TWO FOR PRICE OF ONE"



260 S. School \$115,000

### "EXCELLENT VALUE"



260 W. Cedar \$69,500

### "READY & WAITING"



230 N. Mission \$62,500

### "LOOKING FOR YOU"



330 E. Hill \$105,000

### "WELCOME HOME"



1065 N. Brookside \$129,500

### "FAMILY ORIENTED"



1060 Villa Vista

### "CALL FOR NEW PRICE"



880 Thompson

### "BIGGER THAN IT LOOKS"



160 S. Garfield \$69,900

### "A BIT OF HISTORY HERE"



615 N. Court \$56,500

### "TWO FOR PRICE OF ONE"



260 S. School \$115,000

### "EXCELLENT VALUE"



260 W. Cedar \$69,500

### "READY & WAITING"

