

# Classifieds

Help Wanted

**RN/LPN.** St. John's of Hays, a 60 bed, not-for-profit nursing home is accepting applications for full time and part time Charge Nurse for the evening or night shifts. We offer flexible scheduling. If you are interesting in caring for the elderly, please inquire by calling 785-628-3241 or send resume to 2401 Canterbury, Hays, KS 67601.

—2/12—2/26—

Help Wanted

**In private home:** mature woman, permanent position, M-F, 8:00 a.m. - 4:00 p.m., cooking noon meal, caring for disabled elderly man. For interview call 462-6965.

—1/28—2/20—

Notices

**Make a difference...**and receive free meals, products and services. Be a mystery shopper. Apply on-line at [www.secretshopnet.com](http://www.secretshopnet.com).

—2/11—2/16—

**Looking for** a feed truck driver for a 9,000 head feedyard. Good working conditions and benefits. Call Greg at 785-855-2336 or 308-340-2876.

—2/11—2/25—

**RN & LPN openings**, full or part-time. Full time CNA's 2-10 shift. Lantern Park Manor, 105 E. College Dr., Colby. Rebecca Koel, D.O.N. 785-462-6721.

—2/9—2/13—

**Love your job!** Be your own boss. Start for free. [www.athome.com](http://www.athome.com)/danasamway or call 308-345-2264.

—2/9—2/20—

**Office professional.** We're looking for a friendly, upbeat person to join our staff. This person will provide clerical support for our County Extension Agents. This is a full time position, 8:00 a.m. to 5:00 p.m. Previous office experience with bookkeeping skills preferred. Excellent computer skills a must. The ideal candidate will be detail oriented, be able to reconcile bank accounts, prepare financial reports, create newsletters, and update the Extension website. Please send your resume by February 16th to: Thomas County Extension Office, 350 S. Range Ave., Suite 16, Colby, KS 67701.

—2/4—2/13—

Help Wanted

Immediate opening for full-time qualified applicant. Dealership needs detail-oriented bookkeeper with public relations and computer skills. Excellent benefits and starting salary.

Applications available at: Tubbs & Sons Ford Sales  
810 S. Range  
Colby, KS 67701  
785-460-6746

SOCIAL WORKER

A successful Child Placing Agency is seeking a licensed social worker to expand its foster care program in the **Colby** area. The position will be responsible for the recruitment and retention of new foster homes as well as maintaining a caseload that will support program expansion. Successful candidates will be responsible for identifying potential markets for foster family recruitment and the ability to train, support, and maintain a solid base of foster families. Must be able to work in an environment with limited supervision, while attaining established outcomes and goals.

Benefits include competitive starting salary; paid holidays, vacation, and sick leave; 401(k) employer matched contribution plan; health insurance plan; tuition assistance program; and computer training.

If you are interested in a career with a progressive child placing agency and a chance to build a network of foster families to care for Kansas children in the **Colby** area, please send a letter of interest and resume to: **Colby Free Press, Attn: TF, 155 W. 5th, Colby, KS 67701.**

Equal Opportunity Employer and Service Provider

GOODLAND REGIONAL MEDICAL CENTER

OFFERING RN'S AND LPN'S REWARDING CAREER OPPORTUNITIES IN

- ACUTE CARE
- MATERNITY SERVICES
- SURGICAL SERVICES
- EMERGENCY MEDICINE

PRESENTLY SEEKING OR SUPERVISOR



For more information on full time, part time, or PRN nursing opportunities, along with salary and benefit information, please contact Dale Schields, Human Resource Director, 220 West 2nd Street, Goodland, KS 67735, or call 89005 or FAX resume to (785)890-7209.

*Goodland Regional Medical Center is Equal Opportunity Employer (EOE)*

Request a FREE brochure

**Why Choose Wardcraft?**

1. Custom built to your specs since 1971
2. 2x6 construction and significantly more energy efficient
3. Specializing in rural areas of KS, NE, MO, CO & SD
4. Controlled environment ensures quality materials & workmanship unmatched by on-site builders
5. Over 60 plans or custom build

South Hwy 15 Clay Center, KS or East Hwy 6 in Minden, NE

**WARDCRAFT HOMES**

**1.888.927.3272** (toll free) or [www.wardcraft.com](http://www.wardcraft.com)



Custom

Quality

Value



Houses for Rent

**In Colby:** 3 bedroom, 1 1/2 bath, family room with fireplace, partial basement. References and deposit. Call 785-421-4118 or 785-443-0283.

—2/12—2/25—

Houses for Sale

**Townhouse located in Lawrence, KS.** Ideal for student housing. Possession date August 1st. Two miles from campus, 1,437 square feet on two floors, three bedroom, 2 1/2 bath, two car garage. Built in 1998. Call 785-462-6753 or 785-462-7188.

—2/11—2/16—

Houses for Sale

**Charming and renovated** 1920's home for sale. 2 bedroom, 1 1/2 bath, all new appliances included, \$55,000. 200 S. Mission Ridge. 462-3960.

—2/4—2/23—

Houses for Sale

**2 bedroom**, 1 bath in Atwood. Kitchen and laundry complete with appliances, attached garage, underground sprinklers, no steps, recently remodeled, \$35,000. Call 785-626-3744 or 785-626-3316, leave message.

—2/4—2/26—

Houses for Sale

**For Sale - Mobile Homes**

Houses for Sale

**5 lots**, trailer, out buildings, \$5,000 O.B.O. 785-586-2352 after 6:00 p.m. Levant.

—2/13—2/19—

Houses for Sale

**Offices for Rent**

Houses for Sale

**Approximately 1,000 square feet**, 3 offices, reception area, adequate parking. 462-2331.

—5/12—tfn—

Houses for Sale

**Building for Rent**

Houses for Sale

**1,500 square foot shop** with heat, bathroom, 16' overhead doors. 462-6692.

—2/6—2/13—

Houses for Sale

**Misc. for Sale**

Houses for Sale

**Kenmore washer and dryer**, very good condition, \$250 washer, \$150 dryer. Pedestal dining room table with 60" glass top and six upholstered chairs, exceptionally nice, \$995. Cable console style piano, \$450. Nice wood and metal sofa table, \$125. Antique dresser and mirror, \$125. Antique trunk, \$100. Cedar chest, \$85. Love seat hide-a-bed, \$145. 3 piece blonde bedroom set, \$75. 785-460-0384.

—2/13—2/19—

Houses for Sale

**Blue drapes with peach flecks** 117x93. 460-6913.

—2/11—2/16—

Houses for Sale

**What on earth** am I here for? Discover your life's purpose at Colby Wesleyan Church. 462-8391.

—2/5—2/20—

Houses for Sale

**Seed & Feed**

Houses for Sale

**120 round cane bales**, fine stem, low nitrates, \$50/ton, delivery available. 785-846-7674 Winona, Ausmus.

—2/2—2/27—

Houses for Sale

**Childcare**

Houses for Sale

**New licensed day care home.** Several openings now available. For more information call Jin 460-0440.

—2/9—3/5—

Houses for Sale

**Recreational Vehicles**

Houses for Sale

**Polaris snow mobile.** Good shape, make an offer. Call 462-6527 for more information.

—2/9—2/13—

Houses for Sale

**Vehicles for Sale**

Houses for Sale

**1992 F-250 XLT.** 7.3L, diesel, 4x4, 5 speed, runs and looks great, new tires, heavy duty rear bumper and 5th wheel reinforcement plate. Asking \$5,500. 785-694-3416.

—2/13—2/19—

Houses for Sale

**1995 Buick Century.** 4 door, white, 138,00 miles, new battery, hoses and muffler. Very reliable car, \$1,925. 785-460-0384.

—2/13—2/19—

Houses for Sale

**1997 Ford F-150 Lariat.** Extended cab, 4x4, 5.4, V-8, excellent condition. 785-460-6913.

—2/11—2/16—

Houses for Sale

**1999 F-350.** 4x4, super crew, standard, V-10, gas, dually, leather, fifth wheel plate. 443-1340.

—2/11—2/16—

Houses for Sale

**2001 Dodge Dakota Sport.** Quad cab, 4x4, 67,000 highway miles, new tires, extra sharp, \$14,400. 785-675-3857.

—2/9—2/13—

Vehicles for Sale

**1983 Oldsmobile Cierra Brougham.** 42,000 original miles, local one owner, \$1,200. Call 785-462-6394, leave message.

—2/9—2/13—

Vehicles for Sale

**1979 GMC pickup**, 1/2 ton, with top-per, change over 350 Olds engine, new carburetor and fuel pump, \$800 as is - cash. 785-694-2818. Needs carburetor adjusted.

—2/4—2/16—

Vehicles for Sale

**1989 Dodge mini van**, new tires and brakes, runs excellent, \$1,000 O.B.O. 785-460-0225.

—2/4—2/16—

Vehicles for Sale

**Find purpose in life!** Join us Sundays 10:45 a.m. Colby Wesleyan Church. 462-8391.

—2/5—2/20—

Vehicles for Sale

**1992 Ford 150**, automatic, air, cloth seats, runs good, good shape, \$4,900. Call Tom 785-672-7165.

—2/2—3/5—

Business Services

Heartland Rural Counseling Services, Inc.

270 N. Franklin, Suite C • Colby, KS

**785-460-7588**

Specializing in family issues - play therapy, marital therapy, depression, anxiety, stress, trauma, anger management, ADHD, abuse, divorce, and grief.

501 3c all donations are tax deductible

**Professional painters.** Interior and exterior. Christian painters, references available, free estimates. 785-460-0225.

—2/4—2/16—

**Will do pen cleaning** and manure spreading. Call Terry Redlin at 785-821-1481.

—1/14—tfn—

Pets / Supplies

**Blue Heeler pups.** 1 red male, 3 blue females - one is a natural bob. Ready March 1. 785-672-0008.

—2/11—2/23—

Pets / Supplies

**Ready for Valentine's Day.** Yorkshire Terriers, 4 females, first shots, dew claws removed. Tracey 443-1340.

—2/11—2/16—

Pets / Supplies

**Chocolate Lab/Chesapeake** cross pups, \$75. Ready mid-February. Call 785-475-3780 after 6:00 p.m.

—1/26—2/13—

Public Notice

**NOTICE OF PUBLIC HEARING**

You are hereby notified that a variance request will be heard at 9:30 A.M. on Friday, March 12, 2004, in the Council Chambers of City Hall for Jeffrey Barton, 155 S. Mission (Lots 13, 14, & 15, Block 2, South Park Addition).

Owner is requesting a variance to permit constructing an attached 24' x 24' addition to the Southwest side of his residence in an R-1 -- Single Family Dwelling District, which does not meet the required front yard setback as required in Zoning Ordinance No. 1257.

This public hearing will be held for the Board of Zoning Appeals. The public is invited to attend.

*Beverly J. Stiehon*  
Beverly J. Stiehon, City Clerk

Variance Request Location



(Published in the Colby Free Press on Friday, February 13, 2004)



**ARE THINGS A LITTLE TIGHT?**

Don't worry....place a **FOR SALE** ad in our newspaper and you'll be sure to get rid of all those unwanted items around your house!! *Stop in our office soon!*



**COLBY FREE PRESS**

155 W. 5th • Colby • 785-462-3963



**The FREE PRESS is available 'round the clock!!**

If you need extra copies of the *Free Press* after hours, they may be obtained from outdoor racks or inside dealers at any of the following locations:

**OUTSIDE RACKS:**

Free Press - 155. W. 5th

Love's - 265 W. 4th

Wal-Mart - 1915 S. Range

Hi-Plains Co-op - 405 E. 4th

Village Inn - 2215 S. Range

Oasis Travel Ctr. - 700 W. Horton Ave.

Quality Inn - 1950 S. Range

Conoco Travel Shoppe -1990 S. Range

Deep Rock Cafe - 1170 S. Range

Cenex - 1615 W. 4th

**INSIDE DEALERS:**

Dillons - 1605 S. Range

Total-Hot Stuff - 900 E 4th

Oakley's IGA - 127 Converse

Enjoy the *Free Press* - each day, Monday, Wednesday, Thursday and Friday. We're Thomas County's only daily NEWSpaper.



# Classifieds

Auction

Auction

Real Estate

Real Estate

Real Estate

Real Estate

## FARM MACHINERY & EQUIPMENT AUCTION

SELLERS: CLIFF & SHELLY WILSON

FRIDAY, FEBRUARY 27, 2004 @ 10:30 A.M., CST

**AUCTION LOCATION:** From Oakley, KS go East on I-70 to exit 79 at Campus, then go 2 1/2 miles South to the Farmstead. SIGNS WILL BE POSTED!!!!

**TRACTORS & SKIDLOADER:** #98 Case IH 9350, 4x4, 310HP, 12 spd, QT, 4 remotes, PTO, 3 pt, 18.4R-46 duals, 3630 hrs #HC 1086 w/DuAl 3600 grapple loader w/7' bucket, reman. eng, 3 pt, PTO, QT, 18.4R-38 tires #Farmall H w/wick #H 560, DuAl Loader w/Bale Spike #66 Ford 600 w/Ford 703 loader 6'6" bucket, 2 remotes, 3 pt, PTO #3 pt, Back Blade, Post Hole Digger, Disc, Sweep Plow, 2-bottom Plow, 6' Rotary Mower, Ford 7' Sickle Mower #Case 1740 Skidloader w/5' back bucket

**COMBINE:** #89 Gleaner R60, 24' platform, 2635 eng hrs, 30.5L-32 tires #24' Pickup Reel

**TRUCKS & PICKUPS:** #78 S2500 IHC Semi, TS, 290 HP, 10 spd, 11R-22.5, wet kit #74 Dodge Custom 600 2T, 318, 4x2, 18' B&H, RO Tarp, 9:00-20 #73 White F70 CO, Tag, CAT diesel, 9 spd, 22' Tradewind B&H, cargo door, RO Tarp, 11R-24.5 #72 Ford Feed Truck, 6 cyl, 4x2, Oswalt 2840 Enslemix Box & scales #94 Dodge Pickup, 3/4T, 4x4, 360 #88 Dodge Ram 150, 4X4, 318

**TRAILERS:** #86 47' Tandem Dual Axle Flatbed w/8' hyd ramp, 10:00R-15 #74 Ada 6'x20' Gooseneck #5'x14' Bumper pull open-top trailer #24' Header #8'x16' 2 wheel Tilt Bed Trailer

**FARM EQUIPMENT:** #98 Crustbuster 3200 TS 41x12 Hoe Drills #KM Model 740 FK 7x6 Blade Plow #68 28' Crustbuster #3 '74 JD 8'x12' LZ Hoe Drills #70 Toolbar w/ditchers #72 Krause 14' Chisel #Alfalfa Drill #JD 14' Rotary Mower #Orthman 20' Toolbar #VanBrunt Disc Drill #JD 400 21' Rotary Hoe

**HAY EQUIPMENT:** #02 Case IH RBX561 Round Baler, mega-wide, net wrap & twine, est 1,000 bales #98 Haybuster H1100 Big Bite Tub Grinder #98 NH 116 Hydro-swing Swather #NH 55 Side Delivery Rack #75 Hesston 30 Stakmover #75 Hesston 30A Stakhande #2) 3 pt Bale Movers

**HAY:** #Round Bales - 105 Corn, 100 Cane, 35 Prairie & 100 Milo

**LIVESTOCK EQUIPMENT:** #Foremost Squeeze Chute w/Palpation Cage & Automatic Head Gate #PR 20' Crowding Alley #Foremost Self-Catching Head Gate #Portable Loading Chute & Windbreak #3) 12'x20' Calf Sheds #Many wood & steel posts #Steel Panels & Gates #5) 12V & 110 Fence Chargers #Concrete Bunks #Veterinary supplies #2) 500 bu Bulk Bins w/augers & ladders #PTO Wire Roller w/10 mi of smooth wire #5) Sioux Mineral Feeders #Bar-6 Model 1200 12V Cattle Feeder #11' & 10' Hastings Stock Tanks #1500 gal Water Tank

**MISC:** '76 8'x50' Speedking PTO Auger #79 23RF Soil Mover #12' Speedmover #AC 20KW Continuous Single Phase 60 HZ PTO Generator on trailer #2) 2,500 gal Fuel Tanks #Propane tanks #shop tools AND MANY MORE ITEMS TOO NUMEROUS TO LIST.

## FARM & RANCH REALTY, INC.

1420 W. 4<sup>th</sup>. - P.O. BOX 947 \*COLBY, KS 67701

785-462-3904 or 1-800-247-7863

DON HAZLETT, BROKER/AUCTIONEER

www.farmandranchrealty.com

"When You List With Farm & Ranch, It's As Good As Sold!"

Instead of Panning the Streams -  
pan the Classifieds for your  
riches!!

785-462-3963



## INTRODUCING A NEW AGENT...

Farm & Ranch Realty, Inc. of Colby is pleased to announce that **RON ERICKSON** has joined our sales staff and will specialize in farm and ranch sales. Ron and his wife Marlene have been long time Rexford area residents. They have 2 children, Brad and Renell, who are both married and live in the area. We are pleased to have Ron working with us and invite you to visit with him about your real estate needs.

Call Ron at 785-687-3841

## FARM & RANCH REALTY, INC.

1420 W. 4<sup>th</sup> # Colby, Kansas 67701

(785) 462-3904

Donald L. Hazlett, Broker

www.farmandranchrealty.com



Ron Erickson

## Wallace Co. Land for Sale

220 Acres in the South Half (S/2) of Section 26-11-38

195.1 acres in CRP, 10 year contract

25 acres in native grass

Stock well in the Northwest Corner, submergible pump, Seller retains and maintains well, approximately two (2) acres where well is. Buyer can use water. It has "guzzler" water for wild life

Seller will plant and maintain cover crop until sold. Seller retains all of annual payments until sold. CRP payment is \$30.33 per acre, 195.1 acres=\$5,917.00 annual payment.

Buyer pays for only 195.1 acres of CRP land \$87,795.00. One-half (1/2) minerals reserved by Seller for 10 years, unless production. Non-participating in lease money.

James D. and Connie S. Harrison, Sellers

John H. Ostmeier, Broker ~ 785-462-8158

Call: J.M. Bloom, Salesman ~ 785-672-3638  
for more information or a tour of land

## • NOTICE •

### AD RATES

For Classified Word ads are as follows:

1-2 days	25¢/word
3-4 days	18¢/word
5-9 days	17¢/word
10-14 days	16¢/word
Monthly (tfn)	15¢/word

\*Price reflects 15 word minimum ad. Ads must be in our office by 12:00 noon the day before. In case of error, call us the FIRST day your ad runs since we will not be responsible for errors after the first day/week.

### COUNTRY ADVOCATE

\$9.45 for the first 15 words & 55¢ each additional word (per week).

Your ad will run 1 time in the Advocate and 1 week in the sister paper of your choice.

ADS MUST BE IN THE OFFICE BY 12:00 NOON ON FRIDAY.

DISPLAY (box) AD DEADLINE FOR FREE PRESS IS 3:00 P.M. TWO DAYS BEFORE

AD RUNS. Display Rate: \$6.75 per column inch. COUNTRY ADVOCATE DEADLINE IS 12:00 NOON ON FRIDAY.

COLBY FREE PRESS 462-3963

WE INVITE YOU TO TALK TO ONE OF OUR REAL ESTATE SPECIALISTS

## FARM & RANCH REALTY, INC.

1420 W. 4<sup>TH</sup>. - P.O. BOX 947

COLBY, KS 67701

785-462-3904

DONALD L. HAZLETT, Broker

VISIT OUR WEB SITE AT [www.farmandranchrealty.com](http://www.farmandranchrealty.com)

"WHEN YOU LIST WITH FARM & RANCH, IT'S AS GOOD AS SOLD!"

### \* OFFER WANTED \*



**580 N. Garfield \$72,000.00**  
Brick 3 Bedroom, 2-bath with full basement & garage.  
Call Molly 462-6700

### \*COTTAGE \*



**665 N. Court \$29,500.00**  
Clean, charming cottage with upgrades. Call Molly 462-6700

### REAL ESTATE

DC - 3,000a cropland & grass 4W & 5S of Oberlin - features irrigation, bottomland, 2,300 acres grassland—could be split

LG - "Twin Buttes" Ranch on Hwy 40 in Western Logan County - 700a grass, 235a cropland & 259a CRP-LIVE WATER!!-NEW LISTING!

LG - 800a grass, CRP & irrigation on the Smoky Hill River W of Russell Springs—NEW LISTING!

TH - 160a cropland 1 mi N of Lg/Th county line on Hwy 25

WA - 1600a irrigated cropland & grass SE of Sharon Springs, 1100a grass, 3 pivots, 155a dryland

GH - 7 1/2a Country Home in scenic setting on the Solomon River near Penokee, KS

TH - 160a cropland, CRP, grass, house & Out buildings South of Menlo

## ADDITIONAL LISTINGS

1121 Summer Sun 785 W. 7th  
1490 Pioneer Dr 665 N. Court  
980 W. 3<sup>rd</sup> 160 N. Court  
585 Austin 840 E. 6<sup>th</sup>  
1265 W. 3rd 335 W. 6<sup>th</sup>  
1000 E. 8th 1805 W. 5th  
1060 Villa Vista 335 S. Grant  
1015 W. 6th 660 S. Grant  
1265 E. 8th 960 E. 9th

\*\*\*Industrial, commercial & residential lots

Molly Oliver  
Rock Bedore  
Ed Currier  
Steve Hazlett  
Ron Evans  
Mike Bailey

### \*UNBELIEVABLE\*



**425 Field \$95,500.00**  
Spacious with walkout basement, 5 Bedrooms, 3-baths & 2-car garage. Call Molly 462-6700

### \*GREAT LOCATION \*



**1805 W. 5<sup>th</sup> \$74,000.00**  
Brick 3 Bedroom, 2-bath with 1-car garage. Call Molly 462-6700

### \*BREWSTER HOME \*



**420 Illinois \$57,500.00**  
Don't be shy!! Brick 3 Bedroom with a 2-car garage. Call Molly 462-6700

### UPCOMING AUCTIONS

02/20/04 - 540a irrigated & dryland located 1 mi S of I-70 at Oakley on Hwy 83 to be offered in 5 tracts

02/23/04 - 320a cropland & grass NE of McDonald

02/25/04 - Farm Machinery Auction for LeeVern Koehn & others, Sharon Springs

02/27/04 - Farm Machinery Auction for Cliff & Shelly Wilson - Oakley, KS

03/02/04 - 1,520 acres Rawlins Co. cropland & grass to be offered in 8 tracts, 7 1/2 mi S of Atwood on Hwy 25

03/27/04 - Annual Spring Consignment Auction

04/02/04 - Kriss Farms Buildings & land in Colby

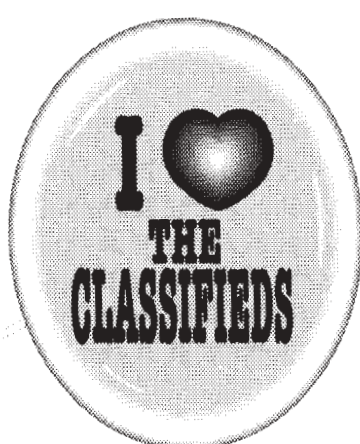

As a teen-ager, you hear  
some pretty goofy  
suggestions.

Let's go skinny-dipping in the Ramada pool. **No!**

And you've got to sort out the fun from the foolish.

How about drag-racing down Fourth Street? **No!**

But sometimes the choices we make just aren't very easy.

Wanna grab a few beers and drive around a while? **Uh...**

Especially when there's pressure from your peers.

Everybody's going! Do you want them to think you're wierd? **No.**

They might challenge your courage or your character.

You're not chicken or a sissy or something, are you? **No.**

And it's hard to make the choice you **KNOW** is right!!

Well - do you wanna go drinking and cruising or what?? **Well...**

Come on....

You can say "NO" to that one, too!!

Don't drink and drive. It may be a tough choice, but it's the right one.

This message brought to you by The Colby Free Press

## Let Experience Lead the Way



Dedicated Resourceful  
Accomplished

Thinking about selling  
your home?

Let Molly J. Oliver get you from "for sale" to SOLD.

Over 20 years of Residential real estate experience in Colby, Kansas

Office: 462-6700

Home: 462-6133

mollyoliver@farmandranchrealty.com

FARM & RANCH REALTY  
Don Hazlett, Broker

## Which comes first?

The home...or the loan?  
Stop by today for a FREE  
loan approval.



Together...Making a Difference

240 W. 4th • Colby • 460-3321

Check out what we have to offer:

- Conventional Loans
- Refinancing
- FHA/VA Loans
- Rural Housing Loans



ELAINE  
KOERPERICH,  
Mortgage  
Loan Officer

MEMBER  
EQUAL HOUSING  
LENDER

Reach over 13,000 homes  
weekly with our  
Colby Free Press/Country  
Advocate combo ads

## 155 N. Range

## STOP paying rent!



Three bedroom, two bath, off street parking, fenced-in yard, perfect starter home.



Located in Southwind Plaza  
2280 Southwind Ave., Colby, KS

785-460-3058

Linda Taylor, Broker

462-3495, evenings

Dick Weston, Salesman



Warren C. Hixson  
Broker

410 N. Franklin

Colby, KS

785-462-8255

MLS



1649 US 24 \$150,000



1850 Harvey \$189,500



1131 Flint \$74,000



875 S. Lincoln \$69,900



935 W. 3rd \$69,500



665 W. 8th \$30,500

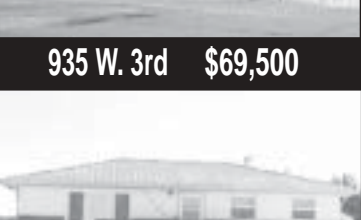

1145 Summer Sun \$73,000



309 Rock Island \$43,500



1315 W 4th \$39,500



220 S. Garfield \$74,900

## Build Here

Dylan Drive

West Fifth Street

East Walnut



180 E. Cherry \$110,000

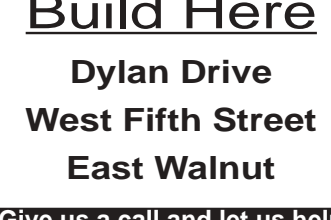

Give us a call and let us help you build your dream home.

Marilyn Kersenbrock • 462-2703 Pat Koch • 462-6119

Pat Sloan • 460-7495 Marj Van Camp • 460-2648

For more information on these listings and to see our other listings, call us or visit our website at:

[www.ColbyHomeLand.com](http://www.ColbyHomeLand.com)