

# Classifieds

## Announcements

**Fresh crop nuts.** Pecan mammoth halves, cashews, mixed nuts \$7.00/pound. Walnuts \$6.00/pound. Episcopal churchwomen or pickup at Colby Canvas Company. 462-2505 for delivery. —11/9—11/14—

**St. Mary's Church** of Herndon, Kansas annual bazaar: Sunday, November 18. Serving turkey & ham dinner (free will offering) from 11:30 a.m.-1:00 p.m. followed by bingo (conducted by St. Mary's parish council) with cash prizes (\$50 grand prize) and games for kids. Everyone welcome. —11/6—11/16—

**Avon Christmas** open house November 9 & 10 from 10:00 a.m. - 6:00 p.m. at the Brewster Community Church. —11/5—11/9—

## Help Wanted

**I need help!** My distributor based business is exploding. Earn \$25-\$75 per hour. Full training. Free information. 1-888-693-3319. —11/9—11/14—

**5,000 head feedlot** in need of experienced feedlot employees. Call 785-626-0319, leave message please. —11/8—11/13—

**Personal assistants** needed in Colby including at least one male. Duties will include meal prep., housekeeping, etc. Part-time positions. Starting pay \$7.50/hour. Call LINK 785-481-2313 for an application. —11/7—11/13—

## VOLUNTEERS NEEDED

High Plains Mental Center is seeking men and women of all ages to become Compeer volunteers. The Compeer Program brings individuals and mental health clients together in a one-to-one friendship.

Volunteers are matched with clients of the same gender who share mutual interests and are available during convenient times. It only takes four hours per month.

Don't miss this opportunity to benefit yourself and someone else -- Compeer if flexible and rewarding!



A Licensed Community Mental Health Center

For more information, contact Ryan Robl at 785-625-2400.

email: kscompeer@hotmail.com

## EQUIPMENT OPERATOR II TRAINEE

Are you looking for a rewarding career that offers full-time, year 'round work? The Kansas Department of Transportation is now hiring an Equipment Operator II Trainee in Colby, KS. Position involves bridge and road maintenance/asphalt production, equipment operation and maintenance, and snow removal. On-the-job training is provided to obtain a CDL within sixty days. Following completion of a six month training period, you will be eligible for a ten percent salary increase. An annual \$250.00 Personal Protection Equipment allowance is available. Health insurance including dental and disability insurance is provided. Other benefits include snow plow and stand-by pay, vacation and sick leave. This position is subject to pre-employment drug testing and require a valid unrestricted driver's license. Starting pay is \$9.47 per hour. **Women and minorities are encouraged to apply.** Send a completed Employment Registration Form (ERF) Dept. of Administration, Division of Personnel Services, Landon State Office Building, Room 951-South, 900 SW Jackson, Topeka, KS 66612-1251 and KS Employment Summary (ES) by 11/13/01to the Kansas Dept. of Transportation, P.O. Box 350, 312 S. Second St., Norton, KS 67654. ERF and ES may be obtained from: <http://da.state.ks.us/ps/aaa/recruitment/default.htm> or any KDOT Office. **Indicate Advertisement No. 34306 on the application form. If you have any questions, call 785-626-3258.**

## COME JOIN OUR TEAM!

Citizens Medical Center and Prairie Senior Living Complex are looking for caring, qualified professionals to join our expanding Healthcare team. We have the following opportunities available:



CITIZENS MEDICAL CENTER

- **Sonographer** - Full-time position
- **Occupational Therapist** - Full-time salaried position.
- **CRT/RRT** - Full-time position.
- **CPTA** - Part-time position.
- **Medical Technologist** - Full-time day position.
- **Phlebotomist** - Temporary full-time position.
- **Admissions Clerk** - Full-time position.



PRAIRIE SENIOR LIVING COMPLEX

- **Administrator** - Full-time salaried position.
- **Environmental Tech-** Temporary Full- Time position

We offer competitive wages and a benefits package that includes health and dental insurance with a portion of the premiums paid. If you want the opportunity for professional growth and the chance to make a difference in the lives of others, please contact: Margaret Kummer, Human Resources, Citizen Medical Center, 100 E. College Dr., Colby, KS 67701, 785-462-4877. EOE

## Help Wanted

**Great Bend is growing** - are you looking for a rewarding and challenging career? Interviews will be going on in Colby Tue. 11/13 and Wed. 11/14. CPI provides third-party pension administration services for clients all over the USA. We now have over 400 employees and are growing every year. All work is done in our corporate offices in Great Bend, Kansas. If you have education or experience in accounting, business administration, or a similar area, strong computer skills, and are a career-oriented person, consider training for a challenging career in pension administration. As a wholly-owned subsidiary of A.G. Edwards, Inc., CPI offers an excellent benefit package, as well as a friendly, family-oriented atmosphere. To set up an interview, call CPI Human Resources at 800-279-9915. Or you can e-mail a resume to HR@cpipqc.com. —11/9—

**Cummins Industrial Tools** crew driver. Work 15 days on 15 days off. Growing retail tool company has immediate opening for energetic people to drive for a traveling sales crew. Duties include work, set up and tear down of the sale. Class A CDL is required. Strong possibilities for promotion to management. Excellent benefits and pay. Please send resume or call for application. Cummins Industrial Tools, Attn: HR, 650 N. Lincoln, Spring Hill, KS 66083, 800-445-0089. —11/5—11/9—

**Four day** work week, route sales and delivery. No CDL required. Call Weber Snacks 462-3180. —11/2—11/9—

**Immediate opening** for CNA in Colby area. Call 785-899-6418, ask for Rita or Julie. —11/2—tfn—

## Help Wanted

**Transitional living specialist** position in Colby area. Responsible for providing independent living skills training to individuals with traumatically acquired brain injuries. Duties will include planning and implementing transitional living plans, teaching independent living skills and advocacy efforts to assist the individuals in reaching independent living goals. Qualifications: HS diploma or GED, BS/BA preferred, experience working with disabilities and knowledge of the independent living philosophy helpful. Personal life experience with a disability preferred. Good benefit package. Send letter of interest and resume to Human Resources, LINK Inc., 2401 E. 13th St., Hays, KS 67601. E.O.E. —11/1—11/14—

## Notices

**Saturday, November 17th** will be the last day for The Mustard Seed at 503 Main St., Atwood. Antiques, gift items, organic products, essential oils, tapestries, and smoothie specials. Open 10:00 a.m. - 5:00 p.m. —11/8—11/12—

**Millennium Homes** of Salina invites you to the premier showing of our new product line from Hart Housing at Wal-Mart in Hays, November, 5th through the 11th. Model homes will be open Monday through Saturday from 9:00 a.m. - 6:00 p.m. and Sunday from 1:00 - 5:00 p.m. —11/8 & 11/9—

## Early Childhood PARA EDUCATOR

The Northwest Kansas Educational Service Center is currently seeking to fill a vacancy for a Full-time Early Childhood Paraeducator in the Goodland area. **Qualifications:** High school diploma or equivalent. Experience in early childhood working with young children. Duties involve assisting the teacher, complete duties in the classroom. For further information, contact Janette Stuart at 785-672-3125, Ext. 138. To receive an application, contact Ann Rath, Personnel Department, NKESC, 703 W. 2nd, Oakley, KS 67748, phone number: 785-672-3125, Ext. 112. **Deadline for applications until position is filled.**

NKESC is an EOE

## Help Wanted

**Personal belongings** in storage unit located at 590 N. Range Ave. will be sold December 1st for past due fees. —11/7—11/9—

**Cash** for dead TV's and VCR's. Also will repair. Free estimates. Call anytime. 785-462-7657. —11/1—11/30—

## Apartments for Rent

**Two bedroom apartment** with garage, stove, refrigerator. No pets. 462-2258. —11/7—11/13—

**Rooms available** at the Blakesley. One at \$215 and one at \$325 per month. Utilities and cable included. Call 462-3251. —8/17—tfn—

**Sunflower Apartments** in Colby can offer affordable apartments. To see if you qualify, stop by 1170 S. Franklin to pick up application or call Lynn Cameron at 462-6349. Equal Housing Opportunity. —10/27—tfn—

## Houses for Rent

**One bedroom.** Call 462-8619 8:00 a.m. - 12:00 p.m./1:00 - 5:00 p.m. or 462-7908 and leave message. —11/7—11/13—

**2 bedroom,** 1000 E. 8th St. \$350 mo/ \$350 deposit. Lease & references required. No pets. Available December 1st. 462-3404. —11/6—tfn—

## House for Sale

**House** located at 590 N. School. Contact Mike Woofter at 462-8653 or 462-5399. —11/2—tfn—

## ATTENTION MEDICAL ASSISTANTS!

**Citizens Medical Center** has a temporary full-time position available for a **Phlebotomist** Other interested candidates are welcome to apply. On the job training offered. If you want the opportunity.... please contact Margaret Kummer, Human Resources, Citizens Medical Center 100 E. College Drive Colby, KS 67701 785-462-4877 EOE

## House for Sale

**By owner:** 2 bedroom, 1 bath, recently remodeled inside and out. Vinyl siding, new windows, detached oversized 1 car garage, fenced yard, nice location. Shown by appointment only. Serious inquiries please call 785-462-9868 or 785-462-0345. Will consider trade option for bigger home. —11/2—11/14—

## Offices for Rent

**Professional office** space available. Approximately 925 sq. ft. Includes several feet of storage space. Call 462-3218, leave message. —10/25—11/28—

## Building for Rent

**55x75 warehouse.** 24 foot door, walk-in door, cement floor, large fenced lot. Call 462-2432 or 462-8169. —11/2—11/9—

## Misc. for Sale

**Restoration & parts vehicles:** 1939 International pickup \$950. 1950 Chevy car \$1,950. 1972 Ford pickup \$125. 1981 Ford Escort \$75. 1979 Buick Regal \$180. 1959 Ford Fairlane \$125. 784-462-6211. —11/7—11/9—

**New Winchester** Model 1300 12 guage pump shotgun. Save \$50. 462-2380. —11/7—11/9—

**Lincoln Wire-matic 255** wire welder. In good shape, aluminum kit included. 785-673-5505 day, 785-673-4732 evening. —11/5—11/12—

**Simmons Beauty-rest** "Revere" king size mattress set. Negotiable. Call 785-462-2039. —11/5—11/12—

### Colby Public Schools

is accepting applications for a bus driver. Position is 3-4 hours per day \$8.00/hr. A district application form may be picked up from Alan Wade at the bus garage, 240 North Copeland, Colby. For additional information call EOE (785)465-5020

## Boat for Sale

**1957 14' fiberglass.** 35 h.p. Johnson, 47 lb. thrust, trolling motor, Hummingbird 8000 fish finder. 785-462-5396. —11/9—11/13—

## Vehicles for Sale

**1986 GMC S-15.** 4x4, excellent shape, 462-5396. —11/9—11/13—

**1987 Ford F150 pickup.** Automatic, new engine, new tires, 77,000 miles, \$3,800. 785-673-4664. —11/8—11/10—

**1979 CJ7 Renegade Jeep.** 350 Chevy engine, automatic transmission, completely restored, 69,000 actual miles, mint condition, \$6,700. 785-673-4664. —11/8—11/10—

**1994 Chevy pickup.** 4 door, 4x4, 1 ton, 6.5 diesel, dual rear wheels, new transmission, 73,000 on new factory engine, \$13,000. 785-672-3655/785-672-0435. —11/8—11/21—

**1992 Jeep Cherokee Laredo.** Great condition, \$5,700. 785-824-3926. —11/7—11/9—

**1956 Thunderbird.** \$16,000 firm. 785-434-2635 after 6:00 p.m. —11/7—11/9—

**1994 Cavalier RS.** 4 door, power windows, power locks, AM-FM, cassette, 88K, asking \$3,450. 785-465-8002. —11/5—11/9—

**1999 Chevy Suburban.** Metallic grey, 2WD, loaded, 57,000 miles, new Michelin tires, \$21,000. 785-421-5442. —10/31—11/9—

## Business Services

**Fall clean-up.** Yards, gardens, tree pruning, cleanouts. Removal of shrubbery, lilacs, geraniums, Chinese yews, flowerbeds, perennials, annuals, roses, vegetable garden cleanup, etc. Rototilling. 785-462-8091. —11/8—11/12—

## To Give Away

**Used console TV,** works. 462-6606. —11/9—

**Farm cats.** All colors, sizes. Call 785-586-2384 evenings. —11/7—11/9—

# The Business Directory

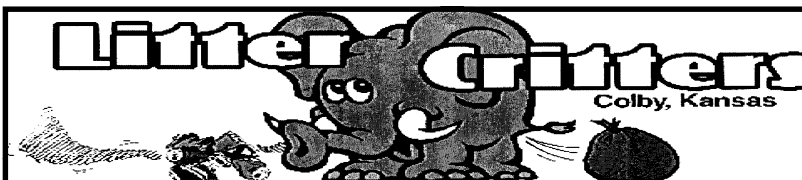

**Alan & Kelly Focke**  
Mobile: (785)4433481 • Phone: (785)462-8399

Parking Lot Sweeping \* Line Stripping \* Steam Cleaning  
Concrete joint sealing \* Exterior painting & Staining  
25% Discount to senior Citizens \* Gutter & Down Spout Cleaning



**GERSTNER-CERSOVSKY**  
**INSURANCE AGENCY**

*"Customer Service is Our Policy"*

**CINDY L. CERSOVSKY**  
Cersovsky Insurance Inc.  
370 N. Franklin • PO Box 310 • Colby, KS 67701  
Ph: 785-462-7544 Toll Free: 888-462-7544





**Michelle L. Foote**  
Financial Advisor

Are you going to pay Uncle Sam a little extra this year, or are you going to open an IRA with us?  
*Come see me today!*

Securities offered exclusively through  
**RAYMOND JAMES**  
FINANCIAL SERVICES, INC.  
AN INDEPENDENT BROKER/DEALER

• NOT FDIC insured  
• NOT GUARANTEED BY Farmers & Merchants Bank  
• Subject to risk and may lose value  
OSJ 816-753-7859

Phone: 785-462-3321  
Toll-Free: 877-462-3321  
240 W. 4th • Colby, KS



**nwkansas.com**

Get connected to the Internet with us!  
We have local technical support.

**Get connected today!**  
**Call 462-3963**





**NEW SYSTEM**  
**Professional WINDOW CLEANING**  
Colby, Kansas

COMMERCIAL-RESIDENTIAL-FREE ESTIMATES  
Serving NW Kansas & Eastern Colorado  
**785-462-6995 or 1-800-611-6735**  
**Chris & Beth Lewon**  
*"We do windows"*



**BANKWEST**  
OF KANSAS



**SUNWEST**  
BANKS OF COLORADO  
A BRANCH OF BANKWEST OF KANSAS

Introducing our new **Feeder Finance Program**  
**5.95% FIXED RATE** on qualified feeder cattle purchases.

And new Variable Rates as low as  
**5.92% Ag Real Estate Financing**  
**6.42% Ag Equipment Financing**  
Low Fixed Rates also available. Certain Terms and Conditions apply.  
BANKLINE: 1-888-828-2265

**COLBY • GOODLAND • ST. FRANCIS • IDALIA, CO**



**ROUND TRIP TRAVEL** 140 W. 4th • Colby 462-6999 • 1-888-690-7077

**BRANSON CHRISTMAS TRIP**  
December 2-7 Call for brochure.

**VACATION SPECIALS**

	From (per adult)	No. of nights	
LAS VEGAS - Air & hotel	\$200	4	<b>WORLDWIDE:</b> Vacation Packages, Cruises, Tours, Groups, Flights, Hotels, Trains, Cars
DISNEY WORLD - Hotel, air, park passes	\$450	3	
MEXICO - Air & hotel	\$450	3	
CARIBBEAN CRUISE & AIR	\$1,050	5	
ALASKAN CRUISE & AIR	\$1,500	7	
HAWAII - Air & hotel	\$740	3	
LONDON, ENGLAND - Air & hotel	\$700	3	
AMTRAK EXPLORE AMERICA	\$359	Max. 45	
ALL SPECIALS MAY BE FOR SPECIFIC DATES AND ARE SUBJECT TO AVAILABILITY.			
CALL IN OR FAX YOUR INTERNET QUOTES AND OTHER ADS! WE CAN BOOK THEM FOR YOU WITH LOCAL, CARING SERVICE!!!			

Ask about AAA, AARP Senior & Companion, Corporate and Government discounts!

20/20 vision isn't the only reason to see your eye doctor



MS



DIABETES



GLAUCOMA



CATARACTS



HIGH BLOOD PRESSURE

1 2 3 4 5

**Drs. Morrison & Wahlmeier**

James F. Morrison, OD, FAAO  
Jeffrey B. Morrison, OD  
Mark F. Wahlmeier, OD

180 W. 6th, Colby 462-8231

Ask us about same day glasses Hours: 8 am-5 pm (M-F)  
Authorized Oakley RX Dealer Saturdays by appt.



## Real Estate

## Real Estate

## Real Estate

## Real Estate

## Legal Notice

## Wanted



515 Austin \$74,500.00  
4 BR, 2 Baths, 1 Car Grg. CALL MOLLY  
GREAT LOCATION!!!



345 S. Garfield \$65,000.00  
3 BR, 2 Baths, 1 Car Grg. CALL MOLLY  
NEW ON MARKET!!!



1135 Summer Sun \$54,000.00  
2 BR, 1 Baths, 1 Car Grg. CALL STEVE  
JUST WAITING FOR YOU!!!

## YOUR HOME'S SPOT!!

We have sold many of our home listings. **THINKING ABOUT SELLING? CALL MOLLY & put your home in this ad.**



202 Kansas \$69,500.00  
3 BR, 2 Baths, 1 Car Grg. CALL MOLLY  
FABULOUS HOME IN BREWSTER!



665 N. Grant \$57,000.00  
4 BR, 2 Baths, 1 Car Grg. CALL MOLLY  
SELLER SAYS - "SELL!!!"



NE/4 17-9-31 \$27,000.00  
4.5 acres SE of Colby w/electricity & water. CALL MOLLY!!!



940 E. 6<sup>th</sup> \$108,000.00  
4 BR, 3 Baths, 1 Car Grg. CALL MOLLY  
GORGEOUS - MODEL PERFECT!!



1203 Court Place \$87,500.00  
3 BR, 2 Baths, 2 Car Grg. CALL MOLLY  
FANASTIC FAMILY HOME!!!

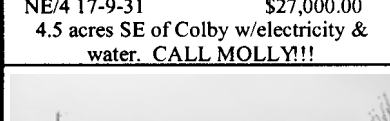

210 Main \$94,000.00  
4 BR, 3 Baths, 2 Car Grg. CALL MOLLY  
NEWER HOME IN LEVANT!!!

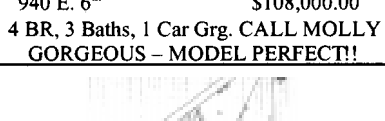

Pioneer Subdivision \$7,500.00  
Super Price on a residential bldg lot.  
CALL MOLLY

## BUSINESS OR INVESTMENT OPPORTUNITY

900 E 4th  
Stop 2 Shop \$450,000.00

1125 S. Franklin  
Pirates Den \$165,000.00

950 S. Range  
Sonic Property \$90,000.00

440 S. Court Avenue  
Sandstone Apts. \$350,000.00

Thielen Avenue  
Lester Building \$44,500.00



W. of 375 E. Cherry \$12,500.00  
GREAT LOCATION TO BUILD ON!  
CALL DON!!

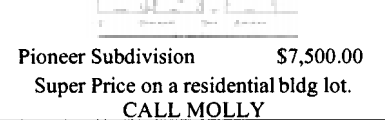

Country Homes:  
GH- 80a cropland, grassland & improvements NW of Morland  
LG- 320a cropland w/nice homestead which can be purchased separately on an 8ac tract S of Monument  
SD- 17a cropland & grass w/house & buildings on West edge of Studley

**Upcoming Auctions:**  
11/17/01 - ANNUAL FALL CONSIGNMENT AUCTION—SEE AD IN THE AUCTION SECTION  
12/4/01 - HANNAH FLAGLER ESTATE - 320a of cropland w/oil production N of Brewster in Sherman Co.  
12/12/01 - GREESON FLUID HAULERS - Trucks, Trailers, Tanks, Oilfield equipment & supplies, sale to be held at Horace Wakeeney  
**Land Listings:**  
SH-480a cropland near Edson, KS--BUY 1 OR ALL 3!  
TH-300+ac cropland & grassland S of Levant, KS on the blacktop  
GH-1,920a consisting of 1,000a cropland, 390a CRP & 530a grassland w/grain storage, modern home, BEAUTIFUL setting 15 mi N of Wakeeney  
LG-480a grassland w/2 windmills & live water S of Monument  
WA- 640a of dryland 5 mi N of Sharon Springs  
WA-640a CRP 7 mi N of Sharon Springs  
TH-2 Sections, irrigated & dryland cropland NE of Gem, can be split  
TH-160a sprinkler irr in SE Thomas County, KS  
TH-181a sprinkler irr & dryland in SE Thomas County  
LG-640a CRP & cropland in Western Logan County, KS  
LG-160a cropland & small tract of grass w/windmill S of Page City

Rock Bedore \* Molly Oliver \* Ed Currier  
Mike Bailey \* Steve Hazlett \* Ron Evans

## FARM & RANCH REALTY, INC.

1420 W. 4<sup>TH</sup>. - P.O. BOX 947  
COLBY, KS 67701  
785-462-3904 or 1-800-247-7863

**DONALD L. HAZLETT**  
BROKER

"WHEN YOU LIST WITH FARM & RANCH, IT'S AS GOOD AS SOLD!"

VISIT OUR WEB SITE AT  
www.farmandranchrealty.com

## For Home Purchases or Refinancing CALL ME 1st!!!

ROBERT DIBLE

HL Financial Services



140 W. 4th • Colby, KS  
785-462-3359  
1-800-658-4697  
American Home Loans  
Conventional • VA • FHA  
NO APPLICATION FEES

7845 W. Hwy. 50



Holcomb, KS 67851

## PREMIER HOMES

### HIGH HEATING BILLS??

Premier Homes offers the most energy efficient homes possible. We have new 16x80's from \$239 per month, WAC. Don't buy a repo or used home when you can buy a new home for less!

2002 28x48 for only \$39,000! Payments \$281 per month, 7% for 30 yr. WAC. We also do land/home packages from 5.5%!

**REAL ESTATE:**  
Custom built Cape Cod homes from \$33 per sq. ft.; Ranches from \$49 per sq. ft.

620-277-0707  
www.premierhomesinc.net

IN THE DISTRICT COURT  
OF THOMAS COUNTY, KANSAS  
In the Matter of the Estate of  
Beulah D. Flanagin, Deceased.  
Case No. 01-P-37

## NOTICE OF HEARING AND NOTICE TO CREDITORS

The State of Kansas To All Persons Concerned:

You are hereby notified that on November 5, 2001, a Petition was filed in this Court by Verda J. Smith, executor named in the Last Will and Testament of Beulah D. Flanagin, deceased, dated October 4, 1991, praying that the Will filed with the Petition be admitted to probate and record, that she be appointed as Executor without bond, and that she be granted Letters Testamentary.

You are required to file your written defenses thereto on or before December 3, 2001, at 10:00 AM of such day, in this Court, in the City of Colby in Thomas County, Kansas, at which time and place the cause will be heard. Should you fail, judgment and decree will be entered in due course upon the Petition.

All creditors are notified to exhibit their demands against the estate within four months from the date of first publication of this Notice, as provided by law, and if their demands are not thus exhibited, they shall be forever barred.

VERDA J. SMITH,  
PETITIONER

Submitted by:  
H. David Starkey, #8686  
Starkey & Gatz, L.L.P.  
P.O. Box 346  
Colby, Kansas 67701  
785-462-3383  
Attorney for Petitioner

(Published in The Colby Free Press on November 9, 16, and 23, 2001)

Reach over 13,000  
homes weekly with our  
Colby Free Press/Country  
Advocate combo ads

# Open House



1435 W. 3rd  
3 bedroom home with main floor laundry, formal living room, and a family room with fireplace.

Come and see!

Sunday, November 11<sup>th</sup>  
2:00 to 4:00 p.m.

**HomeLand**  
REAL ESTATE

Marj VanCamp  
410 N. Franklin

Colby, KS

462-7495  
(785) 462-8255

29 people wanted to get paid \$\$\$ to lose up to 30 lbs. in the next 30 days. Natural and guaranteed. 1-888-693-3318.  
—11/9—11/14—

**Alfalfa hay,** cane hay, and dry corn. Competitive bids. Please call Scott Foote at 785-386-4519.  
—2/1—tfn—

## Pets / Supplies

**Miniature Dachshunds.** Dapples, ready 11/20/01, \$150 - \$250. 785-672-3655.  
—11/8—11/21—

## Lost and Found

**Found:** by B-Hive in Colby - black Lab/mix male dog with red/blue fleas collar. Call 462-6081.  
—11/9—11/13—

## You'll like the way we do business!

Our bank is built on integrity, strength, and a genuine commitment to your mortgage needs.



ELAINE KOERPERICH,  
Mortgage  
Loan Officer

EQUAL HOUSING LENDER MEMBER FDIC



**BANK OF COLBY**  
Together...Making a Difference  
240 W. 4th • Colby • 462-3321

- Conventional Loans
- Refinancing
- FHA/VA Loans
- Rural Housing Loans

## NOVEMBER 15 is National Recycle Day



Renew, Recycle, Reuse

## Heartland Rural Counseling Services, Inc.

270 N. Franklin, Suite C • Colby, KS  
785-462-7588

Specializing in family issues - play therapy, marital therapy, depression, anxiety, stress, trauma, anger management, ADHD, abuse, divorce, and grief.

## South Park Apartments Meadowlark Manor

- Rent based on income -

785-462-6763

EQUAL HOUSING OPPORTUNITY

# America's Best-Kept Hearing Secret:

You may not have heard of us, but millions of Americans hear better *because* of us.



Dan Stevens  
Board Certified Hearing  
Instrument Specialist

## Introducing Audibel.

As part of America's largest hearing instrument company, we offer the widest variety of custom digital and analog hearing instruments. And with our consumer-friendly trial periods and money back guarantee assuring your 100% satisfaction, there's never been a better time to stop missing out on your life's important sounds and conversations.

**CALL TODAY FOR YOUR FREE NO-OBLIGATION CONSULTATION IN YOUR HOME OR IN OUR OFFICE.**

## STEVENS HEARING CENTER

1218 East B Street P.O. Box 806  
McCook, NE 69001

Tel: (308)345-4836 • Toll free: (800) 371-4836

WE WILL SERVICE ALL MAKES AND MODELS OF HEARING INSTRUMENTS

## • NOTICE •

### AD RATES

For Classified Word ads are as follows:

1-2 days 25¢/word  
3-4 days 18¢/word  
5-9 days 17¢/word  
10-14 days 16¢/word  
Monthly (tfn) 15¢/word

(\*Price reflects 15 word minimum ad. Ads must be in our office by 12:00 noon the day before. In case of error, call us the FIRST day your ad runs since we will not be responsible for errors after the first day/week.

## COUNTRY ADVOCATE

\$6.00/per week - 10 words  
(additional 25¢ word thereafter)  
13¢/word pick-up rate (with 3 consecutive day run in Free Press)

ADS MUST BE IN THE OFFICE BY 12:00 NOON ON FRIDAY.

DISPLAY (box) AD DEADLINE FOR FREE PRESS IS 3:00 P.M. TWO DAYS BEFORE

AD RUNS. Display Rate: \$6.85 per column inch. COUNTRY ADVOCATE

DEADLINE IS 12:00 NOON ON FRIDAY.

**COLBY FREE PRESS**  
462-3963

## HOMES HOMES HOMES HOMES

## SPECTACULAR VIEW!



You deserve the finest! This 4 BR/3 bath home has many amenities. Call PAT today!

## GREAT LOCATION



4 BR, 2 bath ranch with full basement + 1-car attached garage. Great location. Call PAT KOCH.

## Family Friendly



Live enjoyably in this 4 BR, 2 bath ranch home w/a handy dine-in kitchen. Call PAT KOCH.

## NEW Family Wanted



4 BRs, family room with fireplace + main floor laundry. Call PAT SLOAN.

## NEW A Great Starter



Charming 2 BR, ranchette with family room. Low \$50's. Give PAT SLOAN a call.

## NEW Comfort & Value



3 BR brick ranch in a great neighborhood. Priced to sell! Call PAT SLOAN today!

## DON'T RENT...OWN!



2 BR cottage located close to downtown and priced in the \$30's. Call MARILYN.

## LOWERED PRICE!!



Over 1,400 sq. ft., 4 BR ranch located on 2 acres. Call MARILYN.

## Tucked Away!



Call MARILYN to see this 4 BR brick ranch w/2-car garage. Great location - great price!

## Welcome Friends



Spacious 5 BR, 3 bath brick home w/family rooms & rec room. Call MARJ for a tour today!

## ONE-OF-A-KIND



Designer-home with great privacy in a 10+ area. Call MARJ today!

## Brick Ranch



3 BR, 1 1/2 bath, one level ranch home. All appliances included. Call MARJ.

## MAKE AN APPOINTMENT TO SEE ANY OF OUR CURRENT LISTINGS:

920 Court Terrace  
615 Cherokee  
12 Plymouth Drive  
575 W. 6th  
455 N. Franklin  
315 W. 6th, Gem  
915 E. 5th

20 Plymouth Drive  
1145 E. 8th  
685 Webster  
185 S. Franklin  
1896 County Rd. 15  
940 E. 9th  
1040 E. 8th

670 E. 6th  
1133 CR R, Levant  
785 Lane  
160 E. 4th  
735 Sunset

1815 W. 5th  
1105 Flint  
917 Court Terrace  
1011 Court Terrace  
530 S. Lincoln

## COLBY

Warren C. Hixson - Broker

785-462-6818

Pat Koch • 462-6119

Pat Sloan • 462-7495

Marilyn Kersenbrock • 462-2703

B.J. Melvin • 462-2483

Marj Van Camp • 462-2648

## HomeLand REAL ESTATE

website: ColbyHomeland.com

410 N. Franklin • Colby, KS

785-462-8255

homelandre@aol.com

114 W. 12th • Goodland, KS

785-899-3060

homelandg@aol.com

## GOODLAND

Tom Harrison - Branch Broker

785-852-4200

Rosanne Anderson • 899-7464

Ken Christiansen • 694-2644

Mitch Hixson • 899-9270

Suzanne Garrison • 899-6899

OAKLEY

Jerry Wycoff • 672-3763