

Family Celebrating 30 years



The children of Jerry and Debbi Foss would like to announce their parents' 30th wedding anniversary on April 17. The couple was married in Colby on April 17, 1971.

Friends may send cards to their home at 1330 N. Brookside in Colby.

90-year-old lady celebrated her birthday

Ada Rogge, lifelong resident of Russell Springs, recently celebrated her 90th birthday with parties in both Colby and Russell Springs. It was a joyous celebration shared with many family members and friends. Some of those attending from out-of-town were Don and Verena Rogge, Littleton, Colo.; Bill and Dorothy Rogge, Libby, Mont.; Myra and Chuck Wilson, Norman, Okla.; Nevada Farris, Houston, Texas; Gordon Cook, Oklahoma City; Maggie Wilson and daughter Emily, Littleton, Colo.; Anna Kelly, Scott City; Emil and Olive Rogge, Eileen Straach, Pat and Bill Graham, Mr. and Mrs. Mark Graham and children, all of Fowler, Colo. The best wishes of Ada's hometown friends made the occasion very special with much appreciation to Dean and Joye Rogge.

Contributed by Nevada Farris.

Judy Parsons, Page City, is doing well. **Ed Horinek** remains in Citizens Medical Center in Colby. It was learned Monday afternoon that **Wyatt Werth**, along with his other injuries, now has a broken right arm. A specialist checked him on Tuesday and put it in a cast. Hang in there, Wyatt – it has to get better.

Welcome moisture has been received.. The comment is "Would sure be nice to see the sun." We have had a lot of fog also.

There was no Tuesday dinner as it was election day and we voted in the Chamber Building. Bargella quilt is over half done.

Winona and Russell Springs area received a bad storm on Friday afternoon, April 6. Had very strong winds, 1.20 inches of rain and marble size hail. So spring is definitely here.

April 7-8 weekend guests of **Darlene Stramel in Page City** were Carolyn and Nolan Theobald of Santa Rosa, Calif.

Death

Alma G. (Cutshaw) Marietta
Alma G. (Cutshaw) Marietta, 96, died Saturday, April 14, 2001, at Lantern Park Manor, Colby.

She was an area resident since 1969, and a retired restaurant employee; member of the Brewster Methodist Church, Brewster United Methodist Women and past member of Rebekahs. Her husband John E. Marietta died Sept. 21, 1986.

Survivors include sons Don of Bella Vista, Calif., and Lyle of Borger, Texas; and daughters Ethel Whisenhunt, Firth, Neb., Deanna Scott, Stinnett, Texas, and Marcia Schwaegler, Spokane, Wash; 15 grandchildren; 29 great-grandchildren; and 10 great-great-grandchildren.

Funeral services will be at 10 a.m. Tuesday at Harrison Chapel, Colby, Pastor Dorine Chambers officiating. Burial will be in Brewster Cemetery, Brewster. Visitation will be from 9 a.m.-9 p.m. today. Memorial donations may be made to Lantern Park Manor and may be left at any Colby bank or Harrison Chapel.

Club News

COLBY COUNTRY CLUB
Bridge winners April 10 were: Marge Roulier, 1st; Helen Donelan, 2nd; Jean Snyder, 3rd.

ROTARY
April 10 Rotary meeting was presided by President Nancy LePell. Visiting Rotarian guest was Mack Teasley from Abeline. President Nancy thanked Abilene Henry for volunteering to chair the highway pickup on Saturday, April 28.

May 1 is the deadline for cruise raffle tickets. Remember the money goes for the Rotary Hunger Plus Program.

Les Brown then introduced Mack Teasley who recently went to Panama with the Hunger Plus Program. He is the Assistant Director of the Eisenhower Library in Abeline. He has been honored as Rotary District Governor Nominee for the year 2002-2003.

Mr. Teasley brought slides to show his trip to Panama and how the Hunger Plus Program works. On this trip

there were 20 Rotarians plus their spouses.

They took a bus and traveled to the different cities to distribute the 20 pound packages of food. These packages contained rice, lentils, cooking oils, and sardines. They fed 7,000 people in one week. Mack Teasley told of the great feeling of being involved with such a service group as Rotary.

In Panama the Rotary groups have helped communities with hospitals, fire stations, libraries, and housing for orphans. They also have programs to teach individuals to raise chickens and small gardens to grow food.

Markets

Quotes as of close of previous business day Hi-Plains Co-op	
Wheat	\$2.82
Corn	\$1.97
Milo	\$3.21
Soybeans	\$3.82

The **Winona United Methodist Women** met Wednesday, April 4, in Dunlap Hall. There were nine present. The lesson and hostess was by **Norma Washburn**.

Jim and Kathy Koons, St. James, Mo., arrived at **Bob and Virginia Arnbergers** on Monday evening, April 2. They will visit family and plan to return home on Saturday.

Weekend visitors of **Roger and Marge Ausmus and Larry and Michele Werth and sons** were Gene and Melissa Haffner and sons, Kearney, Neb.; Dorothy Peitz, Garden City; Richard and Laura Ausmus, Rick, Rod, Wes and Jamie, Colorado Springs, Colo.

Terry Bussen, Oakley, was a weekend guest of **Rosalie Bussen**. On Saturday evening, they motored to Colby and attended the United States Army Field Band and soldiers Chorus concert. They are the Musical Ambassadors of the Army in Washington, D.C. It was an outstanding concert. On Sunday morning, Rosalie and Terry traveled to Hays where they were joined by Kenny and Celia Nicolet, Katie and Darren and Cameron Nichols of Great Bend. They had lunch at Applebees and then visited the Sternberg Museum and saw the famous 'Sue.' It was very interesting. Enroute home they visited Wayne and Brenda Fleener in Hays and Edith Wigington in Quinter.

Rosalie Bussen
• Winona Correspondent

Sunday lunch guests of **LaVonne Baxter** were Karen Montemayer and Linda of Garden City, LaNeta Sheppard, Levant, Amber Dirks, Sidney and Jarred, Goodland; **Greg Baxter**, Winona. They all attended the Easter Cantata in the United Methodist Church. LaVonne was in the choir.

Weekend houseguest of **Florence Horinek, Page City**, on the 7th and 8th were Mr. and Mrs. Stan Horning and Megan of Gaylord; Abe Horning, Hays; Jayme Horning, Manhattan. Saturday, they joined family members and friends in Monument for the 25th wedding anniversary celebration for Bob and Shelly Brock. On Sunday, they visited Ed Horinek in the hospital in Colby.

Circle Mary Ruth met on Wednesday the 11th in the United Methodist Church of Winona. There were nine present. Roll call was a parable from the Bible. **Wanda Summers** gave the lesson about Easter and also served refreshments of homemade ice cream and cake.

Hospital

CITIZENS MEDICAL CENTER
Friday, April 13, 2001
Admissions

Lore Depe, Brewster
Kathleen Fringer, Colby
Dismissals

Jonathan Christopher, Los Angeles, Calif.

Marie Eberly, Colby
Edward Horinek, Winona
Eva Keck, Colby
Aloysius Kleinsorge, Sharon Springs

Saturday, April 14, 2001
Admissions

Anna Riedel, Colby
Dismissals
Milton Goldsworth, Colby
Montra Jones, Colby
Loretta Mazanec, Colby

Sunday, April 15, 2001
Admissions

Frankie Winston, Colby
Dismissals
Anna Riedel, Colby
Kathleen Fringer, Colby
Juanita Dawes, Colby

Happenings

SHARE delivery will be Saturday, April 21, at 9 a.m. at Sacred Heart School gym. The menu for the month is hamburgers, sausage links, chicken breasts, ham steak, deli meat, potatoes, lettuce, cucumber, baby carrots, apples, oranges, pears, elbow macaroni and cheese. Please note **sign-up time** is early for May - April 30 to Mary 4 at State Farm Insurance. A Share is \$16.50 and two hours of volunteer service. **For information call Gene Griffin, 462-3579 or Anna Fyfe, 462-3733.**

Community Calendar

WEDNESDAY, APRIL 18

Genesis Thomas County pickup, 350 S. Range, 10 a.m.-noon & 1-4 p.m.
Peek 'n Read, Pioneer Memorial Library, 9:45 a.m.
Preschool Fun, Pioneer Memorial Library, 10:30 a.m.
Colby Lions, Student Union, noon
RSVP Recognition Banquet, American Legion, Registration, 4 p.m.; Awards/banquet, 5 p.m.; dance, 7-9 p.m.
TeleFriend Information meeting, 5:30 p.m. (call 462-6996)
Gem Lions, Gem Community Building, 7 p.m. (2nd & 4th Wednesdays)
The Herd, Junior High Youth Group, Armory, 7-8:30 p.m.
Pinochle, American Legion, 7:30 p.m.
Tobacco Quitters Support Group, CMC Cafeteria, 7-8 p.m.
Sixth Street Alcoholics Anonymous & AlAnon, 1275 West 6th, 8:30 p.m.

"MULTI-PARCEL" REAL ESTATE AUCTION

ABSOLUTE
ABSOLUTE
ABSOLUTE

**800 ACRES
THOMAS
COUNTY
CROPLAND**

SELLERS: MEDFORD FARMS, INC.

TUESDAY, APRIL 17, 2001 @1:30 PM, DST

AUCTION LOCATION: COMFORT INN CONFERENCE ROOM IN COLBY, KS- JUST SOUTH OF I-70

LEGAL DESCRIPTIONS:

TRACT 1: NE/4 of 9-9-36, Thomas County, Kansas
TRACT 2: W/2 of 21-9-36, Thomas County, Kansas
TRACT 3: S/2 of 3-10-36, Thomas County, Kansas

LOCATION: 8 Miles South of Brewster, Kansas

MANNER OF SALE: This real estate will be offered as a "MULTI-PARCEL" auction in individual tracts and in combinations of tracts. It will be sold in the manner that produces the highest aggregate bid. There will be OPEN BIDDING on all tracts and combinations of tracts during the auction as determined by the auctioneer. Bids on tracts, tract combinations and the total property may compete. Auction procedure and increments of bidding are at the discretion of the Auctioneer.

TERMS: 10% down day of sale with balance upon approval of title, on or before May 17, 2001. Personal and corporate checks are acceptable for the down payment with the final payment to be in certified funds. Bidding is not contingent upon financing. Financing, if necessary, needs to be arranged and approved prior to the auction. Announcements made day of sale take precedence over printed material.

ACCEPTANCE OF BIDS: Each successful bidder will be required to enter into a Farm & Ranch Contract to Buy and Sell Real Estate immediately following the auction. Copies of these contracts will be available from the auctioneer prior to the sale.

EVIDENCE OF TITLE: Sellers will provide title insurance to the Buyer(s) in the amount of the purchase price, with the premium to be paid one-half by the Sellers and one-half by the Buyer(s). Title evidence will be provided on sale day. Buyer(s) may close as soon as closing documents are prepared – no later than May 17, 2001.

ACREAGES: Acreage figures are considered to be approximate and are from reliable, sources, based on (USDA) FSA figures. All FSA information is subject to change. FSA acres may not be the same as deeded acres.

INSPECTIONS: Each potential bidder is responsible for conducting their own independent inspections and due diligence concerning pertinent facts about the property. Neither Sellers nor Farm & Ranch Realty, Inc. are making any warranties about the property, either expressed or implied.

EASEMENTS: This sale is subject to all rights-of-way and easements, whether recorded or not, and to any oil and gas leases of record.

POSSESSION & CROPS: Possession shall be day of closing. Buyer(s) shall receive all of the 2001 growing wheat crop.

CROP INSURANCE: All of the Seller's crop insurance will be transferred to the Buyer(s) with Buyer(s) to pay the premiums when due and payable.

REAL ESTATE TAXES: Sellers shall pay all 2000 & prior years' taxes. 2001 taxes shall be paid by the Buyer(s).

MINERAL RIGHTS: The mineral rights are believed to be intact and shall go with the land.

FSA PAYMENTS: Buyer(s) shall receive all of the 2001 FSA-PFC contract payments.

AGENCY: Farm & Ranch Realty, Inc. and its representatives are the Exclusive Agents of the Sellers.

ESCROW: Northwest Title Co., Inc. of Colby, KS, will serve as escrow agent and closing agent for these transactions. There will be a closing fee of \$250.00 per transaction payable to Northwest Title Co., Inc. which shall be paid one-half by the Sellers and one-half by the Buyer(s).

VISIT OUR WEBSITE @ www.farmandranchrealty.com
OR E-MAIL to buyland@farmandranchrealty.com

FSA CROPLAND ACRES, BASES/YIELDS AND TAXES:

	Cropland Acres	Wheat Base/Yield	Grain Sorg Base/Yield	Barley Base/Yield	2000 Taxes
TRACT 1	154.5 (All in Milo Stalks)	78.9/38	11.2/46		\$370.05
TRACT 2	315.6 (154.0 acres of growing wheat, balance in wheat stubble)	161.6/38	22.8/46	11.0/38	\$740.73
TRACT 3	322.0 (All in Milo Stalks)	164.9/38	23.2/46		\$731.73

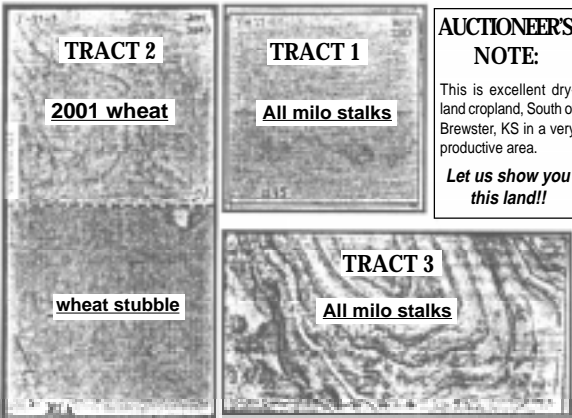
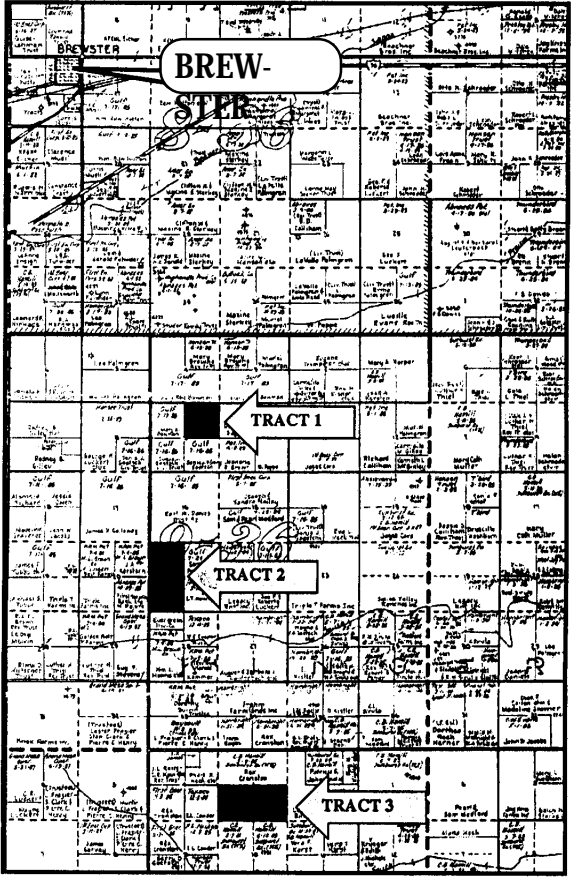

FARM & RANCH REALTY, INC.

ROCK L. BEDORE, LISTING AGENT
Telephone 785-462-3904
P.O. Box 947 • 1420 W. 4th
Colby, KS 67701 • Toll Free 800-247-7863
DONALD L. HAZLETT, BROKER
"When You List With Farm & Ranch, It's As Good As Sold!"

Alltell Win Life Back 100% GDN