

**FOR RENT**

**Two 2 bedroom, 1 bath** mobile homes for rent or sale and one 2 bedroom, 1 bath underground apartment, all utilities paid, high end remodel, in Colby, 785-462-5861.  
- C 8/24-8/31 -

**Murray Equipment Leasing, LLC** in Colby is now offering construction equipment for rent. Some items include a 38 ft. skytrack forklift, and an 85 ft. boom truck. If interested please call 785-443-1339 or 785-462-6908.  
- C 8/1-TFN -

**Houses & Apartments.** Cole Real Estate in Goodland 785-899-2683.  
-G tfn -

**For Rent**-Bieber Cottages in Norton, independent apartment for seniors, 2 bedrooms, 1 bath, handicap accessible, all appliances furnished. Garage emergency response system, water and gas paid. Pet friendly. Contact: Nancy McGinnis, Andbe Home, 785-877-2601.  
- N tfn -

**FARM SERVICES/EQUIPMENT**

**New Holland Hay Equipment** - TV-145 Tractor, Hyd. and 3 pt. on both ends, 450 hrs. - HS16 Swather head for TV-145 Tractor. 82LB loader, 8 ft. bucket, grapple. - Other hay equipment. Call 785-443-3456 or 785-460-0359.  
- C 8/31 -

**Wanted Corn or Milo to Harvest.** Call 785-623-1381.  
- N 9/21 -

**Looking for fall crops to harvest.** Have 2 late model John Deere combines and all supporting equipment. Derek Sumner. 785-871-0962.  
- N 10/26 -

**Disc Rolling**-Rolling on the farm. Call Ron Lewis, Eustis, NE. 308-486-3501.  
-N tfn -

**VEHICLES/RECREATION**

**1989 Kenworth T-600** with

sleeper. 1998 42 foot Merritt Grain Trailer. Call (719) 343-0086.  
G 8/24-8/31

**1975 GMC Sierra 2500**, 4-speed manual, 454ci, lock out hubs, new tires, less than 500 miles on motor, \$4,500 OBO. 1997 F-250 Ext. Cab, longbox, 4x4, Powerstroke, automatic, 166,500 miles, \$10,500 OBO. (719) 342-1500.  
G 8/3-9/3

**2001 Ford Windstar Van**, 104K miles, seats 7, loaded, burgundy, excellent condition, \$3,700.00. Del Lee, 877-3046.  
- N 8/31 -

**2005 F-350 Harley Davidson** Edition Super Duty Turbo V8 4x4. 82,000 miles, all leather interior, fully loaded, 4 door with 8' bed. \$25,000. Call Terry (785) 821-4614. Goodland, KS. 820 W. 14th St..  
G 12/15-TFN

**PASTURE WANTED**

**Pasture wanted** for 25 to 150 cow/calf pairs for 2012 and beyond. Lee Hardy, Edmond, KS. 785-871-0832.  
- N tfn -

**SEED WHEAT**

**For sale: Certified Fuller** and Certified NEO 1643 (over land) seed wheat. Jimmy Stewart, Hoxie, KS 785-675-1045.  
- C 8/31-9/14 -

**Certified Fuller Wheat.** Also T-158, T-136, T-129, and T81-SV. Carl Wahlmeier, 785-678-2476 or cell 785-678-7126.  
- N 10/26 -

**Seed Wheat for Sale**-KCIA Certified Seed Wheat - AGRIPRO TAM 111, POST ROCK and newly released SY GOLD, also FULLER. Paul Nauer, 785-678-2339 or cell 785-678-8083.  
- N tfn -

**Triticale seed**, cleaned, bulk quantities. Steve Brown 785-475-3718.  
O 8/31-9/6-

**For Sale Certified TAM** 111, TAM 112, Winterhawk,

Hatcher, Fuller Armour, SY Gold. May Family Farms 785-475-3369 or cell 785-475-7065.

**FOR SALE**

**Sofa, excellent condition.** Suitable for apartment. (785) 821-2052 or (785) 899-2762.

**For sale Holland Legacy** Grill with tank \$250. Call 785-626-5054 leave message.

**Schwinn "Exerciser" exercise bike.** Great condition. Own a vintage Schwinn. Call (785) 772-1168.

**Yamaha trumpet.** Great condition! Perfect for band students. (785) 890-2597.  
G 8/31-8/31

**Rototiller, Shop Vac, Chest Freezer, Rocker Recliner, Computer Desk, Dresser/Chest, Patio Furniture, Buell Saddlebag, Rear Seat Luggage Bag, 2010 Electra Glide, All excellent condition, make offer 785-443-3799.**  
- C 8/24-8/31 -

**Round alfalfa bales**, \$150/ton, excellent quality, 2nd and 3rd cuttings. Call Craig at 785-332-3523.

**Tires and rims.** Tires are P225/60R16 and about six months old. Rims are black and red Focal Racing Rims, also about 6 months old. Would like \$650. Call (785) 899-7178 or (719) 930-9031 and ask for JP.

**Two Sega Genesis** game stations with 25 plus games. \$100 OBO. (785) 890-7224 or (785) 728-7083.  
G 8/3-tfn

**Need heat for the winter?** Give me a call. Firewood for sale. \$125 a cord. (785) 890-7224 or (785) 728-7083.  
G 8/36-tfn

**For Sale - 46" Riding Mower**, 20 hp., Good tires. \$400/OBO. 785-202-2023.  
- N tfn -

**Rubber stamps**, custom made, The Country Advocate, 1205 Main. Goodland, Kansas. (785) 899-2338.

New Kenmore 8,000 BTU air-conditioner. Still in box. 785-475-2010.

**PETS**

**For sale** seven month old registered male Rat Terrier. Steve Kastens, 785-626-3837.

**3 Kittens up for adoption** at Doggone Critters Pet Grooming. Stop to see at 497 N. Franklin or call 785-462-6388.

**AUCTION SERVICE**

**McEwen Auction** - Duane - Darlene. 601 East Holme, Norton, Kansas 67654, Phone 785-877-3032. Experienced in all types of Auctions. Computer clerking and settlement. Real Estate Salesperson and Listing Agent for Metcalf Real Estate

**KANSAS CLASSIFIEDS**

**Adoption**

**ADOPT:** Loving, secure family years for 1st baby to cherish. Expenses paid. Rose, 1-888-449-0803

**Adoption**

**PREGNANT?** Considering Adoption? Call us First! Living expenses, housing, medical and continued support afterwards. Choose adoptive family of your choice. Call 24/7. AdoptConnect. 1-866-743-9212

**Career Opportunity**

**AIRLINES ARE HIRING** - Train for high paying Aviation Career. FAA approved program. Financial aid if qualified - Job placement assistance. CALL Aviation Institute of Maintenance. 888-248-7449.

**Career Opportunity**

**ALLIED HEALTH** career training - Attend college 100% online. Job placement assistance. Computer available. Financial Aid if qualified. SCHEV certified. Call 800-481-9409 www.CenturaOnline.com

**Career Opportunity**

**ATTEND COLLEGE ONLINE**

from Home. \*Medical \*Business \*Paralegal, \*Accounting, \*Criminal Justice. Job placement assistance. Computer available. Financial Aid if qualified. Call 888-220-3977 www.CenturaOnline.com

**For Sale**

**FINAL WEEK!** Don't miss out on the hottest piano deals in 25 years! Every piano (acoustic & digital) is on sale! Mid-America Piano 1-800-950-3774 www.piano4u.com

**Help Wanted**

**ATTN Flatbed Drivers!** Prime's extensive freight network offers ample miles & earning potential. Stable, strong, growing company needs you! **CALL TODAY!** 1-800-277-0212 or www.primeinc.com

**Help Wanted**

**KanEquip, Inc.** Open Positions include service managers (Dodge City, KS and Wamego, KS locations) and experienced technicians. Competitive salary & excellent benefits. www.kanequip.com or 785-456-2083 ext. 193



Colby • McDonald  
Hoxie • Goodland  
Oakley • Garden City

**6 Month Certificate of Deposit**  
**Interest Rate: 1.25%**  
**Annual Percentage Rate: 1.25%**

Stop in and see our friendly staff today! While you are in, be sure to ask about our checking and savings accounts. We also offer debit cards and internet banking and, coming soon, eStatements and Bill Pay. We are glad to help with all of your banking needs.

\*\*Minimum deposit of \$25,000 required to open account. Instrument is non-renewable. A penalty may be incurred for early withdrawal. Yield is effective as of date of publication and is subject to change without notice.

**FREE CONCERT**



THE UNITED STATES  
**NAVY BAND**  
WASHINGTON, D.C.



**Saturday, Sept. 10, 2011**  
**7:30 p.m. MT**  
**Max Jones Fieldhouse**

Free concert tickets available for pick-up at The Goodland Star-News, 1205 Main, Goodland, or by sending Self-Addressed Stamped envelope to COUNTRY CURRENT, 1205 Main, Goodland, KS 67735.



Sponsored by The Goodland Star-News and Goodland School District

**WILSON LAKE LOTS FOR SALE**

*Come by & Experience your Oasis at the Lake!*  
Presenting...

**VOLENTE POINT "LAKESIDE" Grand Opening**

- A unique new 77 acre "LAKESIDE" subdivision, Wilson Lake
- For those who want and can afford the best
- Fabulous, one of a kind, estate sized, large acreage lots
- Superb, panoramic lake views from every lot
- Protective deed restrictions and covenants
- All underground utilities, Post Rock Water, Wilson Telephone, Internet, Cable, and Rolling Hills Electric
- Only 10 lots available, to preserve privacy, and the fabulous high ground views for each lot owner
- Main rock entries to mark this special place off Highway 232
- Wilson Lake's first and only security gated community for enhanced privacy & security. Keypad & telephone entry systems, keychain remotes for lot owners, emergency fire, police, & ambulance entry systems.
- For prices and availability, call or go to our website; sold lots will be marked on website & on each lot sign

Some of the few remaining "upscale" lakeside properties available at Wilson Lake

**GRAND OPENING SPECIAL PRICES!**

**VOLENTE POINT LAKESIDE**

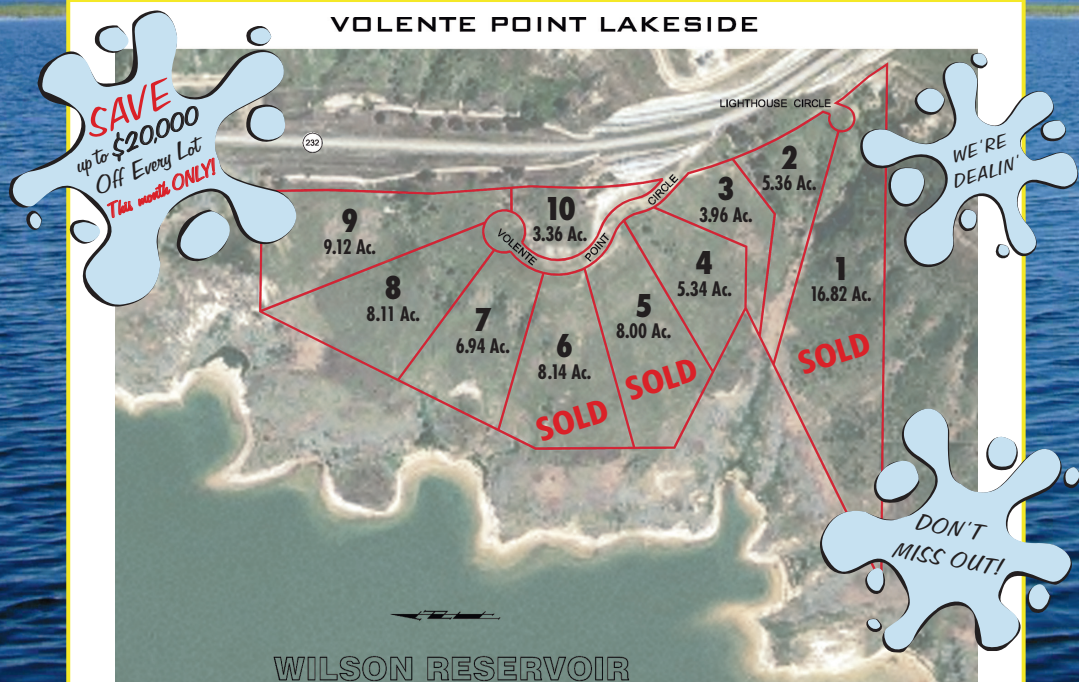

**SAVE**  
up to \$20,000  
Off Every Lot  
This month ONLY!

**WE'RE DEALIN'**

**DON'T MISS OUT!**