

HELP WANTED

Days Inn - Colby needs housekeepers immediately. Apply in person at 1925 S. Range Ave.

Wanted - Experienced Truck Driver Good Pay, Benefits, Decent Home Time. Jack 785-675-8375 or Jim 785-675-2196.

Director of Enrollment Management: Northwest Tech is seeking a professional individual to serve as the Director of Enrollment Management. An individual with great communication skills, with experience in recruiting and financial aid required. Bilingual preferred. Women and minorities strongly encouraged to apply. Position open until filled. Please submit resume to: Dr. Guy E. Mills, President, PO Box 668, Goodland, KS 67735. E.O.E. NWKTC does not discriminate on the basis of race, color, national origin, religion, age, disability, or sex. Accusations concerning sexual discrimination, sexual harassment, and age discrimination should be referred to the TITLE IX COORDINATOR/AGE ACT COORDINATOR, Vice President of Student Affairs at 785-890-3641. Accusations based on disability or race, color, or national origin should be referred to SECTION 504 COORDINATOR/ADA COORDINATOR/TITLE VI COORDINATOR, College Counselor, located at 1209 Harrison (785-890-3641).

Individual wanted to do office work, sheet metal fabrication, unloading freight and other various duties. Call (785) 890-2914 for an application.

Helena Chemical Company has an immediate opening for an APPLICATOR at our Goodland, KS Retail location.

Harrison (785-890-3641). **Campus Housing & Fitness Center Supervisor:** Northwest Tech is seeking a responsible, reliable individual to serve as the campus housing and fitness center supervisor. Bilingual preferred. Women and minorities strongly encouraged to apply. Please complete an employment application and submit to: Dr. Guy E. Mills, President, PO Box 668, Goodland, KS 67735. Position open until filled. E.O.E. NWKTC does not discriminate on the basis of race, color, national origin, religion, age, disability, or sex. Accusations concerning sexual discrimination, sexual harassment, and age discrimination should be referred to the TITLE IX COORDINATOR/AGE ACT COORDINATOR, Vice President of Student Affairs at 785-890-3641. Accusations based on disability or race, color, or national origin should be referred to SECTION 504 COORDINATOR/ADA COORDINATOR/TITLE VI COORDINATOR, College Counselor, located at 1209 Harrison (785-890-3641).

Requires High school diploma or GED and experience operating large equipment; CDL; ability to read field maps; basic knowledge of Ag pesticides and weed identification; mechanically inclined; performing maintenance on other equipment; maintaining accurate log books on applied acres; and be able to mix fertilizer and chemicals. We offer an outstanding compensation and benefits package. For consideration, please fax or mail resume to: Helena Chemical Company Goodland Retail, 2220 Road 64, Goodland, KS 67735. (785) 899-7140 (phone), (785) 899-7051 (Fax).

Cook/chef-at least 5 years experience-full service kitchen-full menu-able to place company orders. Contact Tim at Sugar Hills Golf Club in Goodland at 785-899-2785 or stop in to pick up application.

Cheyenne County will be accepting applications for an equipment operator. A CDL and drug testing is required. EOE. Apply at the county engineers office. 212

E. Washington, St. Francis, KS., 67756, or call 785-332-8840, by January 27th.

Manager for Cottonwood Home Care Agency. RN Degree required. Some Home Health experience preferred. Decatur Health Systems, Oberlin. Apply in person or online www.decaturhealthsystems.org 785-475-2208 EOE

Wanted - Experienced Truck Driver Good Pay, Benefits, Decent Home Time. Jack 785-675-8375 or Jim 785-675-2196.

Looking for hardworking and dependable individual to do detail and light shop work. Benefit package available. Apply in person at Truck Town, 105 W. Horton Ave. Colby, KS 67701.

Full-time farm/ranch hand needed in Oakley area. 785-672-3730 or 785-672-7198.

THE DECATUR COUNTY FSA (Farm Service Agency) is

accepting applications for a permanent full-time Program Technician. Salary range: Grade 4 (\$27,990) to Grade 7 (\$50,431) depending on education and experience, retirement, health, life, annual and sick leave. See full vacancy announcements for mandatory application and qualification requirements at <http://www.usajobs.gov>

Search (What): Farm Service Agency; (Where): Kansas. Applications must be received by 4:30 p.m. CT, January 14, 2011, at the Decatur County FSA Office, 410 S. Buffalo, PO Box 147, Oberlin KS 67749; phone (785) 475-3131. FSA is an Equal Employment Opportunity Employer.

- O 1/5-1/12 -

LAND FOR SALE

Kit Carson County Colorado
NEW: 160± acres CRP. 15 miles North of Seibert. \$110,000
Burlington, Colorado
6 Lots 17th & Rose \$145,000
4 Lots 17th & Rose \$60,000

Sherman County Kansas
40 acres with home, shop & other buildings. S. of Ruleton \$130,000
Prowers County Colorado
480± acres CRP. From Carlton 12 miles South. \$288,000
Lincoln County Colorado
3729± acres grass. 25 miles south of Punkin Center. \$1,062,765

Dale Stull, Broker
Cell 719-349-5710
Toll Free 866-346-5710
www.thelandoffcellc.com

The Land Office LLC

800 ACRES LOGAN CO, KS CROPLAND LAND ABSOLUTE AUCTION

Fri, Feb. 4, 2011 @10:30 AM, CST

AUCTION LOCATION:

Community Room in Courthouse basement, Oakley KS

SELLER: Estate of Marlin D. Leonard

Land will sell in 2 individual tracts

LEGAL DESCRIPTIONS:

TRACT 1: All of Section 1-13-34

TRACT 2: NW/4 of 20-13-32 - All in wheat w/landlord's 1/3rd share going to the Buyer.

Located in area of NEW oil production! Minerals are 100% intact and go to the Buyer!

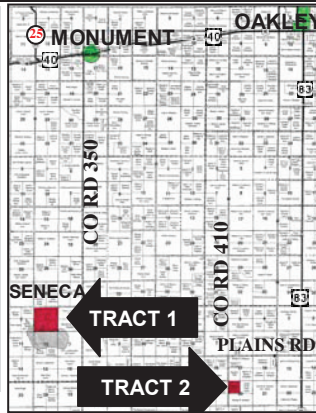

INTERNET BIDDING AVAILABLE!

For a Virtual Tour visit www.farmandranchrealty.com

FARM & RANCH REALTY, INC.

1420 W. 4TH • COLBY, KS 67701

Call Toll Free 1-800-247-7863

DONALD L. HAZLETT, Broker/Auctioneer

"When you list with Farm & Ranch, it's as good as SOLD!"

WOOFER PUMP & WELL INC.

1024 Oak Ave.
Hoxie, KS 67740

Office Phone 785/ 675-3991 Fax: 785/ 675-3990
Shop Phone 785/ 675-3023 E-mail: woofpw@ruraltel.net

Now offering heat pump systems!

- Lower Your Monthly Utility Bills
- Certified Installation
- Call For Information Today

- Irrigation Pump Repair
- Irrigation Well Drilling
- Domestic Well Drilling & Repair
- Environmental Drilling

For all your irrigation needs call:

Doug Holzmeister 785/675-8508

Heath Paxson 785/675-8503



* SOFFIT * DOOR AND WINDOW REPLACEMENTS *
REMODELS *
From concrete to roofing and everything in between.
Ron Lucke
CUSTOM BUILDING
Burlington, Co. (719) 346-8840
CELL PHONE (719) 349-8840
SIDING * SEAMLESS RAIN GUTTERS * FASCIA *
NEW CONSTRUCTION

GREAT SELECTION OF NEW & USED VEHICLES IN STOCK

 2009 CHEVY SILVERADO HD2500 CREWCAB, Z71, 4X4, DURAMAX 7908A \$38,950	 2007 FORD F250 CREWCAB, XLT-FX4, 4X4, POWERSTROKE DIESEL 7984A \$31,900	 2010 GMC TERRAIN SLT AWD, DVD-SUNROOF 7973A \$30,900	 2008 CHEVY SILVERADO 1500 CREWCAB, 4X4 7922A \$29,950	 2008 CHEVY SILVERADO HD 2500 X-CAB 7864A \$23,900	 2004 FORD F250 CREWCAB, LARIAT-FX4, 4X4, POWERSTROKE DIESEL 7982A \$20,900
 2006 CHRYSLER 300C HEMI, SUNROOF 7978A \$17,950	 2005 CHEVY SUBURBAN 4X4 7980A \$16,995	 2007 JEEP GRAND CHEROKEE LAREDO 4X4 7633A \$16,950	 2007 FORD F150 SUPERCAB, LARIAT, 4X4 7758A \$16,900	 2005 CHEVY TAHOE Z71 7820B \$15,500	 2005 CHEVY COLORADO X-CAB 1049A \$13,500
 2000 TOYOTA TUNDRA X-CAB, SR5, 4X4 7872A \$13,250	 2001 LINCOLN LS SPORT 7971A \$9,950	 2001 CHEVY SILVERADO 1500 X-CAB, 4X4 7869B \$9,900	 2004 DODGE RAM 2500 HEMI 7970B \$9,500	 2000 CHEVY SILVERADO 4X4 7970C \$8,995	 2000 GMC YUKON DENALI 4X4 7956B \$8,900
 2001 FORD RANGER SUPERCAB, XLT, 4X4 1045A \$7,250	 2002 FORD F150 SUPERCAB 7972A \$6,500	 2002 CHEVY IMPALA 7756B \$5,950	 1999 GMC SUBURBAN SLT, 4X4 7890B \$5,500	 1995 CHEVY 1500 7935A \$4,750	 1999 OLDSMOBILE SILHOUETTE GL 7856C \$4,500
 2000 CHRYSLER 300M 7900C \$3,995	 1995 FORD F150 XLT 7813D \$3,950	 1999 BUICK REGAL 7963B \$2,995	 1998 CHEVY 1/2 TON 7894A \$2,750	 1985 CHEVY SUBURBAN 2500 4X4 \$2,500	 1996 BUICK LESABRE CUSTOM 7885B \$2,250

OPEN ALL DAY SATURDAY

CHECK OUT OUR GREAT INVENTORY SELECTION
www.harchelroadmotors.com

HARCHELROAD MOTORS INC.
WAUNETA, NE
308-394-5555 • Toll Free 1-877-86-CHEVY
www.harchelroadmotors.com

GREAT SELECTION OF OVER 210 NEW & USED VEHICLES!

GREAT SELECTION OF OVER 60 NEW & USED KRAUSE, SUNFLOWER, KINZE TILLAGE EQUIPMENT