

# Band shell work in Sawhill Park has finally begun

By Amanda Miller  
amiller@nwkansascity.com

The band shell in Sawhill Park is receiving some much needed renovations. After years of work to get funding for the project, the sound of jack hammers was heard throughout the city last week. Bringing the amphitheater back to life will help preserve and promote a unique treasure in the community.

The band shell was built during hard times in the 1930's. During the Depression, dust storms and crop failures shaped the lives in Cheyenne County. The hard times meant an absence of luxury or frills.

The St. Francis City Council arranged for workmen and federal funds to help build a park on an empty lot on Main Street. One of the men to volunteer to help was Howard T. Sawhill.

The need for a place of beauty and refuge was great during this time, and the workmen and volunteers worked with enthusiasm and dedication to finish the project.

Years ago, on summer evenings, people would go to Sawhill Park and enjoy the conversation, entertainment and fresh air. The operating fountain had colored lights and was lovely at night. The flowers were fragrant, and children rolled on the lawn in the amphitheater circle. The huge tree that the amphitheater was built around gave a canopy for shade for a good portion of the audience seated.

Today, the hope is that people will return to the park as they did years ago.

The city council, in 2005, received a donation from Garnett

Miller that was to be used on the band shell. Mrs. Miller was a close friend of the Sawhill family, and wanted to see the band shell restored. She donated \$52,657. Once the donation was received, it set in motion plans to restore the historic artifact.

After two attempts, the city was given a grant from the Kansas Historical Society. In 2012, a grant for \$70,268 was accepted for the first phase of restoration of the band shell.

The city plans to restore the band shell in three phases. The first phase is the exterior restoration. This will include a new stage floor, roof, lighting trough, and they will also open the windows in the green room that have been cinder blocked and plastered closed for many years.

The city will try to get another grant to work on the second phase, the interior of the building. Finally, the third stage would be to restore the art work that is inside the building.

The Pishny Restoration Services has been working on the first phase of the restoration the past couple weeks. Pishny is a historic restoration company from Lenexa.

Once the exterior restoration is completed, the band shell will be available to rent. The rental fee is waived for non-profit organizations. But even those wishing to put on a show can rent the band shell now for \$75.

Our hope is that the band shell will be used more, said Glori Milne, city clerk.

Anyone interested in renting the band shell can call the city office at 332-3142.

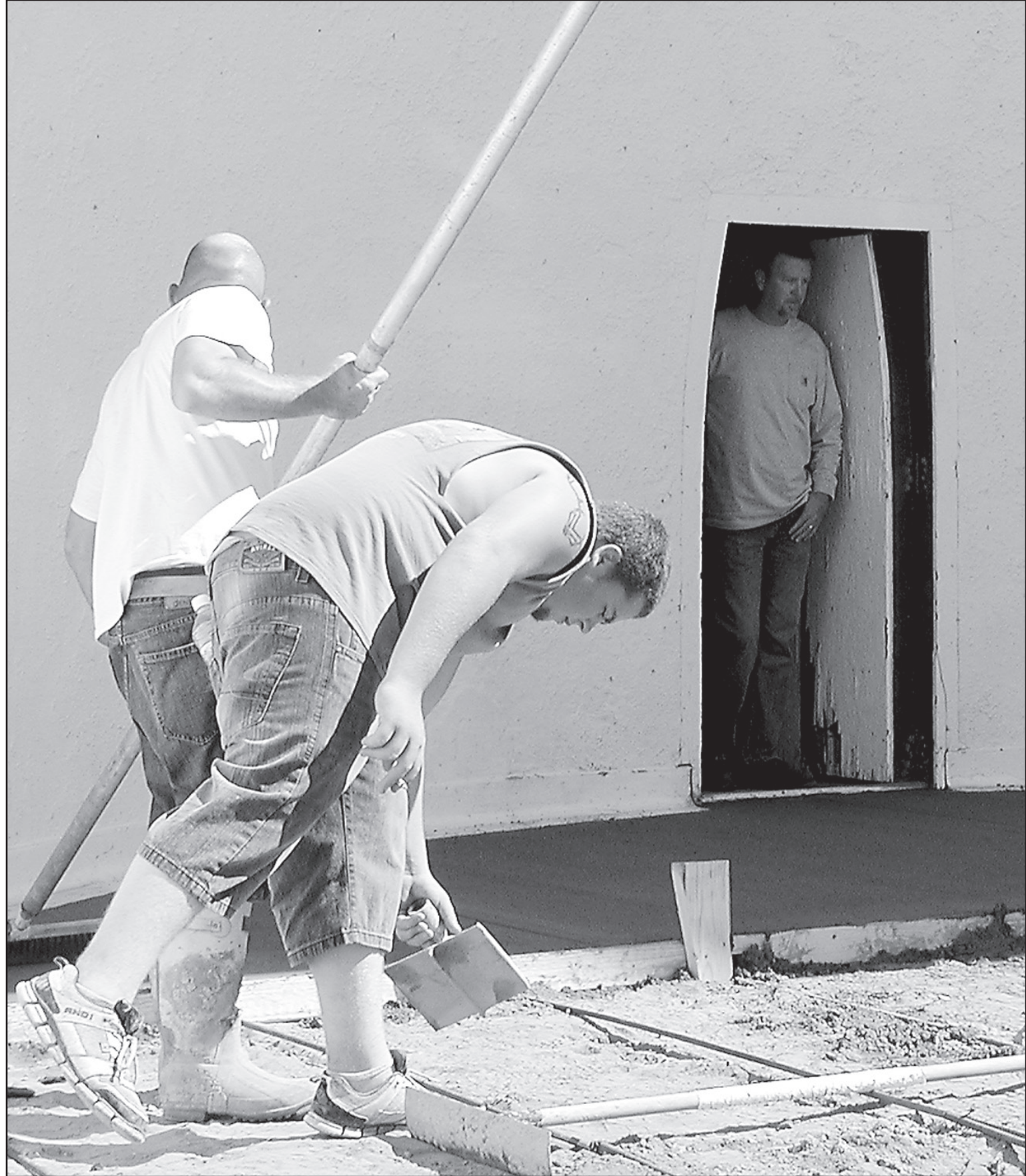

WORKERS FROM PHISNY RESTORATION SERVICES begin to resurface the band shell stage in Sawhill Park.

Herald photo by Amanda Miller

## Book Reviews

### Zero Day

By David Baldacci

John Puller is a combat veteran and the best military investigator in the U.S. Army's Criminal Investigative Division. His father was an Army fighting legend, and his brother is serving a life sentence for treason in a federal military prison. Puller has an indomitable spirit and an unstoppable drive to find the truth.

Now Puller is called out on a case in a remote, rural area in West Virginia coal country far from any military outpost.

Someone has stumbled onto a brutal crime scene, a family slaughtered. The local homicide detective, a headstrong woman with personal demons of her own, joins forces with Puller in the investigation. As Puller digs through deception after deception, he realizes that absolutely nothing he's seen in this small town, and no one in it, is what it seems. Facing a potential conspiracy that reaches far beyond the hills of West Virginia, he is one man on the hunt for justice against an overwhelming force.

### Bonnie

By Iris Johansen

When Eve Duncan gave birth to her daughter, she experienced a love she never knew existed. Nothing would stand in the way of giving Bonnie a wonderful life — until the unthinkable happened and the 7-year-old vanished into thin air. Eve found herself in the throes of a nightmare from which there was no escape.

But a new Eve emerged: a woman who would use her

remarkable talent as a forensic sculptor to help others find closure in the face of tragedy. Now with the help of her beloved Joe Quinn and CIA agent Catherine Ling, Eve has come closer than ever to the truth. But the deeper she digs, the more she realizes that Bonnie's father is a key player in solving this monstrous puzzle. And that Bonnie's disappearance was not as random as everyone had always believed.

## Annual Meeting

Monday, Oct. 21, 10 a.m. Robbins Center  
Fort Hays State University



Sign up for E-billing by Dec. 10 and you're registered to win 1 of 3 \$100 Visa check cards or a new iPad Mini  
Call (800) 222-3121 to sign up!



Midwest Energy, Inc.

Midwest Energy • www.mwenergy.com • 1330 Canterbury Dr., Hays

## VICTOR & CLARA MEYER ESTATE DRYLAND AUCTION W/RESERVE

Thursday, October 17, 2013 at 1:30 pm, MT  
Elks Lodge - Goodland, KS

### 750.7 +/- Ac • DRY FARMLAND SHERMAN COUNTY, KS

750.7 +/- AC to be offered in 3 parcels and 1 combo; L/L share of fall planted crops to Purchaser; Possession of land with crop upon harvest.

**PARCEL #1:** 319.3 +/- ac Dryland; E1/2 of 36, T9S, R38S; From Edson, KS, 7 mi S on CR 29 to CR 57, 1 1/2 mi E on CR 57 to NW corner of property.

**PARCEL #2A:** 293.4 +/- ac Dryland; W1/2 of 22, T8S, R38S; Adjacent to Edson, KS; CR 28 borders W property line, CR 64 borders S property line.

**PARCEL #2B:** 138 +/- ac Dryland; SE1/4 of 21, T8S, R38S; From Edson, 1/2 mi west; CR 28 borders E property line, CR 64 borders S property line.

**Combo #2:** Parcels #2A & #2B.



RECK AGRI  
REALTY & AUCTION

For Further Information:

Marc Reck, Broker or Troy Vogel, Salesperson  
For a Color Brochure, Visual Tour & Online Bidding:  
visit: www.reckagri.com

970-522-7770 or 1-800-748-2589

### Statement of Ownership, Management, and Circulation

1. Publication Title: The Saint Francis Herald  
2. Publication Number: 475-968  
3. Filing Date: 10/01/2013  
4. Issue Frequency: weekly  
5. Number of Issues Published Annually: 52  
6. Annual Subscription Price: 38

7. Complete Mailing Address of Known Office of Publication (Not printer) (Street, city, county, state, and ZIP+4®):  
The Saint Francis Herald  
PO BOX 1050  
SAINT FRANCIS KS 67756 / CHEYENNE  
8. Complete Mailing Address of Headquarters or General Business Office of Publisher (Not printer):  
THE SAINT FRANCIS HERALD  
PO BOX 1050  
SAINT FRANCIS KS 67756

9. Full Names and Complete Mailing Addresses of Publisher, Editor, and Managing Editor (Do not leave blank):  
Publisher (Name and complete mailing address):  
KAREN KRIEN  
PO BOX 1050  
SAINT FRANCIS KS 67756  
Editor (Name and complete mailing address):  
KAREN KRIEN  
PO BOX 1050  
SAINT FRANCIS KS 67756  
Managing Editor (Name and complete mailing address):

10. Owner (Do not leave blank. If the publication is owned by a corporation, give the name and address of the corporation immediately followed by the names and addresses of all stockholders owning or holding 1 percent or more of the total amount of stock. If not owned by a corporation, give the names and addresses of the individual owners. If owned by a partnership or other unincorporated firm, give its name and address as well as those of each individual owner. If the publication is published by a nonprofit organization, give its name and address.)  
Full Name: Complete Mailing Address  
HAYNES PUBLISHING, STEPHEN AND CYNTHIA HAYNES  
170 S PENN  
OBERLIN KS 67749

11. Known Bondholders, Mortgagees, and Other Security Holders Owning or Holding 1 Percent or More of Total Amount of Bonds, Mortgages, or Other Securities. If none, check box  None  
Full Name: Complete Mailing Address  
THE BANK OF NORTHWEST KANSAS  
PO BOX 405  
COLBY KS 67701

12. Tax Status (For completion by nonprofit organizations authorized to mail at nonprofit rates) (Check one)  
 The purpose, function, and nonprofit status of this organization and the exempt status for federal income tax purposes:  
 Has Not Changed During Preceding 12 Months  
 Has Changed During Preceding 12 Months (Publisher must submit explanation of change with this statement)

PS Form 3526, August 2012 (Page 1 of 3 (Instructions Page 3)) PSN: 7530-01-000-9931 PRIVACY NOTICE: See our privacy policy on www.usps.com

13. Publication Title: The Saint Francis Herald  
14. Issue Date for Circulation Data Below: 09/26/2013

15. Extent and Nature of Circulation: AVERAGE NO. COPIES EACH ISSUE DURING PRECEDING 12 MONTHS

GENERAL, MOSTLY IN AND NEAR CHEYENNE COUNTY		Average No. Copies Each Issue During Preceding 12 Months	No. Copies of Single Issue Published Nearest to Filing Date
a. Total Number of Copies (Net press run)		1575	1575
b. Paid Circulation (By Mail and Outside the Mail)	(1) Mailed Outside-County Paid Subscriptions Stated on PS Form 3541 (include paid distribution above nominal rate, advertiser's proof copies, and exchange copies)	522	519
	(2) Mailed In-County Paid Subscriptions Stated on PS Form 3541 (include paid distribution above nominal rate, advertiser's proof copies, and exchange copies)	537	556
	(3) Paid Distribution Outside the Mail Including Sales Through Dealers and Carriers, Street Vendors, Counter Sales, and Other Paid Distribution Outside USPS®	135	127
	(4) Paid Distribution by Other Classes of Mail Through the USPS (e.g., First-Class Mail®)	0	0
c. Total Paid Distribution (Sum of 15d (1), (2), (3), and (4))		1194	1196
d. Free or Nominal Rate Distribution (By Mail and Outside the Mail)	(1) Free or Nominal Rate Outside-County Copies included on PS Form 3541	2	2
	(2) Free or Nominal Rate In-County Copies included on PS Form 3541	1	1
	(3) Free or Nominal Rate Copies Mailed at Other Classes Through the USPS (e.g., First-Class Mail)	0	0
	(4) Free or Nominal Rate Distribution Outside the Mail (Carriers or other means)	0	0
e. Total Free or Nominal Rate Distribution (Sum of 15d (1), (2), (3), and (4))		3	3
f. Total Distribution (Sum of 15c and 15e)		1197	1199
g. Copies not Distributed (See Instructions to Publishers #4 (page #3))		378	376
h. Total (Sum of 15f and g)		1575	1575
i. Percent Paid (15c divided by 15f times 100)		99.75	99.75

16.  Total circulation includes electronic copies. Report circulation on PS Form 3526-X worksheet.

PS FORM 3526 WORKSHEET  
If you are using PS Form 3526 and claiming electronic copies complete below:

a. Paid Electronic Copies	▶	
b. Total Paid Print Copies (Line 15c) + Paid Electronic Copies	▶	
c. Total Print Distribution (Line 15f) + Paid Electronic Copies	▶	
d. Percent Paid (Both Print & Electronic Copies)	▶	

I certify that 80% of all my distributed copies (Electronic & Print) are paid above a nominal price.

17. Publication of Statement of Ownership  
 If the publication is a general publication, publication of this statement is required. Will be printed in the 10/01/2013 issue of this publication.  Publication not required.

18. Signature and Title of Editor, Publisher, Business Manager, or Owner  
Sheila R. Smith, Circulation Manager 10-1-13

I certify that all information furnished on this form is true and complete. I understand that anyone who furnishes false or misleading information on this form or who omits material or information requested on the form may be subject to criminal sanctions (including fines and imprisonment) and/or civil sanctions (including civil penalties).

PS Form 3526, August 2012 (Page 2 of 3)

## 960+/- ACRES CROPLAND, GRASS & CRP "MULTI-PARCEL" ABSOLUTE LAND AUCTION SHERMAN COUNTY, KS

SELLER: ESTATE OF MERLE STASSER  
Tues, Oct. 15, 2013 @ 10:30 AM, MDT

### AUCTION LOCATION:

Community Hall at the Firehouse, Goodland, KS

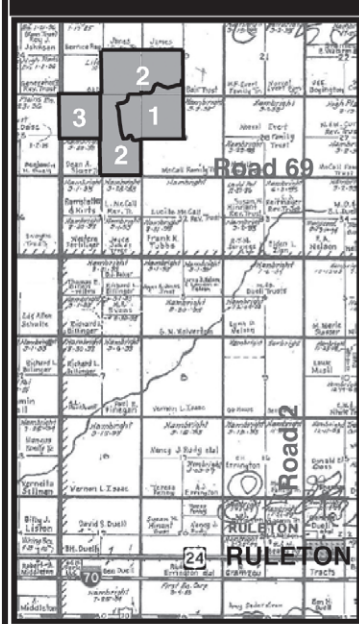

Land will be sold in 3 tracts and combinations of tracts:

### LEGAL DESCRIPTIONS:

**TRACT 1:** NW/4 of 29-7-41; Tract of 23.9± ac cropland in SW/4 of 20-7-41; and all cropland ac in E/2 of 30-7-41

- 151.3 ac cropland
- 52.8± ac grass
- 64.2 ac CRP

**TRACT 2:** SE/4 of 19-7-41; grass acres in E/2 of 30-7-41 and SW/4 of 20-7-41; and Tract of 48.4± ac cropland in SW/4 of 20-7-41

- 126.1 ac cropland
- 401.1± ac grass

**TRACT 3:** NW/4 of 30-7-41

- 79.1± ac grass
- 80.9 ac CRP

\*Total of 422.5 acres cropland. 277.4 acres are newly broke & in compliance with NRCS. 145.1 acres come out of CRP in 2015 – could be broke out & added to the cultivated acres.

\*Seller plans to plant to wheat this fall on all broke ground with Buyer to receive 100% of the crop. **IMMEDIATE POSSESSION TO BUYER!**

INTERNET BIDDING AVAILABLE!

For Virtual Tour visit

www.farmandranchrealty.com

## FARM & RANCH REALTY, INC.

1420 W. 4<sup>TH</sup> • COLBY, KS 67701

TOLL FREE: 1-800-247-7863

DONALD L. HAZLETT

Broker/Auctioneer

"When you list with Farm & Ranch, it's as good as SOLD!!"