

Public Notices

Will to be admitted to probate, record

Published in The Saint Francis Herald, St. Francis, Kansas, Thursdays, September 26, October 3 and October 10, 2013. (39, 40, 41)

NEWBERY, UNGERER & HICKERTLLP
2231 S.W. Wanamaker Road, Suite 101
Topeka, Kansas 66614 (785) 273-5250
(785) 273-5317 (Fax)
B.J. Hickert #10734
C. David Newbery #08491
Erik M. Rome #25422

IN THE DISTRICT COURT OF CHEYENNE COUNTY, KANSAS

IN THE MATTER OF THE ESTATE OF
Case No. 13 PR 15
GAYLE LOREE SMRIGA, Deceased

NOTICE OF HEARING

THE STATE OF KANSAS TO ALL PERSONS CONCERNED:

You are hereby notified that on September 20, 2013, a Petition was filed in this Court by Chad A. Smriga, an heir, devisee and legatee, and Executor named in the Last Will and Testament of Gayle Loree Smriga, deceased, dated November 8, 2001, requesting that: The foreign Will of Gayle Loree Smriga, deceased, dated November 8, 2001, be admitted to probate and record in this Court; no administration of the Estate is necessary; the Will be construed, and the Decedent's Kansas real and personal property be assigned in accordance with the terms of the Will.

You are required to file your written defenses thereto on or before October 18, 2013, at 10:00 o'clock a.m. in the District Court, St. Francis, Cheyenne County, Kansas, at which time and place the cause will be heard. Should you fail therein, judgment and decree will be entered in due course upon the Petition.

Chad A. Smriga, Petitioner

PREPARED BY:

B.J. Hickert, #10734
NEWBERY, UNGERER & HICKERTLLP
2231 SW Wanamaker Road, Suite 101
Topeka, Kansas 66614
(785) 273-5250
(785) 273-5317 (Fax)
b.j.hickert@nuhlaw.com
Attorney for Petitioner

Book Review

Bannon Brothers: Trust
By Janet Dailey

Cold cases aren't RJ Bannon's usual line of work. But Ann Montgomery's abduction is too intriguing to pass up. Ann was just three when she was taken from her family's Virginia mansion over 25 years ago. The Montgomerys launched a heartbreaking search

with no trace of the missing girl.

Bannon knows the chances of finding her now are slim, but he can't stop searching for answers. Especially once he meets Erin Randall. A beautiful, talented local artist, she seems to share tantalizing connections with the vanished Ann. But his quest for the truth will put her in mortal danger.

960+/- ACRES CROPLAND, GRASS & CRP
"MULTI-PARCEL" ABSOLUTE LAND AUCTION
SHERMAN COUNTY, KS
SELLER: ESTATE OF MERLE STASSER
Tues, Oct. 15, 2013 @ 10:30 AM, MDT

AUCTION LOCATION:
Community Hall at the Firehouse, Goodland, KS

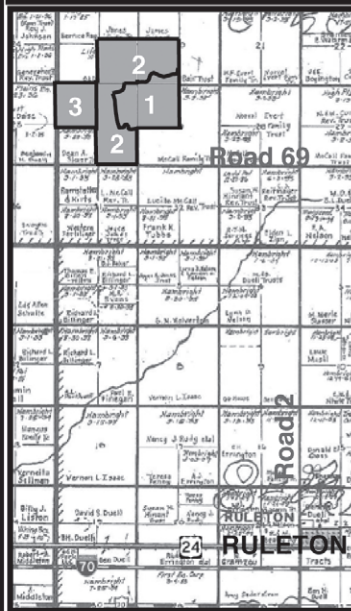

Land will be sold in 3 tracts and combinations of tracts:

LEGAL DESCRIPTIONS:

- TRACT 1:** NW/4 of 29-7-41; Tract of 23.9± ac cropland in SW/4 of 20-7-41; and all cropland ac in E/2 of 30-7-41
 - 151.3 ac cropland
 - 52.8± ac grass
 - 64.2 ac CRP
- TRACT 2:** SE/4 of 19-7-41; grass acres in E/2 of 30-7-41 and SW/4 of 20-7-41; and Tract of 48.4± ac cropland in SW/4 of 20-7-41
 - 126.1 ac cropland
 - 401.1± ac grass
- TRACT 3:** NW/4 of 30-7-41
 - 79.1± ac grass
 - 80.9 ac CRP

- Total of 422.5 acres cropland. 277.4 acres are newly broke & in compliance with NRCS. 145.1 acres come out of CRP in 2015 – could be broke out & added to the cultivated acres.
- Seller plans to plant to wheat this fall on all broke ground with Buyer to receive 100% of the crop. **IMMEDIATE POSSESSION TO BUYER!**

INTERNET BIDDING AVAILABLE!

For Virtual Tour visit
www.farmandranchrealty.com

FARM & RANCH REALTY, INC.

1420 W. 4TH • COLBY, KS 67701
TOLL FREE: 1-800-247-7863
DONALD L. HAZLETT
Broker/Auctioneer

"When you list with Farm & Ranch, it's as good as SOLD!!"

Library News

We have added to our PlayStation 2 games; now they total seven. Two Lord of the Rings titled: Two Towers and the Third Age. Two, Star Wars titled: Episode III and Battlefront. The others are IHRA's Drag Racing, Superman Returns, and Raymond 3: Hoodlum Havoc.

In support of Kansas Reads, the Northwest Kansas Library System gifted us with *Then We Came to the End*, authored by Joshua Ferris. This is a true and funny story about how we survive in life's strangest environments, be it department or staff meeting, when we crowd the office refrigerator with our labeled yogurts, or perhaps in waiting rooms at the hospital or doctor's office. We seem to survive through gossip,

pranks, and more frequent coffee breaks. We pretend this is normal five days a week when perhaps it really is not.

Last month Bertha Sanders showcased her miniature tea sets. They were beautiful! Come in and view our next collection in the glass showcase featuring Jane Brubaker's pottery collection.

Honor Roll

New and renewed Times subscriptions: Eldon Walden, Bird City David Hensarling, Plattsburgh, N.Y.; Rosemary Powell, Bird City; Owen Wingfield, McDonald; Roland Query, Firestone, Colo.;

westernauctionandrealstate.com
Land Auctions & Land Listings Available in Colorado & Kansas
Looking to market your Land? Contact us today -
Licensed in Kansas, Colorado & Nebraska for all your needs!

Cheyenne Co., Kansas & Yuma Co., Colorado Dryland
FOR SALE AT AUCTION

Approx 560 acres in 4 Tracts
Thursday, Nov. 7, 2013 @ 1:30 pm CT
Auction Site: Western Auction & Real Estate Pavilion, St. Francis, KS
Elmer E. Brunswig & Esther R. Brunswig, Sellers

Sherman County, Kansas Dryland
FOR SALE & LEASE

For Sale: NE/4 35-6-42, For Lease: 2 quarters near this property!

Sherman County, Kansas Irrigated Cropland
FOR SALE

SE/4 32-8-42: Minerals included, Sprinkler

Cheyenne County, Kansas CRP
FOR SALE

160.9 ac. w/ \$29.92/acre Contract expires 9/30/22
W/2 NE/4 & W/2 SE/4 5-5-37

Bird City Commercial Properties
FOR SALE AT AUCTION

Prairie Land Electric, Sellers
Thursday, Oct. 17, 2013 @10:30 CT
Beautiful Bird City, Kansas

Recent Price Reductions on these Properties:

220 Birch, St. Francis - Brick Ranch Home w/ 4 BRs, Garage & Workshop!
516 S. Rich Ave., Bird City - 4 BR home on Corner Lot
104 S. Cave, Bird City - Bungalow w/ Garage!

Check our website for a complete listing of what's available!

Licensed in Kansas, Colorado, and Nebraska for your Real Estate needs!

Auction & Real Estate LLC

westernauctionandrealstate.com
Betty L. Petersen, Broker
Skipp Petersen, Sales Agent & Auctioneer - 785.332.8221
Robin A. Petersen, Assoc. Broker,
Auctioneer - 785.332.5586
Brett Petersen, KS Sales Agent & Auctioneer
Gary L. Wickwar, KS Sales Agent
W. Hwy. 36 ~ P.O. Box 928
St. Francis, Kansas 67756 ~ 785.332.8990

UNITED STATES POSTAL SERVICE® (All Periodicals Publications Except Requester Publications)

Statement of Ownership, Management, and Circulation

1. Publication Title: The Bird City Times
2. Publication Number: 056-720
3. Filing Date: 10/01/2013
4. Issue Frequency: 52
5. Number of Issues Published Annually: 52
6. Annual Subscription Price: 33
7. Complete Mailing Address of Known Office of Publication (Not printer) (Street, city, county, state, and ZIP+4®):
The Bird City Times
PO BOX 228
BIRD CITY KS 67731 / CHEYENNE
8. Complete Mailing Address of Headquarters or General Business Office of Publisher (Not printer):
BIRD CITY TIMES
PO BOX 228
BIRD CITY KS 67731
9. Full Names and Complete Mailing Addresses of Publisher, Editor, and Managing Editor (Do not leave blank):
Publisher (Name and complete mailing address):
KAREN KRIEN
PO BOX 228
BIRD CITY KS 67731
Editor (Name and complete mailing address):
KAREN KRIEN
PO BOX 1859
SAINT FRANCIS KS 67756
Managing Editor (Name and complete mailing address):
NORMA MARTINEZ
PO BOX 228
BIRD CITY KS 67731
10. Owner (Do not leave blank. If the publication is owned by a corporation, give the name and address of the corporation immediately followed by the names and addresses of all stockholders owning or holding 1 percent or more of the total amount of stock. If not owned by a corporation, give the names and addresses of the individual owners. If owned by a partnership or other unincorporated firm, give its name and address as well as those of each individual owner. If the publication is published by a nonprofit organization, give its name and address.):
Full Name: HAYNES PUBLISHING, STEPHEN AND CYNTHIA HAYNES
Complete Mailing Address: 170 S PENN OBERLIN KS 67749
11. Known Bondholders, Mortgagees, and Other Security Holders Owning or Holding 1 Percent or More of Total Amount of Bonds, Mortgages, or Other Securities. If none, check box: None
Full Name: THE BANK OF NORTHWEST KANSAS
Complete Mailing Address: PO BOX 485 COLBY KS 67701
12. Tax Status (For completion by nonprofit organizations authorized to mail at nonprofit rates) (Check one)
The purpose, function, and nonprofit status of this organization and the exempt status for federal income tax purposes:
 Has Not Changed During Preceding 12 Months
 Has Changed During Preceding 12 Months (Publisher must submit explanation of change with this statement)
PS Form 3526, August 2012 (Page 1 of 3) (Instructions Page 3) PSN: 7530-01-000-9931 PRIVACY NOTICE: See our privacy policy on www.usps.com

13. Publication Title: The Bird City Times
14. Issue Date for Circulation Data Below: 09/26/2013

15. Extent and Nature of Circulation

| GENERAL, MOSTLY IN AND NEAR CHEYENNE COUNTY | | Average No. Copies Each Issue During Preceding 12 Months | No. Copies of Single Issue Published Nearest to Filing Date |
|---|--|--|---|
| a. Total Number of Copies (Net press run) | | 500 | 500 |
| b. Paid Circulation (By Mail and Outside the Mail) | (1) Mailed Outside-County Paid Subscriptions Stated on PS Form 3541 (include paid distribution above nominal rate, advertiser's proof copies, and exchange copies) | 191 | 199 |
| | (2) Mailed In-County Paid Subscriptions Stated on PS Form 3541 (include paid distribution above nominal rate, advertiser's proof copies, and exchange copies) | 143 | 141 |
| | (3) Paid Distribution Outside the Mail Including Sales Through Dealers and Carriers, Street Vendors, Counter Sales, and Other Paid Distribution Outside USPS® | 29 | 28 |
| | (4) Paid Distribution by Other Classes of Mail Through the USPS (e.g., First-Class Mail®) | 0 | 0 |
| c. Total Paid Distribution (Sum of 15b (1), (2), (3), and (4)) | | 363 | 368 |
| d. Free or Nominal Rate Distribution (By Mail and Outside the Mail) | (1) Free or Nominal Rate Outside-County Copies included on PS Form 3541 | 11 | 11 |
| | (2) Free or Nominal Rate In-County Copies included on PS Form 3541 | 0 | 0 |
| | (3) Free or Nominal Rate Copies Mailed at Other Classes Through the USPS (e.g., First-Class Mail) | 0 | 0 |
| | (4) Free or Nominal Rate Distribution Outside the Mail (Carriers or other means) | 0 | 0 |
| e. Total Free or Nominal Rate Distribution (Sum of 15d (1), (2), (3) and (4)) | | 11 | 11 |
| f. Total Distribution (Sum of 15c and 15e) | | 374 | 379 |
| g. Copies not Distributed (See instructions to Publishers #4 (page #3)) | | 126 | 121 |
| h. Total (Sum of 15f and g) | | 500 | 500 |
| i. Percent Paid (15c divided by 15f times 100) | | 74.6 | 74.0 |

16. Total circulation includes electronic copies. Report circulation on PS Form 3526-X worksheet.

PS FORM 3526 WORKSHEET
If you are using PS Form 3526 and claiming electronic copies complete below:

| | | |
|---|---|--|
| a. Paid Electronic Copies | ▶ | |
| b. Total Paid Print Copies (Line 15c) + Paid Electronic Copies | ▶ | |
| c. Total Print Distribution (Line 15f) + Paid Electronic Copies | ▶ | |
| d. Percent Paid (Both Print & Electronic Copies) | ▶ | |

I certify that 95% of all my distributed copies (Electronic & Print) are paid above a nominal price.

17. Publication of Statement of Ownership
 If the publication is a general publication, publication of this statement is required. Will be printed in the 10/16/2013 issue of this publication. Publication not required.

18. Signature and Title of Editor, Publisher, Business Manager, or Owner
Sheila Smith, Circulation Manager 10-1-13

I certify that all information furnished on this form is true and complete. I understand that anyone who furnishes false or misleading information on this form or who omits material or information requested on the form may be subject to criminal sanctions (including fines and imprisonment) and/or civil sanctions (including civil penalties).

PS Form 3526, August 2012 (Page 2 of 3)



St. Francis Supers
now open!
The shelves are stocked and prices are lower.
Come check out the store.

New owners—Perk, Betty, Tammy and Tab