

# Classifieds

## Classifieds

Deadline for advertising:  
Monday at 5 p.m.  
Call us at 785-332-3162  
or 785-734-2621

**Classified ads** — Printed in *The St. Francis Herald & The Bird City Times*.  
**Cards of Thanks** first ten words free, 20¢ for each additional word.  
**Poetry** is charged at the rate of \$1.30 per line.  
**\$3.00 service charge** is billed monthly for open accounts.

### Notices

BINGO, 7:30 p.m. Saturday, Feb. 1, at Bird City Legion Hall, by Legion Auxiliary. 5c

ST. FRANCIS VS. CHEYLIN basketball games. Spaghetti dinner, Sat., Feb. 8, 4-6 p.m. SFCHS cafeteria. Sponsored by the St. Francis Catholic Church. 5-6c

NEED LAWN MOWERS, riding mowers or auger motors worked on before spring? Call Bob Klie at 785-332-2417. 5-8\*

WOULD THE PERSON who found my lost billfold last Thursday please return the personal items to me, thank you. Mildred Barnhart 5\*

HAVE A PROBLEM with your computer or need a computer built? Contact Nick Raile, 785-332-2756. 5-8c

LOOKING FOR WEIGHT LOSS performance, increased energy or health enhancement. Ask me about AdvoCare, your independent distributor, Jo Rogers, 785-332-3064. 2-5\*

P-4 MONITOR, loaded- free on site, \$999.99. For Christmas, order now!! Business leases, TNT Graphics Plus, 1-866-386-4210, since 1989. 49tfn\*

CAKES, PIES, COOKIES, BREADS, for all your baking needs call Dee at The DONUT HOLE

785-332-2838 or 888-310-2838, 109 N. Quincy, St. Francis. 36tfn

HELP FOR ABUSED women and children. Open 24 hours a day, seven days a week. Call Northwest Kansas Shelter, 800-794-4624. 3tfn\*

SHARE YOUR NEWS of house guests or vacations with *The St. Francis Herald* and *Bird City Times* readers. Call 785-332-3162 or 785-734-2619 with news items.

EARN INCOME PT/FT around your schedule. Home-based business. Free booklet. Full training. www.QualityLife4You.com. 800-532-6304. 4-6\*

### Services

ARE YOU FACING a crisis pregnancy? Free pregnancy testing, counseling and financial aid are available at Emergency Pregnancy Services in Colby. Call toll-free 888-462-3022. 17tfn

TRUCK LETTERING, Call 1-800-886-2423. pin stripping, signs of all kinds including magnetic, vinyl, over 25 years of experience. Hot Brush, 800-886-2423, fax 785-734-2459 204 W. 4th, Bird City, KS 67731. 31tfn

### Wanted

PHOTOGRAPHY and memorabilia items from the Joy Photo Shop. Call 785-332-3531. 5\*

TO BUY used bread machine in good condition. Call 785-332-3531. 5\*



**MISTAKES • We Know We Make Mistakes**  
Please remember that we attempt to include something for everyone within the pages of our newspaper. We realize that some folks enjoy finding fault and for those readers we thoughtfully include a socially acceptable number of errors within our publication!



catch you on the **FLIP FLOP**  
**NOW HIRING**  
Company ★ O/O  
Singles ★ Teams  
1-800-CFI-DRIVE www.cfidrive.com

**Scrapbook Garden**  
•Albums •Stickers •Rubber Stamps  
Memories Fade...  
Scrapbooks are forever.  
West Wichita - Maple & Ridge (North of Lowell)  
Toll Free: (866) 945-6366  
www.scrapbookgarden.com • Hours: Mon-Sat 10-6, Sun 1-5. Call for evening hours  
East Wichita - Kelllogg & Rock (North of Spangler)  
Toll Free: (866) 618-6366

**"HEY GUYS"**  
"Don't forget the Valentine Bargains & Savings at Grandma's!!"  
• Balloon Special •  
Deluxe or Super Deluxe — also —  
Get a FREE GIFT with the purchase of \$25 or more for your Valentine!  
**STEVENS' KANSAS TERRITORIAL STORE**  
212 W. Washington • St. Francis • (785) 332-3300

**REAL ESTATE**  
• Cute country home on one acre just south of Hwy. 36 near the state line. The home has 3 bedrooms, 2 baths and is fit to move in today!  
• 1 section with 529.5 ac. irrigated located 8 miles north of Cope. Includes excellent water with all sprinkler equipment.  
• 800 acres m/l of dryland located 10 miles north and 1/2 west of Last Chance, CO.  
• 126 acres irrigated and 31 acres dry land located 1 mile north and 1 1/2 east of Kanorado, CO.  
Call for more information on these and other great listings!  
**Colorado Land Investment I, LLC**  
230 14th Str. • Burlington, CO 80807 • 719-346-8661  
Larry Hostetler, Broker Virgil George - Assoc. Broker  
Jessi Schreivogel - Assoc. Broker

### Lost

IF YOU MIGHT have picked up the wrong pictures at Saintry Super Foods would you please return them to us. 5c

### Help Wanted

TNT GRAPHICS needs good sales people. Commission 37.5% of profits. No relocation. 866-386-4210. 5-8\*

NEW YEAR, NEW CAREER! \$800-\$1,100 part-time. \$2,100-\$3,000 full-time. Work from home. www.cashfromyourcastle.com 5-6\*

CARETAKER WANTED: The Bird City Cemetery Board will be accepting applications for caretaker until Feb.1 Mail to P.O. Box 53, Bird City. For information call 785-734-2703. 2-5c

LINK, INC. is seeking a transitional living specialist in Colby. Duties include teaching individuals with traumatically acquired brain injuries to assist them in learning to live independently. Full-time position with benefits. High school degree required; BA/BS preferred. Experience working with individuals with disabilities and/or life experience with a disability recommended. Send resume to Human Resources, 2401 E. 1st St., Hays, KS. 67601 EOE. 4-5c

### For Rent

THREE BEDROOM farmhouse for rent north of Bird City. \$300. 719-495-8071. 2-5c

TWO BEDROOM apartment with utilities included. 785-332-2838 2tfn

ONE BEDROOM Apartment, utilities and laundry facilities, no pets, non-smoking. 785-332-2186. 7tfn

3 BEDROOM, unfurnished trailer house, utilities included except gas, \$275 mo., Angle Road RV Park, St. Francis, 785-332-2313 plus deposit. 49tfn

### For Sale

NATURAL FED BEEF, no implants and no commercial protein. 785-332-2028 5-8\*

MILLET HAY, very low nitrates, 700 ppm analysis report, \$50 per ton, Tim Raile 785-332-2441. 2-5c

JERRY OATS SEED, bulk or bag. Olsen Livestock and Seed Inc. Call 308-297-3283 or 308-297-3689. 4-13c

FIREWOOD FOR SALE, Angle Road RV Park. 785-332-2313. 4tfn

### Vehicles for Sale

'96 CHEVY CORSICA, 103K miles, new transmission, new tires, \$3,500 OBO. 303-859-4499, Jessica Trevino 5-7c

1996 FORD ESCORT LX SunSport, 2 door, A/C, 68,000 miles. Great school car. Looks good, runs good. \$3,800. Call 785-332-3563. 2tfn

2 SURPLUS FORD CROWN VICTORIA patrol cars; a 1995 with 93,000+ miles and a 1996 with 66,000 miles. Arrangements can be made to view the sealed vehicles by contacting the City Office at 785-475-2217. Bids should be in a sealed envelope marked "Patrol Car Bid" and sent or brought to: City Administrator; 1 Morgan Drive, Oberlin, Ks. 67749. Bids should be received not later than 3 p.m. on

Thursday, Feb. 6. The City of Oberlin reserves the right to reject any and all bids. 3-6\*

### Thank You

A big thank you to the Peace Lutheran Mens group for painting the new Food Pantry room at the courthouse. What a crew- Keith, Perry, Milton, Tobe, Bill, Tom, Art, Ervin, Martin, Cliff, Shannon and Paul. Extra thanks to Milton for the carpentry work. Thanks to Ray Lee for helping clean out what was the old evidence room and to Eddie and Cliff for hauling off the garbage. Thanks also to Carol for the coffee, goodies and her support; Rog for moving shelves and groceries, Carl for cleaning the floor and AAL for purchasing the paint. Reva Pownell

Thank you for your help, donated food and financial support at the spaghetti dinner at St. Joseph Catholic Church (Bird City). \$1500.00 was raised! Cheyenne County Kansans for Life

We would like to thank the EMTs and hospital staff for their efforts to save Debra. We also want to thank everyone for their prayers, phone calls, visits, cards, flowers and food. The family of Debra Duvall

The family of Sena (Harper) Chazel would like to thank everyone who called, sent cards and for your prayers during our time of loss. Dennis and Iva Krien family

### nwkansas.com

**INTERNET Access as low as \$14.92/month**  
Tech help Available  
Hookup Same Day as Signup  
**The Saint Francis Herald**  
P.O. Box 1059; St. Francis 785-332-3162

**Diabetics**  
Have your diabetic supplies delivered to your door for little or no cost!  
Medicare & private insurance welcome (Sorry, HMOs not accepted)  
**NationMED™**  
Call Now! Toll Free 1-888-666-0555

The City of St. Francis is taking applications for a **POLICE OFFICER**  
Must be 18 years old. Please contact the Police Department for more information at 209 E. Washington; St. Francis, or call 785-332-3330. EOE

**It's Our Second Anniversary Sale**  
8:00-9:00 a.m. •• 40% OFF  
9:00-10:00 a.m. •• 30% OFF  
**KM Clothier** Feb. 1 - 7  
20% OFF All Week!  
116 W. Washington • St. Francis 785-332-3434

**NEW IDEAS for Wedding & Graduation!**  
Announcements  
Napkins  
Check it out!  
**The Saint Francis Herald**  
310 W. Washington • St. Francis, KS 785-332-3162

**NOTICE**  
**AD RATES**  
For Line Classified Ads are as follows:  
1-Wk. 10 words - \$5.50  
20¢ ea. additional word  
2-Wks. 10 words - \$10.50  
40¢ ea. additional word  
3 to 4 Wks. 10 words - \$11.95  
45¢ ea. additional word  
(10 word minimum. Line Classified must be in our office no later than 5 p.m. on Monday)  
**Country Advocate**  
\$6.00/per week - 10 words  
25¢ ea. additional word  
Ads must be in the office by 12:00 noon on Friday.  
**Display (box) Ads**  
Display (box) Ads for St. Francis and Bird City deadline is 5 p.m. on Monday.  
St. Francis Herald \$5.10 per column in.  
Bird City Times \$4.30 per column in.  
Both Papers \$8.14 per column in.  
Classified Display \$8.30 per col. in.  
**The St. Francis Herald**  
**Bird City Times**  
785-332-3162 or 785-734-2621

**Our Business Is Exhausting**  
**St. Francis Tire & Service**  
785-332-3366

**HEALTH INSURANCE\***  
For Individuals & Families  
At Affordable Rates!  
Call Bill Hollenback  
Insurance Agent HS77  
316-733-1989 or  
316-518-9158  
\*Underwritten by The MEGA Life & Health Insurance Company  
Home Office Oklahoma City OK  
M/NATL0037

**WANTED Bird City Times Editor**  
Looking for an energetic person, living in the Bird City or McDonald area, with new ideas to fill the editor position of the Bird City Times. The applicant must have some computer and writing skills, get along well with customers, be able to cover meetings, school activities and other happenings within the communities of Bird City and McDonald.  
**To apply or for more information, contact the St. Francis Herald, 785-332-3162 or stop by the office at 310 W. Washington, St. Francis.**  
**Deadline: Jan. 31, 2003**



# Senate passes appropriations omnibus package

U.S. Senator Pat Roberts announced that the Senate passed an omnibus package containing the 11 remaining appropriations bills from the 107th Congress. "The following projects are very important to western Kansas. I have been working hard with appropriators for the past year to make these projects a priority," he said.

Senator Roberts worked to fund the following projects:  
**Energy and water**  
 • The following lakes will receive funds: Kanopolis Lake \$1.5 million; Pomona Lake \$1.9 million; Wilson Lake \$1.8 million  
**Transportation**  
 • \$1 million for the U.S. 50 Reconstruction in Dodge City. The city will be undertaking an over-

lay and streetscraping project of U.S. 50 in the city limits. The project will restore road conditions to state maintenance minimums.  
 • \$3 million for a statewide bus and facilities replacement program, funded through the Kansas Department of Transportation.  
 • \$60,000 for Developmental Services of Northwest Kansas for

a paratransit vehicle.  
**Veterans and Housing and Urban Development**  
 • \$500,000 for Mennonite Housing, a non-profit housing group in Wichita.  
 • \$500,000 for Latimer water project to connect Latimer's water system with Herington's.  
 • \$750,000 for the National Institute for Aviation Research for icing research at Wichita State University. Funding will extend basic and applied research on the physics of ice formation on surfaces, the influence of ice accretion on aerodynamics, and development of effective deicing systems.  
 • \$800,000 for community development in Topeka.

million, increase of \$76,000.  
**Projects at the Agriculture Research Service, Manhattan**  
 • Karnal Bunt Research - \$300,000 includes language saying the committee expects ARS to work to establish a consortium in Manhattan, that will work with other land grant universities to address this disease.  
 • Ogallala Aquifer Research - \$900,000 for research that is headquartered in Texas but coordinated with Kansas.  
 • Agriculture Research Service Grain Sorghum Research - \$650,000 an increase of \$150,000 over Fiscal Year 2002 levels.  
 • U.S. Grain marketing and Pro-

duction Research Center - \$4.28 million. This will complete the renovations at the facility.  
 • Wind Erosion Research Unit (WERU) - maintains FY02 funding.  
 The bill also includes language, requested by Roberts, instructing APHIS and USDA to meet with the grain handling industry and develop an adequate Karnal Bunt compensation program and to report it to Congress no later than March 1.  
 The bill now goes to a conference committee to iron out differences in the House and Senate versions and then to the President for his signature.

## Changes in drought relief

Concerned that Kansas producers would be left out of a new drought assistance measure moving through Congress, U.S. Senator Pat Roberts late Tuesday finished negotiations on a new Senate Agriculture Committee drought relief package that will bring real, targeted assistance to those suffering from drought conditions.  
 "I am confident that this compromise is the best proposal for all of our producers. Directing payments only to areas and producers that have suffered crop losses is great news for Kansas livestock producers," Senator Roberts said. "By taking out eligibility for producers that did not suffer losses, approximately \$250 million in savings were provided that can now be used for assistance to livestock producers."  
 Assistance for livestock producers will be provided through the Livestock Assistance Program, Roberts said. Any funds received for the Livestock Compen-

sation Program (LCP) last fall will be subtracted out before a producer receives additional payments. However, almost all producers that received LCP assistance should qualify for additional assistance under this program.  
 "In addition," Roberts said, "my legislation to waive the 25 percent reduction in Conservation Reserve Program (CRP) rental rates for producers that used their own CRP ground for emergency haying and grazing last summer and fall is included in this new proposal."  
 The new proposal also allows producers in counties designated as a primary disaster area in 2001 or 2002 (all Kansas counties) and producers with losses of 35 percent or greater in non-primary counties, to get an additional direct payment on their crop bases. Producers will be able to use their historical base and yield for direct payments under either the 1996 Farm Bill or the 2002 Farm Bill.

Payment rates will be as follows:  
 Wheat - 22 cents bushel; Barley - 10 cents bushel; Minor Oilseeds - .34 cents per pound; Corn - 12 cents bushel; Oats - 1 cent bushel; Soybeans - 19 cents bushel; Sorghum - 15 cents bushel.  
 This assistance is on top of the approximately \$406 million in crop insurance indemnities that have been paid on 2002 crop losses in Kansas and the \$57 million already provided through the LCP.  
 "I promised Kansas producers I would work for real assistance instead of a political issue," Senator Roberts said. "This proposal is a common sense approach that delivers on that promise."

## Bird City News

Bill and Judy Elliott of Amarillo, Texas, were house guests of Maude Elliott. They helped her celebrate her birthday on Tuesday.  
 On Tuesday, Jan. 21, Frank Kinder of Pueblo, Colo., stopped for a short visit and breakfast with Paul and Edna Roesener and Roy and Karen Shrader. Frank is Edna's brother-in-law.

Mr. and Mrs. Keith Dorsch spent the week in Louisburg, Kans. visiting their son Jim and wife Lorri. They met their granddaughter Cassie Dorsch for a brief visit in Topeka.  
 On their return trip home Sunday, they were coffee guests of Edna and August Homburg in Ellis.

## LAND AUCTION

240+ Acres Cheyenne County, Kansas Cropland & CRP  
**FRIDAY - FEBRUARY 14, 2003 - 11:00 a.m. CST**  
 Seller: Helene Ruth Landenberger  
 Auction Location: Bird City American Legion Hall - Bird City, KS

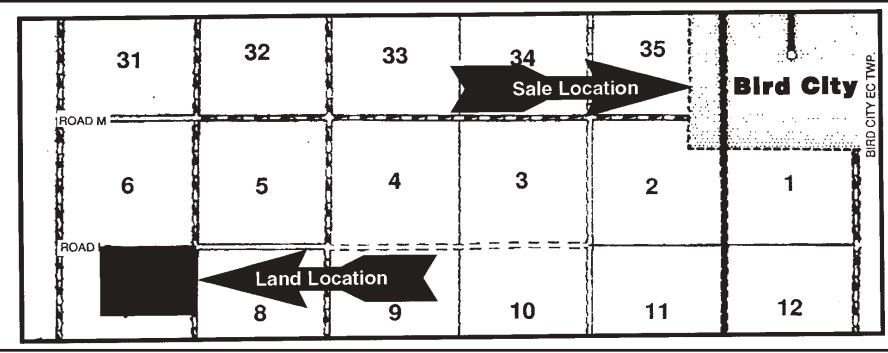

**TRACT FOR SALE: NORTHEAST 1/4 AND THE EAST 1/2 OF THE NORTHWEST 1/4 OF SECTION 7-4-38 OF CHEYENNE COUNTY, KANSAS.** Consisting of 48 acres Wheat, 94.5 acres CRP, 57.4 acres Sorghum summer fallow, 42.7 acres Wheat summer fallow.

**LOCATION OF LAND:** 4 miles West, 2 miles South of Bird City, Kansas. **MANNER OF SALE:** Real Estate will be offered in one Tract. **TERMS:** 15 % Down day of sale with the balance to be due and payable upon approval of title. Closing to be on or before March 3, 2003. **TITLE INSURANCE:** Seller to pay cost of title insurance. **MINERALS:** All minerals owned by seller go to the Buyer(s). **TAXES:** 2002 Taxes \$639.28. 2003 Taxes to be paid by Buyer(s). **CROPS & FSA PAYMENTS:** Buyer(s) to receive Sellers 1/3 share of 2003 harvested wheat crop. All of 2003 FSA payments to Buyer(s). **BASES:** Wheat Base: 133.9 acres, Yield 33 bu.; Sunflower Base: 3.6 acres, Yield: Undetermined.  
**NOTE:** Sale is not contingent upon an appraisal, survey or financing. If an appraisal or a survey is desired, it shall be done at Buyer's expense. Western Auction & Real Estate, LLC are representing the Seller and are not agents for the Buyer(s). Statements while not guaranteed, are from reliable sources. Interested parties are encouraged to satisfy themselves as to the details they consider important. Announcements made day of sale shall take precedence over printed material.  
 In case of inclement weather, auction will be held on Feb. 17, 2003. Listen to KXXX - 790 AM radio.

[www.westernauctionandrealstate.com](http://www.westernauctionandrealstate.com)  
 Betty L. Petersen, Broker & Appraiser  
 Skip Petersen, Sales Agent & Auctioneer  
 Robin Petersen, Sales Agent, Appraiser & Auctioneer  
 785.332.8990 office ~ 785.332.8993 fax  
 P.O. Box 928 ~ 301 W. Jackson St. ~ St. Francis, KS 67756  
*From Concept to Completion*

### Business Directory

To list your business, call 785-332-3162.

**This could be your space for advertisement!**

Who reads small ads? YOU DO!

**Dr. D.F. Schnee**  
 Optometrist  
 601 E. Hwy 24  
 St. Francis, KS 67756  
 785-899-5501  
 or toll free 1-800-864-4612  
 Open Mondays\*Hours by appointment

**GOFF AGENCY**  
**Gary Leach, AGENT**

**Are you covered? AUTO, HOME, LIFE, MEDICAL, CROP**

209 W. Washington,  
 St. Francis, KS 67756  
 785-332-2898  
 FAX 785-332-3155

**The Saint Francis Herald**  
**Claire Jeanfreau-Hilt**  
 Advertising Manager  
 clairejh@nwkans.com  
 sfherald@nwkans.com  
 785-332-3162  
 785-332-3001 (fax)

## Cost-Share Funds Available

The Cheyenne Co. Conservation District announces sign up for the Water Resources Cost-Share Program and the Non-Point Source Pollution Cost-Share Program. Applications will be taken at the Conservation Office, January 21 - 31.

**The following practices are eligible for cost-share assistance:** Diversions, Cross-Fencing, Field and Feedlot Windbreaks, Irrigation Water Conveyance Pipeline, Livestock Pipelines, Wells and Tanks, Spring Developments, Terraces, Range Seeding, Sprinkler Irrigation Systems Upgrades, Livestock Waste Control Facilities, Abandoned Well Plugging and Septic System Upgrades.

Cost-share assistance rate is 50-70%. All applications will be reviewed and ranked by the District Board of Supervisors and funded according to priorities recommended by the Kansas Water Plan. Work may not be started until notified by the Conservation District Board. Deadline to complete work is May 31.

If you are interested, please contact our office on West Highway 36 in St. Francis or call 785-332-2341.

## WANTED Bird City Times Editor

Looking for an energetic person, living in the Bird City or McDonald area, with new ideas to fill the editor position of the Bird City Times. The applicant must have some computer and writing skills, get along well with customers, be able to cover meetings, school activities and other happenings within the communities of Bird City and McDonald.

To apply or for more information, contact the St. Francis Herald, 785-332-3162 or stop by the office at 310 W. Washington, St. Francis.

**Deadline: Jan. 31, 2003**

## Kansas Classified Ad Network

**Adoption**  
**ADOPTION:** Loving, financially secure couple seeking to adopt. Will pay expenses. Call our adoption counselor 1-800-492-2011. Or email RandyandLisa@yahoo.com.

**PREGNANT?** If you are considering placing your baby for adoption, we can offer you choices of families who are hoping to adopt and shower your baby with love and laughter. Help with allowable expenses. 800-675-3407.

**Business Opportunity**  
 \$100/HOUR - EARN incredible income from your home! PT/FT Job opportunity, send S.A.S.E. to VST Publications, PO Box 142, Columbus, KS 66725.

**A+M&MMARS/NESTLE** Vending Route. Unique machine. Great opportunity. Prime locations! Excellent profit potential. Investment required, \$10K and under. Financing Available! Toll Free 800-637-7444.

**Home-Plus:** Establish your own mini-nursing home. Custom designed accessible five bedroom Wardcraft home. Former hospital administrator will provide design assistance. 800-383-9090.

**Educational**  
 MISSOURI WELDING INSTITUTE, INC. Nevada, Missouri.

Become a Certified Pipe and Structural Welder. Earn top pay in 18 weeks. Many companies seek our graduates. 1-800-667-5885.

**For Sale**  
 FREE 2-ROOM DIRECTV SYSTEM W/INSTALLATION! 3 months free HBO & Cinemax (\$6value) Unlimited access 222+channels! Digital-quality picture/sound. Packages from \$31.99/mo. Limited time. 800-217-4578.

Sell your products statewide for less than a penny per household. 25 words. \$250. Contact this paper or Kansas Press Association for more information. 785-271-5304 or kcan@kspress.com.

**SWIMMING POOLS!** - ONLY \$829! DISTRIBUTORY OVERSTOCKED WITH LEFTOVER, NEW 2002 POOLS! Huge 31'x19' pool w/sundeck, fence, filter only \$829! 100 Financing! (W.A.C.) installation arranged! Call now 800-852-7946 (limited area).

**Help Wanted**  
 GOVERNMENT POSTAL JOBS. UP TO \$47,578. Now hiring. Full benefits, training, and retirement. For application and info: 800-573-8555 Dept P357 8am-11pm/7days.

**NANNIES NEEDED:** Virginia family needs outgoing nanny for

newborn twins. \$250+/week+benefits, travel: Connecticut/Florida, one year commitment. www.nanniesofnebraska.com, Nannies of Nebraska, 402-379-2444/800-730-2444.

\$\$\$ WEEKLY \$\$\$ Distributing Merchandise on eBay. We supply product. No inventory. No experience req'd. Call today for more info. 1-800-568-1636, ext 4265.

**Help Wanted/Part-Time**  
 Kansas Army National Guard - P/T positions available. Get skills to put your career on track. We offer free training, college money, steady pay. 1-800-432-2447 www.ks.ngb.army.mil.

**Help Wanted/Truck Driver**  
 Driver - COVENANT TRANSPORT — Now hiring Experienced Teams, Solos and Trainers. Owner Operators - Solos/Teams 83¢. No CDL, No Problem. We school. Give us a call to find out about our Training Center. Authorized by the TN Higher Education Commission. Call 1-888-MORE-PAY (1-888-667-3729).

**Drivers/OTR** Singles start up to 37¢/mi. Teams Start 35¢-39¢. Industry leading benefits. GAINNEY TRANSPORTATION 800-287-0376.

**Drivers/OTR-NO EXP?** Low Cost

CDL Training available. Meals, lodging & transportation provided, Tuition Reimbursement. Ask about \$1000 Bonus! 1-800-284-8785.

**Drivers/Owner Operators** Drive for the Best. Great pay and benefits, \$2500 sign on bonus. 1yr. T/T exp. required. Call SMX 800-247-8040.

**Drivers/Students** Needed Immediately. CDL Training available through USTDS in Denver, CO. Financing transportation, housing and tuition reimbursement available. Call Carmen at 1-866-268-7854 for Details.

**Legal**  
 Social Security disability claims; Saunders & Saunders Attorneys at Law. No recovery, No fee! 1-800-259-8548.

**Steel Buildings For Sale**  
 ALL STEEL BUILDINGS. Straight-wall and Arch. Factory direct. \$200 to \$500 below any bid or we'll send you a check for \$200. 1-800-0-9-7-3-3-3-6-6-6. www.premiersteel.org.

**STEEL BUILDINGS** Sale: 5,000+ sizes. All-Steel for lasting value! Down-home service to meet your building needs. Call for free brochure www.sentinelbuildings.com. Sentinel Building, 800-327-0790, Extension 79.